

**NOTICE D'INSTALLATION ET D'UTILISATION  
PLAQUES A INDUCTION PROFESSIONNELLE**

**INSTRUCTION FOR USE AND INSTALLATION  
PROFESSIONNAL INDUCTION COOKTOP**

**PIC 25 / PIS 30 / PID 30 / PIW 30**



**Fabrication française  
Made in France**

Mai 2017

## **PROFESSIONAL INDUCTION COOKTOP PIC 25 / PIS 30 / PID 30 / PIW 30**

Congratulations for the acquisition of this upmarket appliance made in France. You chose an appliance which alloys the best technical qualities with a big user-friendliness. We wish you the biggest contentment.

### **1. SECURITY INSTRUCTIONS**

Please respect these instructions scrupulously to avoid any risk of fire, electric shock, scald or other wounds and damage. During the use of this appliance, fundamental circumspection of security must always be noticed, such as:

- Never leave the machine working without any watching.
- Take into account the instructions to be systematically kept with the appliance.
- Protect the appliance from direct light of the sun, frost and humidity.
- Never leave the appliance within the reach of children or disabled persons without surveillance except if they have received before the instructions use from a person in charge.
- Never move the appliance when it is working or when the surfaces of cooking are still hot.
- Check that the appliance is definitely off before connecting it up or disconnecting it.
- Do not use your induction cooktop if a crack appears in the glass surface.
- Do not stock any object on it, no matter what it is.
- Do not use a steam cleaner.

- When cooking, never use aluminium foil and never place products that are wrapped in aluminium or frozen products in aluminium trays, on the hob. The aluminium will melt and will permanently damage your appliance.
- Do not touch the hot surfaces of the appliance. The temperature of the hot surfaces can be very important when the appliance is working.
- Do not use the appliance for other functions than determined use.
- Do not leave the cord of electrical cord in the contact of hot surfaces or hanging from the work surface.
- During use, look after not to obstruct hearings of aeration of the appliance.
- To avoid any electric shock, never plunge the appliance, the cord or plug in water or quite other liquid.
- If the cord is harmed, it must be replaced by the producer, his after sale service or persons of similar skills to avoid any risk.
- Entrust compensations only to a skilled person.
- Use only spare parts of origin.
- At the end of cooking, before cleaning the appliance, do not forget to disconnect it.
- Users should exercise caution if wearing items such as rings, watches or similar objects when using the appliance since these may heat up when positioned very close to the cooking surface.
- Only use pans of the type and size recommended (see page 19, different containers).

**If you have a heart pacemaker Or other active implant fitted :**

The functioning of the hob complies with the currently applicable norms concerning electromagnetic disturbance. Your induction cooking hob therefore fully meets the legal requirements (89/336/CEE directives). It has been designed not to cause disturbance to other electric appliances insofar as they also meet the requirements of the same regulations.

Your induction hob emits magnetic fields in its immediate surroundings.

To avoid the possibility of interference between your cooking hob and a heart pacemaker, the latter must be designed to comply with the regulations that apply to it.

In this respect, we can therefore only guarantee the compliance of our own appliance. With regard to the compliance of a heart pacemaker or any eventual incompatibility, we recommend that you consult its manufacturer or your doctor. Failing that, we recommend to keep a distance of at least 60 centimetres (2 feet) from your pacemaker and your appliance.

## **2. CONTENTS OF CARDBOARD PACKAGING**

Device: A induction cooktop

Accessory - The present note

See exploded views for PIC 25/PIS 30/PID 30/PIW 30 at the end of the document.

## **3. CONFORMITY OF USE**

Use the professional induction cooktop to brown at the height of 30 till 40 mm according to the quality of the pan casserole.

## **4. WAY OF FUNCTIONING / HANDLING**

### **The induction principle**

After the appliance is switched on and a power level is selected, electronic circuits produce induced currents in the base of the pan which instantly transmits the heat produced to the foodstuffs.

Cooking takes place with practically no energy loss with a very high energy output.

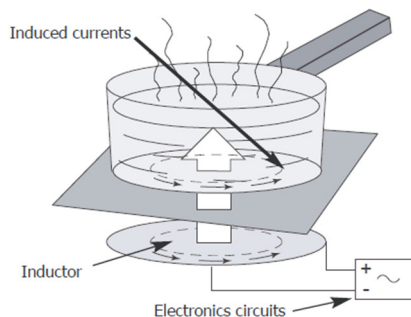

**a) Really simple use of the machine :**

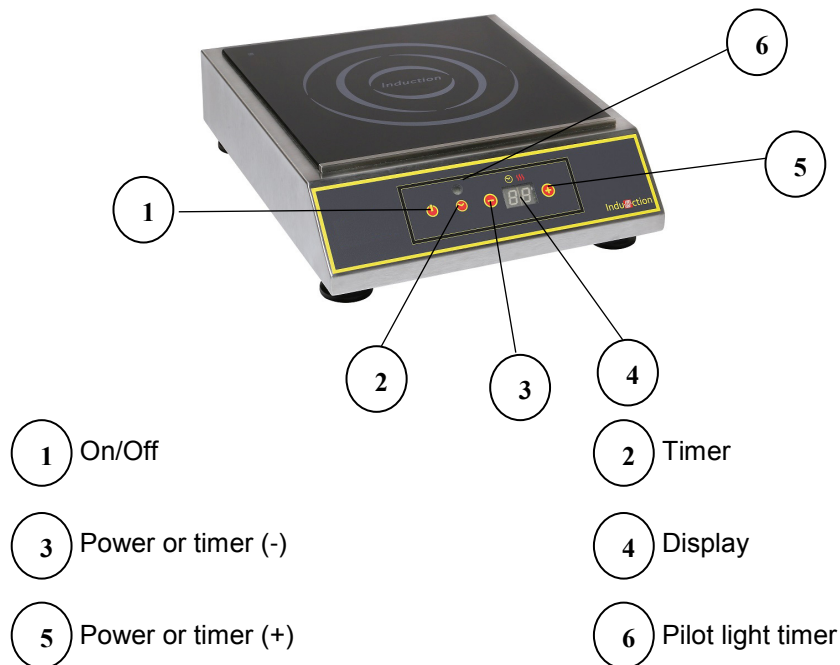

**Putting on**

- Connect your device on adapted electric socket a single phase network 230-240V -50/60 HZ.
- Press the On/Off touch (n° 1 on picture), to switch on the device. The value « 0 » displays on the screen (n°4 on picture). At that point, There is no power selected.
- Press the power touch (+) (n°5 on picture) to increase power. The display (n°4 on picture) indicates the corresponding power level.

**Timer setting**

The timer setting is only available after having selected a power level between 1 and 20.

Press on the timer knob (n°2 on picture). The timer pilot light (n°6 on picture) switches on and there is « ti » message on the display for 3 seconds.

Cooking time selection is made thanks to the touches (+) or (-). The duration of the timer is between 1 and 99 minutes.

If the cooking time is less than one minute, the counting on the display is in seconds. Above one minute, the counting is in minutes.

A sound signal informs the end user of the end of cooking time and cuts the heating.

To stop the sound signal, just press on one touch. Pressing once more on the timer touch (n°2 on picture) enables to come back to the power setting. The timer pilot light (n°6 on picture) switches off and « Po » message appears for 3 seconds. It is now possible to select power thanks to the touches (+) or (-)

## Stopping the appliance

- Press the on/off touch (n°1 on picture) to switch off the product. The power is cut and the display turns off.
- After stopping the cooking zone, an « H » (stands for « Hot ») might be flashing on the display as long as the temperature on the ceramic glass exceeds 60°C.

## Power setting

- When a compatible pan with induction technology is placed on the heating surface, the display (n°4 on picture) indicates the level of regulation. If the pan is not compatible, the display flashes. Make sure the pan is not empty. The power level is contained between 1 and 20.
- At any time, you can adjust power by pressing touches (+) (n°5 on picture) or (-) (n°3 on picture) (See below table)

	Model 3000 W PIS 30-PID 30– PIW 30	Model 2500 W PIC 25
Setting	Power	Power
1	50	25
2	100	38
3	150	50
4	200	100
5	300	150
6	400	200
7	500	250
8	600	300
9	700	400
10	800	500
11	1000	600
12	1200	700
13	1400	800
14	1600	900
15	1800	1000
16	2000	1300
17	2200	1600
18	2400	1900
19	2700	2200
20	3000	2500

As soon as the pan is removed from the cooking zone, the display indicates the absence of the pan by a blinking. There is close to no consumption of power. If the display flashes when the pan recovers the cooking zone, it means that the material of the pan is not compatible with the induction technology.

#### **b) Different containers**

Your induction hob is able to recognize the majority of pans and recipients.

Testing a pan: place the pan on the cooking zone with a power level set : **if indicator stays on**, your pan is **compatible**, if it **flashes**, your pan **has not been recognised and cannot be used**.

You can also test with the aid of a magnet: if it “sticks” to the base of the pan, then the pan is compatible with induction technology.

#### **Induction-compatible pans are:**

- Enamelled steel pans with or without a non-stick coating.
- Cast-iron pans with or without an enamelled base. An enamelled base will prevent the scratches on the top ceramic glass
- Stainless-steel pans designed for induction. Most stainless steel pans are suitable if they pass the pan test.
- Aluminium pans with special bases.

**Note: Pans made from glass, ceramic material, clay, aluminium (without special pan base), and copper, as well as certain non-magnetic stainless steels are not compatible with induction cooking. The indicator for the power level selected will flash to inform you of this.**

**Containers made of plastic must not be placed on hot surfaces.**

### **5. HOW TO MAINTAIN AND LOOK AFTER YOUR COOKER**

Avoid rubbing the pans over the surface of the appliance.

Do not leave an empty pan on the induction zone.

Do not heat an unopened tin can, as it might burst

**Do not leave metal cooking utensils, lids, knives or any other metal objects on the induction cooking zone. These objects are liable to heat up if they remain too close to the magnetic field generated by the induction cooking zone.**

- Clean approximately every week with soapy water the filter placed under your device (or put it in the dishwasher). Put it back very dry before any use. This filter protects your device from dust and fats.



Your device is cleaned easily, to help you, here is some advice:		
Type of spots	How to proceed	Use
Slight	Dilute well the zone to clean with hot water then wipe.	Sanitary sponges
Accumulation of recooked spots	Dilute well the zone to clean with hot water, use a special scraper for glass to rough-hew, finish with the scraper side of a sanitary sponge, then wipe.	Sanitary sponges special scraper for glass
Haloos and tracks of limestone	Apply some hot spirit vinegar to the spot, let act, wipe with a soft cloth. Use a domestic product.	Special ceramic glass dough
Inlays following the overflowing of sugar, aluminium or molten plastic	Apply to the surface a special product for ceramic glass, rather containing some silicone (protective effect).	Special ceramic glass product





## **6. TECHNICAL SPECIFICATIONS**

Models	PIC 25	PIS 30	PIW 30	PID 30
Outside dimensions mm	315x380x102	315x380x102	390x430x160	590x180x102
Vitro outside mm	280x280x4	280x280x4	Diam 300	555x280x4
Weight	6 Kg	6 Kg	10.5 Kg	11 Kg
Power	2500 W	3000 W	3000 W	2 x 3000 W
No plate	1	1	1	2
Current	11 A	13 A	13 A	2 x 13 A
Voltage	220-240 V ~	220-240 V ~	220-240 V ~	220-240 V ~

Wires colours correspondence

Phase  
Neutral  
Earth

Brown / Black / Grey  
Blue  
Yellow-Green

## **7. NORMS AND LEGALS DISPOSALS**

The device is conform to :

IEC/EN 60335-1  
IEC/EN 60335-2-36  
EN 55014-1 +55014-2  
EN 61000-3-2 + 61000-3-3

Humidity protection degrees IPX4, in conformity with the norm 60335-2-36.

## **8. ELIMINATION OF THE ELECTRIC AND ELECTRONIC WASTE**

The device respects the directives:

2002/96/CE (DEEE) N°34270064800021  
2002/95/CE (ROHS)  
2006/95 CE  
2004/108CE



### **Reach rule**

Never put the device among household waste.

The device must be put down in a centre of recycling for the electric equipments.

The materials of the device are indeed reusable. By eliminating correctly the electric and electronic wastes, the recycling and quite other shape of re-use of worn equipments, you participate in a significant way in the environmental protection.

For any information about the collection of electric and electronic waste, please contact your distributor.

## **9. GUARANTEE**

### **Conditions of guarantee**

The guarantee applicable to any device is the commercial guarantee of the distributor or the retailer. Please contact the store where you bought your device to know the precise conditions.

The guarantee grants no right for damages.

The dispositions which follow are not exclusive of the profit of the legal guarantee planned by articles 1641 and following ones of the Civil code relative to the defects and the latent defects.

### **Exclusion clauses of the guarantee**

**Bad installation and bad maintenance, in particular if they do not respect current regulations or instructions appearing in this user guide.**

Cannot benefit from the guarantee the repairs required as a result of false operations, of inappropriate use, of carelessness or of excess loads of the device, as well as those resulting from variations of the power supply, over tension or from defective installations.

The damage due to shocks, bad weather is not flatware by the guarantee. The material travels at the risks of the user; in case of delivery by carrier, the consignee has to have reservations towards the carrier before any delivery of the device.

The guarantee comes to an end in case of intervention, of repair, of modification by no qualified persons, or of use in inappropriate purposes.

## **10. DISPLAY OF SPECIFIC MESSAGE**

The device is extremely safe. It makes a permanent control of the values of temperature and other electric parameters to guarantee to the user the best level of performance and safety at every moment.

A flashing error code « **Fx** » can appear on the display to warn about a malfunctioning.

The error code flashing is effective as long as the user doesn't stop the device manually, unplug and replug the unit, and then relaunch the device using the « **On/Off** » touch.

If an error code becomes permanent without having the possibility of cancelling it by trying to relaunch the device, it is advised to get in touch with the after-sales service specified by the retailer of the product.

### **SMALL PROBLEMS AND THEIR REMEDIES**

**If you think that your hob is not working properly, it does not necessarily mean that a fault has occurred. Please verify the following in all cases :**

YOU NOTICE THAT ...	POSSIBLE CAUSES	WHAT YOU CAN DO
When putting into service, a bright display appears	Regular functioning	NOTHING: everything is normal
When putting into service, your installation short-circuits	The connection of your device is defective	Verify your connection or the conformity of the connection. If the problem persists, call your After Sale Service
The ventilation continues a few minutes after stopping the device	Cooling of the device	It's normal
The device doesn't work. The display on the casing stays off	The device is not supplied. The supply or the connection is defective	Inspect fuses and the circuit breaker of your electric installation. If the problem persists, call your After Sale Service
« F- » appears on the display	There is a touch activated permanently on the control keyboard	If the problem persists, call your After Sale Service
« F7 » appears on the display	Electric circuits are over heating	Inspect the ventilation of the device and check if it is operational
The device doesn't work, an "Fx" error code appears on the display and power is stopped	Electric circuits doesn't work well	Call the after-sales service
After switching on the device and starting the cooking zone, the selected indicator continues to flash	The pan you are using is not compatible with the induction technology or is of a diameter smaller than 16 cm	See « Cookware Recommended section »
Pan makes noise while cooking	It's a vibration generated by the circulation of the current in the pan	This phenomenon is normal with some type of pans. There is no danger
The device releases a smell during the first cooking	New device	Run the cooking during half an hour with a pan full of water
<b>If the ceramic hob suffers a breakage, split or crack, no matter how small, disconnect the appliance immediately and contact After-Sales Service.</b>		

CODE	QTE	PIECE	SPARE PART
37316SE	1	S/E CAISSON SIMPLE PIC 25/PIS 30	SINGLE BOX PIC 25/PIS 30
37318	1	BLOCAGE ARRIERE CLAVIER PIC 25/PIS 30/PID 30	REAR KEYBOARD LOCK
37325SE	1	S/E GRILLE VENTILATION PIC 25/PIS 30/PID 30	VENTILATION GRID INDUCTION
A10001	1	SERRE CABLE PA 107	CORD CLOSER PA 107
A13017	4	PIED	FOOT
C03P06032	1	CORDON	CORD
D06013	1	MODULE INDUCTION SIMPLE PIC 25	INDUCTION MODULE PIC 25
G16P06032	1	CADRAN	FRONT PANEL

## PIC 25 : PLAQUE INDUCTION CHOCOLAT

Nomenclature

DT183	Date : 30/03/2017	Dessiné par : R.L.	Approuvé par : J.Godéré	Date : 25/04/2017	Indice B
-------	----------------------	-----------------------	----------------------------	----------------------	-------------

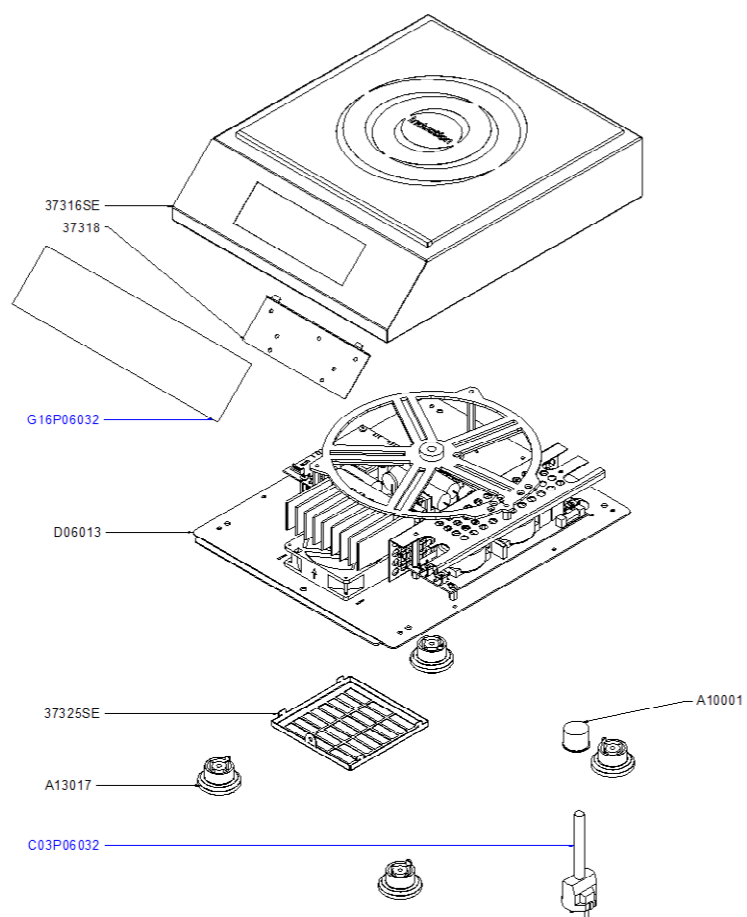

## PIC 25 : PLAQUE INDUCTION CHOCOLAT

Vue éclatée

DT183

Date :  
30/03/2017

Dessiné par :  
R.L.

Approuvé par :  
Grenon S.

Date :  
25/04/2017

Indice  
B

CODE	QTE	PIECE	SPARE PART
37316SE	1	S/E CAISSON SIMPLE PIC 25/PIS 30	SINGLE BOX PIC 25/PIS 30
37318	1	BLOCAGE ARRIERE CLAVIER PIC 25/PIS 30/PID 30	REAR KEYBOARD LOCK
37325SE	1	S/E GRILLE VENTILATION PIC 25/PIS 30/PID 30	VENTILATION GRID INDUCTION
A10001	1	SERRE CABLE PA 107	CORD CLOSER PA 107
A13017	4	PIED	FOOT
C03P06030	1	CORDON	CORD
D06012	1	MODULE INDUCTION SIMPLE PIS 30	INDUCTION MODULE PIS 30
G16P06030	1	CADRAN	FRONT PANEL

PIS 30: PLAQUE INDUCTION				Nomenclature	
DT184	Date : 30/03/2017	Dessiné par : R.L.	Approuvé par : J.Godéré	Date : 25/04/2017	Indice B

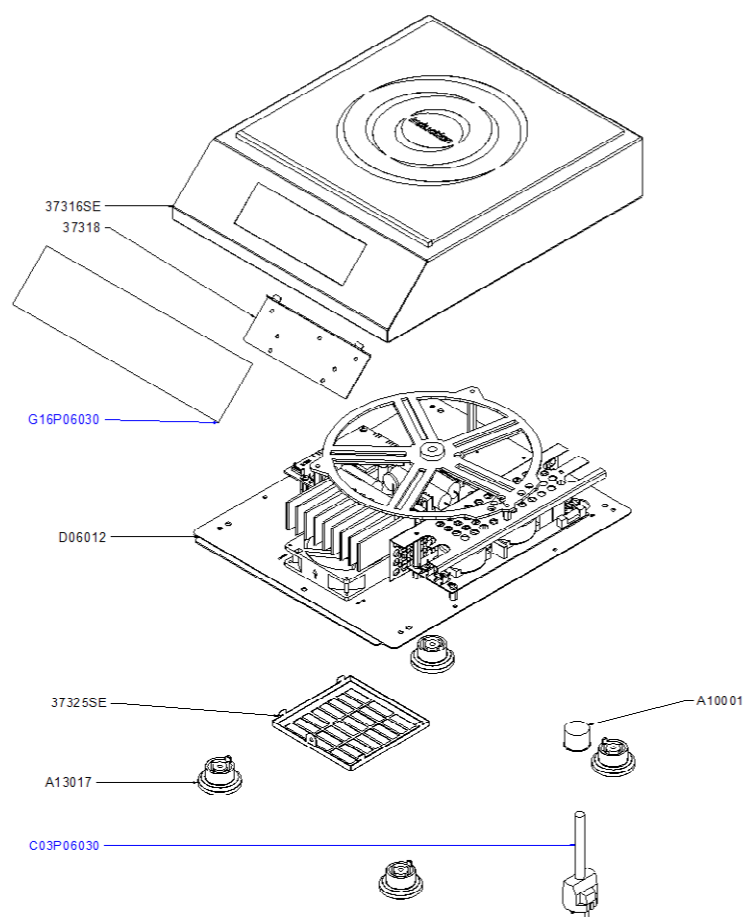

## PIS 30: PLAQUE INDUCTION

Vue éclatée

DT184

Date :  
30/03/2017

Dessiné par :  
R.L.

Approuvé par :  
Grenon S.

Date :  
25/04/2017

Indice  
B

CODE	QTE	PIECE	SPARE PART
37317SE	1	S/E CAISSON DOUBLE PID 30	DOUBLE BOX PID 30
37318	2	BLOCAGE ARRIERE CLAVIER PIC 25/PIS 30/PID 30	REAR KEYBOARD LOCK
37325SE	2	S/E GRILLE VENTILATION PIC 25/PIS 30/PID 30	VENTILATION GRID INDUCTION
A10001	2	SERRE CABLE PA 107	CORD CLOSER PA 107
A13017	4	PIED	FOOT
C03P06031	2	CORDON	CORD
D06014	1	MODULE INDUCTION DOUBLE PID 30	INDUCTION MODULE PID 30
G16P06031	1	CADRAN	FRONT PANEL

PID 30 : PLAQUE INDUCTION DOUBLE				Nomenclature	
DT185	Date : 30/03/2017	Dessiné par : R.L.	Approuvé par : J.Godéré	Date : 25/04/2017	Indice B



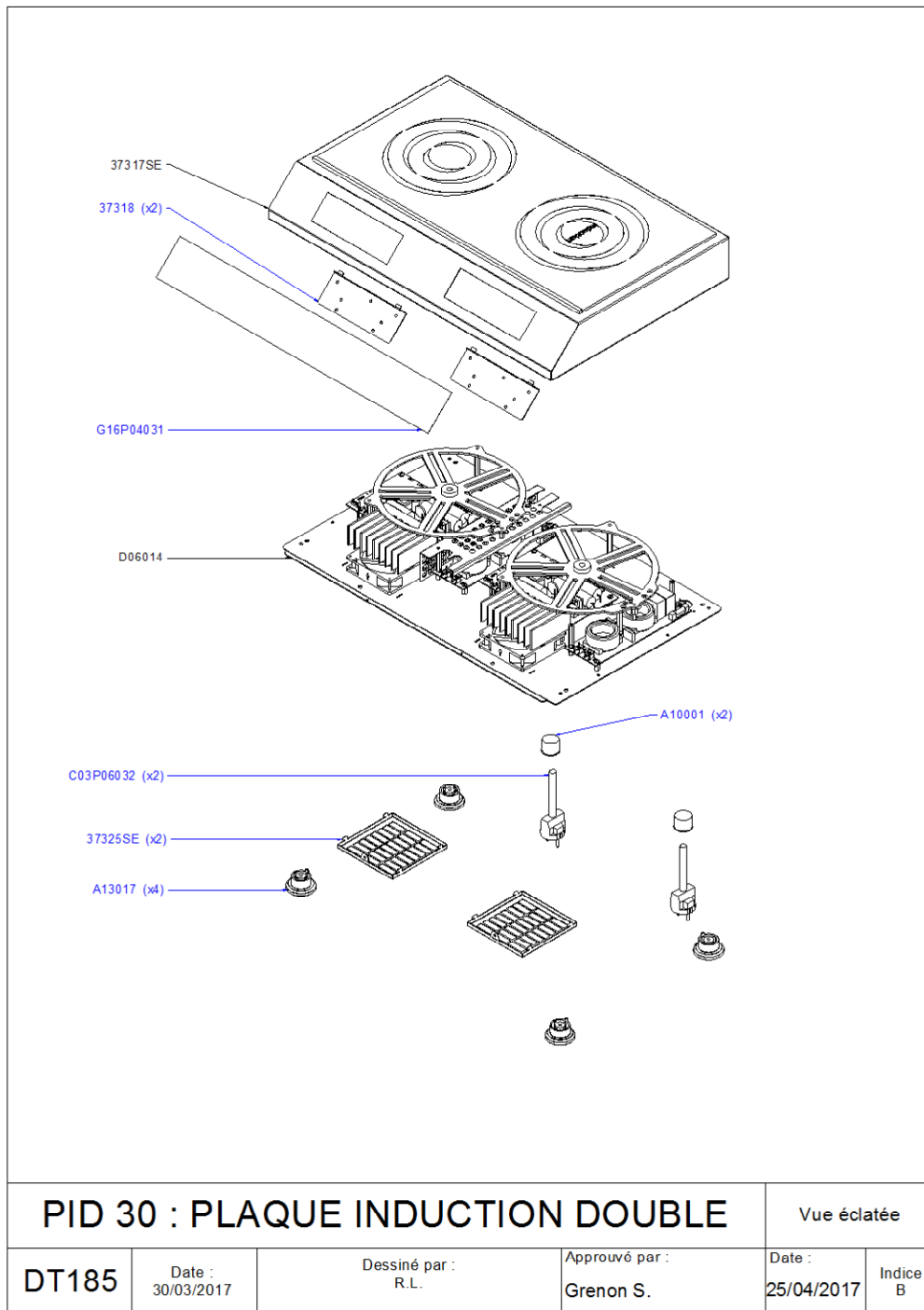

CODE	QTE	PIECE	SPARE PART
37315	4	ENTRETOISE PIED INDUCTION	FOOT SPACER INDUCTION
A13017	4	PIED	FOOT
C03P06033	1	CORDON	CORD
F07046	1	WOK POUR INDUCTION	WOK FOR INDUCTION
G16P06033	1	CADRAN	FRONT PANEL
H04315	1	ENSEMBLE INDUCTION WOK 3000 W	WOK INDUCTION ASSEMBLY 3000 W

PIW 30 : WOK				Nomenclature	
DT186	Date : 19/05/2017	Dessiné par : R.L.	Approuvé par : J.Godéré	Date : 19/05/2017	Indice A

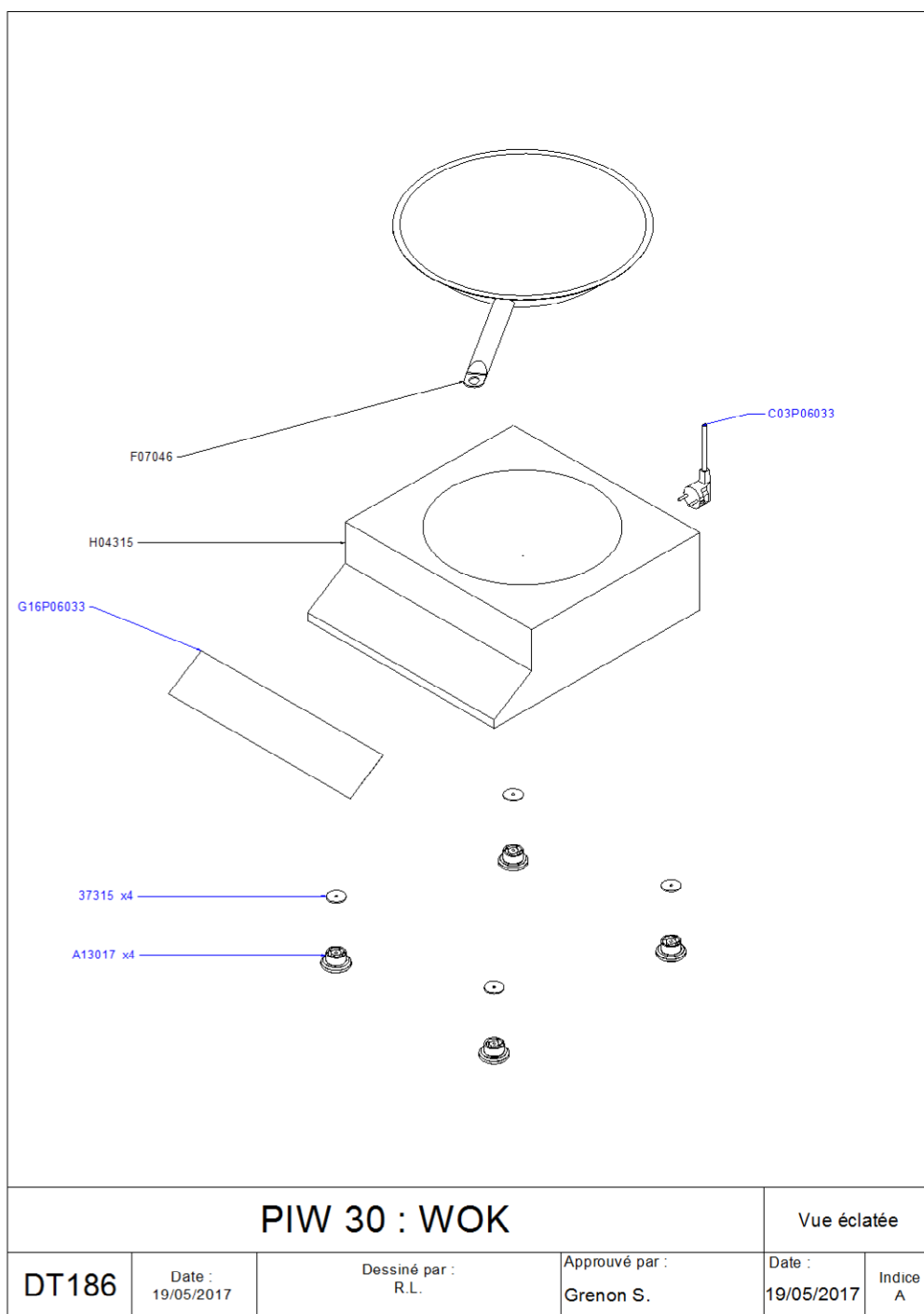

G03365