

**NOTICE D'INSTALLATION ET D'UTILISATION
CREPIERES ELECTRIQUES**

**INSTRUCTIONS FOR USE AND INSTALLATION
ELECTRIC CREPE MACHINES**

CSE 350 / CSE 400 / CDE 350 / CDE 400



Fabrication Française

Made in France

Octobre 2016

ELECTRIC CREPE MACHINES

CSE 350 / CSE 400 / CDE 350 / CDE 400

Congratulations for the acquisition of this upmarket appliance made in France. You chose an appliance which alloys the best technical qualities with a big user-friendliness. We wish you the biggest contentment.

1. SECURITY INSTRUCTIONS

Please respect these instructions scrupulously to avoid any risk of fire, electric shock, scald or other wounds and damage. During the use of this appliance, fundamental circum-spection of security must always be noticed, such as:

- Never leave the machine working without any watch ing.
- Take into account the instructions to be systematically kept with the appliance.
- Install the appliance always in instructions respect. A 10 cm distance minimum with the partition or the wall is necessary.
- This appliance is marked out for outside use or inside use in a well ventilated room or under a cooker hood.
- Protect the appliance from direct light of the sun, frost and humidity.
- Never leave the appliance within the reach of children or disabled persons without surveillance.
- Ensure that only trained personnel operate the appli-
ance.
- Never move the appliance when it is working or when the cooking surface is still hot.
- Check that the appliance is definitely off before con-
necting it up or disconnecting it.

- Do not touch the hot surfaces of the appliance. The temperature of the hot surfaces can be very important when the appliance is working. Always use control knobs.
- Do not use the appliance for other functions than determined use.
- Do not leave the cord of electrical feeding in the contact of hot surfaces.
- The appliance should not be used close to combustible materials.
- During use, look after not to obstruct hearings of aeration of the appliance.
- To avoid any electric shock, never plunge the appliance, the cord or plug in water or quite other liquid.
- If the cord is harmed, it must be replaced by the producer, his after sale service or persons of similar skills to avoid any risk.
- Entrust compensations only to a skilled person.
- Use only spare parts of origin.
- At the end of cooking, before cleaning the appliance, do not forget to disconnect it.

2. CONTENTS OF CARDBOARD PACKAGING

Device: A crepe machine

Accessories: - A wooden crepe rake
- The present note

See exploded views for CSE 350/CSE 400/CDE 350/CDE 400 at the end of the document.

3. CONFORMITY OF USE

Use the device only to cook crepes, pancakes, buckwheat cakes...

4. WAY OF FUNCTIONING

This crepe machine is fitted with strong cooktop in enamelled cast iron. The thickness of the plate ensures an excellent homogeneity and a stability of the temperature.

The plate's smooth surface provides direct heat transfer to the food being cooked, without heat loss at the centre as in the periphery thanks to spiral heating element integrated under the cast iron plate that covers the entire cooking surface.

To turn on and preheat the plate, just turn the thermostat control knob (n°2 on picture) on the wished position. The orange pilot light ignites (n°3 on picture), the crepe machine is heating. When orange pilot light switches off, the device is ready for the cooking.

During cooking, the temperature can be regulated thanks to thermostat control knob (n°2 on picture) to avoid phenomenon of overheating. Orange pilot light (n°3 on picture) indicates heating periods.

A crepe is cooked at a temperature around 200-220°C. If the crepe sticks, it is because the crepe machine is too warm, it is then necessary to adjust the thermostat to a slightly lower temperature.

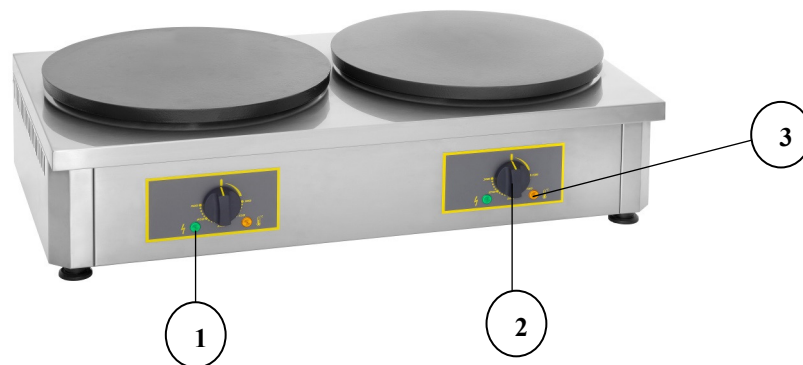

1 On/off pilot light

2 Thermostat

3 Thermostatic pilot light

5. FUNCTIONING / MANIPULATION

a) Installation / assembly:

- Unpack carefully the device of its packaging.
- Place the crepe machine on a plane and heatproof surface.

- Never place the device near a wall or near a partition makes of combustible materials even if it is very well isolated.
- A distance of minimum 10 cm with the partition or the wall is necessary.

b) First starting:

Before the first use, remove the anti-corrosion protection fat with a cleaner and a wet sponge.

During the first use, grease your plate with oil and preheat the crepe machine during about 15 min. Once preheating is finished, set the thermostat on the wished temperature.

First cleaning

Clean the device before the first use. (See 6. Cleaning)

Connection of the device

- Check that the tension and the frequency of the electricity network suit to the values indicated on the descriptive plate.
- Make sure that every control knob is positioned on 0.
- Check that neither the cord nor the plug are damaged
- Unwind completely the electric power cable and connect it in a plug connected with the earth.
- The device is connected.

NB: in case of connection of the device in a plug without earth protection or directly on the electricity network, confide its connection to a qualified person .

c) Use of device :

Elements of command and display

Command/Display	Function
Thermostat (n°2 on picture)	On/off + Temperature setting
Green pilot light (n°1 on picture)	Machine is on (pilot on) Machine is off (pilot off)
Orange pilot light (n°3 on picture)	Machine is heating (pilot light on) Temperature reached (pilot light off)

Putting on

Turn on the thermostat control knob (n°2 on picture) on the wished position: the green pilot light (n°1 on picture) ignites: the machine is on. And the orange pilot light (n°3 on picture) ignites. The machine is warming up. Once orange pilot light (n°3 on picture) is off, the machine reached the wished temperature. Grease the plate before each cooking.

Temperature setting

Set the temperature by positioning the thermostat (n°2 on picture) to the desired temperature. The orange pilot light (n°3 on picture) switches on if a higher level of temperature is required and switches off when the same is reached.

It is not necessary to leave the device switched on at full power. You must adapt the temperature to products to be cooked to limit the energy consumption.

Stopping the appliance

Set thermostat control knob (n°2 on picture) on 0: the appliance is no longer functioning.

Let the device cool

Disconnect the power cable.

Clean the appliance. (see 6. Cleaning)

During non-prolonged use, we recommend you to grease the plate

d) Breakdown / repair:

In case of breakdown or of damaged part, please call your after-sales service and confide any technical operation to qualified person.

When you contact the after-sales service of your distributor or your store, give him the complete reference of your device (commercial name, type and serial number). This information appears on the visible descriptive plate behind the device.

6. CLEANING AND MAINTENANCE

Disconnect the device.

- Let cool completely the device before any technical intervention or cleaning.
- Clean your crepe machine regularly after each use to avoid phenomenon of calamine. Calamine is the result of the cooking of the sugar and dough which accumulates very quickly, and creates a film on the plate which harms in the cooking quality.
- For cleaning, only use non-abrasive products, clean regularly the external walls of your device with warm water and wash liquid: avoid the abrasive towelling. Rinse your device with a wet sponge. Dry it with a soft cloth
- Never clean the device under a water jet, the infiltrations would risk to damage it in a irreparable way.
- Never immerse the device, the cord or the plug in the water or quite other liquid to avoid any electric shock.
- During a prolonged non-use, we recommend you strongly to keep the device shielded from the humidity and to grease the plate.

7. TECHNICAL SPECIFICATIONS

Models	CSE 350	CSE 400	CDE 350	CDE 400
Outside dimensions mm	450x480x240	450x480x240	860x480x240	860x480x240
Weight	20 Kg	23 Kg	37 Kg	44 Kg
Power	3000 W	3600 W	6000 W	7200 W
No element	1	1	2	2
Current	13 A	15.7 A	13 A/Phase	15.7 A/Phase
Voltage	220-240 V ~	220-240 V ~	380-415 V 3 N~	380-415 V 3 N~

Wires colours correspondence

Phase 1	Brown
Phase 2	Black
Phase 3	Grey
Neutral	Blue
Earth	Yellow-Green

The equipotential connection marked by this symbol  must be linked with the equipotential conductive connection of your installation by means of a minimum conduction of a 2.5 mm² section.

8. NORMS AND LEGALS DISPOSALS

The device is conform to :

IEC/EN 60335-1
IEC/EN 60335-2-38
EN 55014-1 + 55014-2
EN 61000-3-2 + 61000-3-3

9. ELIMINATION OF THE ELECTRIC AND ELECTRONIC WASTE

The device respects the directives:

2002/96/CE (DEEE) N°34270064800021
2002/95/CE (ROHS)
2006/95 CE
2004/108 CE



Reach rule

Never put the device among household waste.

The device must be put down in a centre of recycling for the electric equipments.

The materials of the device are indeed reusable. By eliminating correctly the electric and electronic wastes, the recycling and quite other shape of re-use of worn equipments, you participate in a significant way in the environmental protection.

For any information about the collection of electric and electronic waste, please contact your distributor.

10. GUARANTEE

Conditions of guarantee

The guarantee applicable to any device is the commercial guarantee of the distributor or the retailer. Please contact the store where you bought your device to know the precise conditions.

The guarantee grants no right for damages.

The dispositions which follow are not exclusive of the profit of the legal guarantee planned by articles 1641 and following ones of the Civil code relative to the defects and the latent defects.

Exclusion clauses of the guarantee

Bad installation and bad maintenance, in particular if they do not respect current regulations or instructions appearing in this user guide.

Cannot benefit from the guarantee the repairs required as a result of false operations, of inappropriate use, of carelessness or of excess loads of the device, as well as those resulting from variations of the power supply, over tension or from defective installations.

The damage due to shocks, bad weather is not flatware by the guarantee. The material travels at the risks of the user; in case of delivery by carrier, the consignee has to have reservations towards the carrier before any delivery of the device.

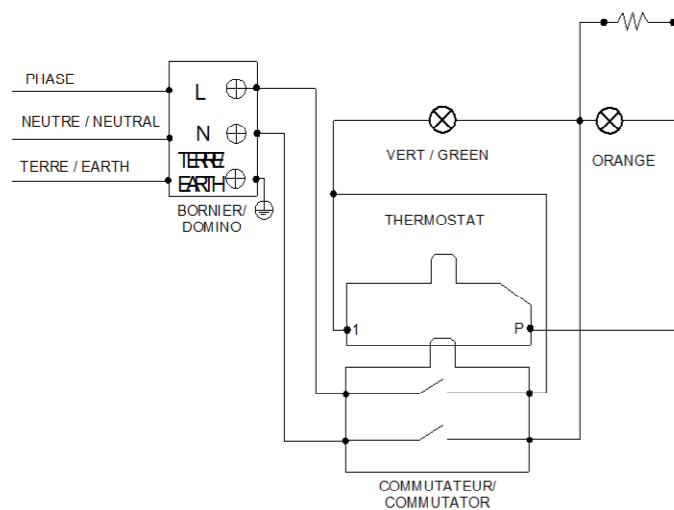

Câblage : C02362

CSE 350 - 400				Schéma électrique	
DT137-138	Date : 26/01/2016	Dessiné par : R.L.	Approuvé par : Grenon S.	Date : 12/10/2016	Indice B

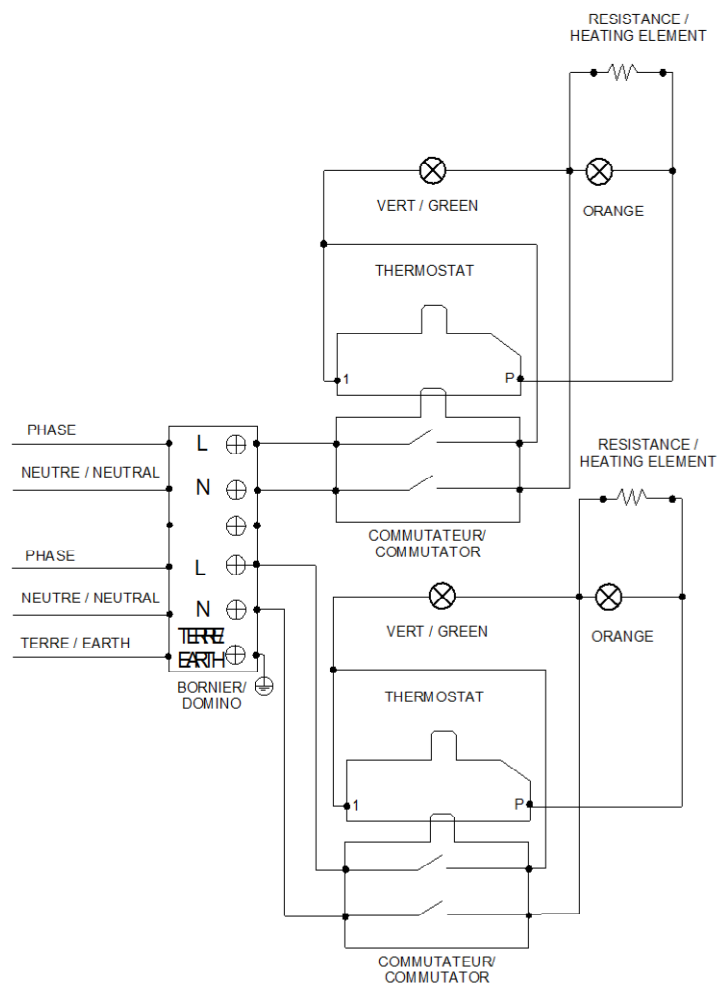

Câblage : C02363

CDE 400 - 350

Schéma électrique

DT131-
136

Date :
21/01/2016

Dessiné par :
R.L.

Approuvé par :
Grenon S.

Date :
12/10/2016

Indice
B

CODE	QTE	PIECE	SPARE PART
53102	1	BRIDE CORDON	CORD LOCK
66019	1	CONTRE DISQUE CSE/CED	GRIDDLE HOLDER CSE/CED
67034	1	SERRE BULBE CSE/CDE	BULB HOLDER CSE/CDE
67042	1	SERRE RESISTANCE DIAM 350	HEATING ELEMENT HOLDER DIAM 350
68031	1	CEINTURE CREPIERE CSE/CSG 350-400	CASING CSE/CSG 350-400
68032	1	FOND CREPIERE CSE/CSG 350-400	BOTTOM CASING CSE/CSG 350-400
68033	1	BANDEAU ELECT CSE 350-400	CONTROL PANEL CSE 350-400
68043SE	1	PLATEAU DISQUE CREPIERE CSE/CSG 350	GRIDDLE PLATE CSE/CSG 350
A01022	1	COMMUTEUR	COMMUTATOR
A01023	1	CLIP D'ASSEMBLAGE	CLIP
A06042	1	THERMOSTAT	THERMOSTAT
A08003	1	VOYANT ORANGE DIAM 12	ORANGE PILOT LIGHT DIAM 12
A08009	1	VOYANT VERT DIAM 12	GREEN PILOT LIGHT DIAM 12
A10032	1	PRESSE ETOUPE	CORD CLOSER
A13017	4	PIED	FOOT
A14113	1	BOUION ELEC PLAT 9 H	ELECTRIC KNOB 9 H
A16013	1	BORNIER 3 PLOTS	3 HOLES DOMINO
B02016+PERCAGE	1	DISQUE FONTE CREPIERE EMAILLEE DIAM 350	ENAMELLED CAST IRON PLATE 350
B09027	4	BOUT FILETE M 6 x 40	THREAD TIP M 6 x 40
D08004	1	RIVET TERRE	EARTH RIVET
G03P06010	1	CORDON	CORD
C05018	1	BORNE EQUIPOTENTIEL	EQUIPOTENTIAL TERMINAL
D02013	1	RESISTANCE CREFIFRE 3000W 220V	HEATING ELEMENT CREFIFRE MACHINE 3000W 220V
F05017	1	RATEAU A CREPES	CREPE RAKE
G06P06010	1	CADRAN	FRONT PANEL

CSE 350				Nomenclature	
DT137	Date : 26/01/2016	Dessiné par : R.L.	Approuvé par : J.Godéré	Date : 12/10/2016	Indice B

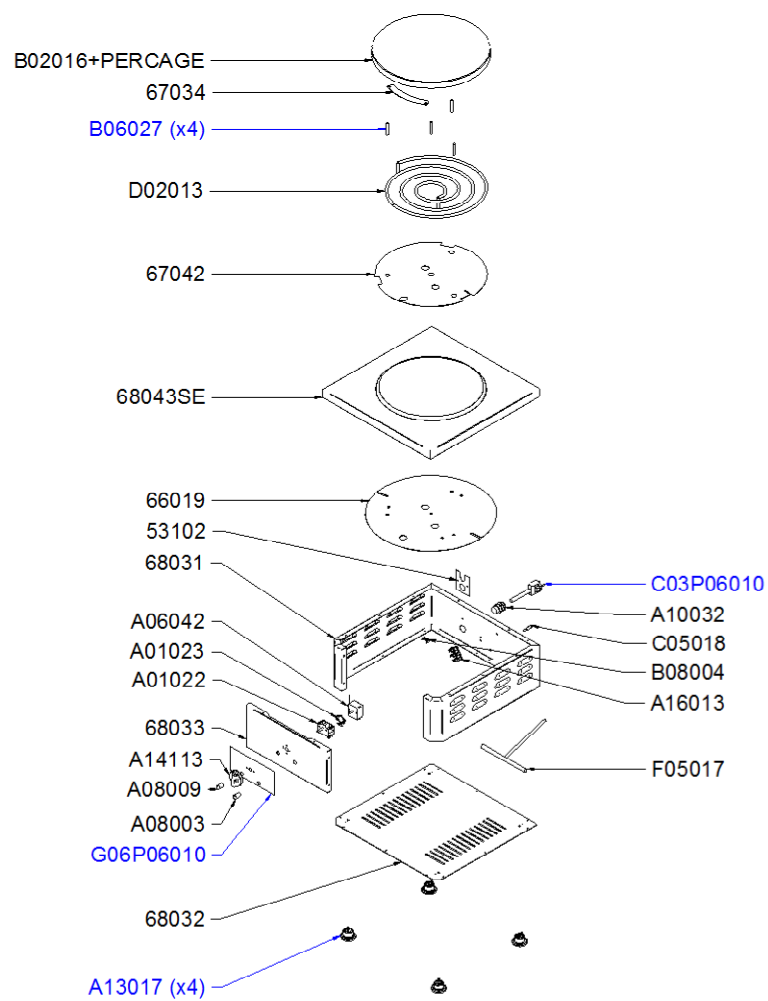

CSE 350

Vue éclatée

DT137	Date : 26/01/2016	Dessiné par : R.L.	Approuvé par : S.Grenon	Date : 12/10/2016	Indice B
-------	----------------------	-----------------------	----------------------------	----------------------	-------------

CODE	QTE	PIECE	SPARE PART
53102	1	BRIDE CORDON	CORD LOCK
67048	1	TOLE PROTECTION CREPIERE 2010	PROTECTING S/STEEL CREPE MACHINE 2010
67049	1	SERRE RESISTANCE DIAM 400	HEATING ELEMENT HOLDER DIAM 400
68030SE	1	PLATEAU DISQUE CREPIERE CSE/CSG 400	GRIDDLE PLATE CSE/CSG 400
68031	1	CEINTURE CREPIERE CSE/CSG 350-400	CASING CSE/CSG 350-400
68032	1	FOND CREPIERE CSE/CSG 350-400	BOTTOM CASING CSE/CSG 350-400
68033	1	BANDEAU ELECT CSE 350-400	CONTROL PANEL CSE 350-400
68034	2	RENFORT DISQUE CSE/CDE/CDG 400	PLATE HOLDER CSE/CDE/CDG 400
A01022	1	COMMUTEUR	COMMUTATOR
A01023	1	CUP D'ASSEMBLAGE	CUP
A06042	1	THERMOSTAT	THERMOSTAT
A08003	1	VOYANT ORANGE DIAM 12	ORANGE PILOT LIGHT DIAM 12
A08009	1	VOYANT VERT DIAM 12	GREEN PILOT LIGHT DIAM 12
A10032	1	PRESSE ETOUPE	CORD CLOSER
A13017	4	PIED	FOOT
A14113	1	BOUTON ELEC PLAT 9 H	ELECTRIC KNOB 9 H
A16013	1	BORNIER 3 PLOTS	3 HOLES DOMINO
B02P06011	1	FORTE	CAST IRON
B06027	4	BOUT FILETE M 6 x 40	THREAD TIP M 6 x 40
B08004	1	RIVET TERRE	EARTH RIVET
B08021	4	ENTRETOISE ACIER CONTACT GRILL	STEEL SPACER
C03P06011	1	CORDON	CORD
C05018	1	BORNE EQUIPOTENTIEL	EQUIPOTENTIAL TERMINAL
D02P06011	1	RESISTANCE	HEATING ELEMENT
F05017	1	RATEAU A CREPES	CREPE RAKE
G08P06011	1	CADRAN	FRONT PANEL

CSE 400				Nomenclature	
DT138	Date : 27/01/2016	Dessiné par : R.L.	Approuvé par : J.Godéré	Date : 12/10/2016	Indice B

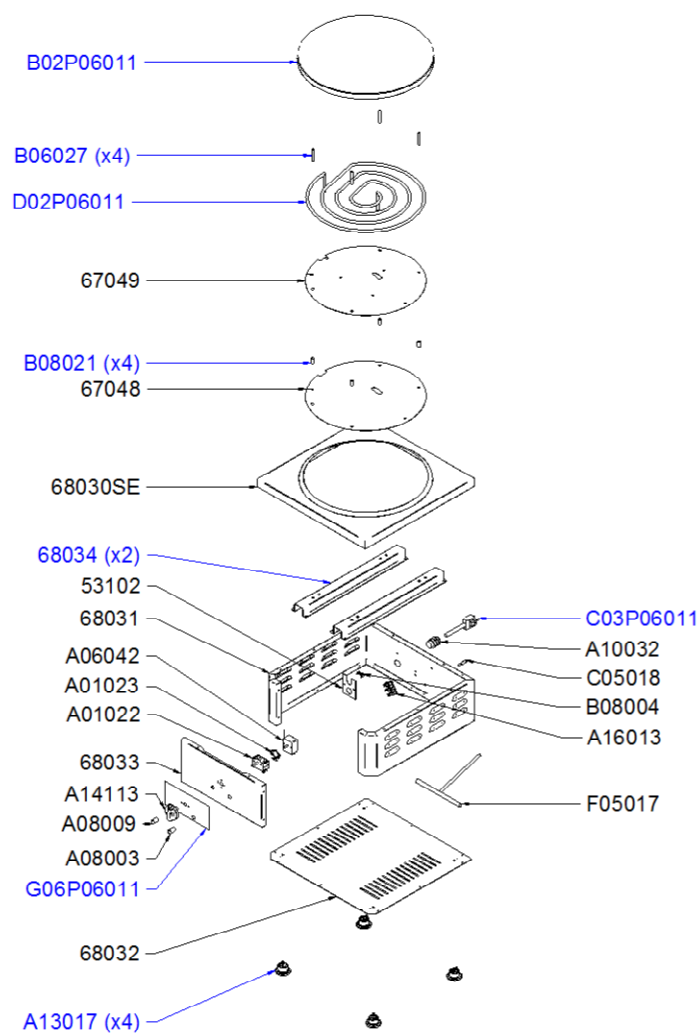

CSE 400

Vue éclatée

DT138

Date :
27/01/2016

Dessiné par :
R.L.

Approuvé par :
S.Grenon

Date :
12/10/2016

Indice
B

CODE	QTE	PIECE	SPARE PART
53102	1	BRIDE CORDON	CORD LOCK
66019	2	CONTRE DISQUE CFS/CFD	GRIDDLE HOLDER CFS/CFD
67034	2	SERRE BULBE CSE/CDE	BULB HOLDER CSE/CDE
67042	2	SERRE RESISTANCE DIAM 350	HEATING ELEMENT HOLDER DIAM 350
68034	1	RENFORT DISQUE CSE/CDE/CDG 400	PLATE HOLDER CSE/CDE/CDG 400
68039	1	CEINTURE CREPIERE CDE/CDG 350-400	CASING CDE/CDG 350-400
68040	1	FOND CDE/CDG 350-400	BOTTOM CASING CDE/CDG 350-400
68041	1	BANDEAU ELECTRIQUE CDE 350-400	CONTROL PANEL CDE 350-400
68044SE	1	PLATEAU DISQUE CREPIERE CDE/CDG 350	GRIDDLE PLATE CDE/CDG 350
A01022	2	COMMUTATEUR	COMMUTATOR
A01023	2	CLIP D'ASSEMBLAGE	CLIP
A06042	2	THERMOSTAT	THERMOSTAT
A08003	2	VOYANT ORANGE DIAM 12	ORANGE PILOT LIGHT DIAM 12
A08009	2	VOYANT VERT DIAM 12	GREEN PILOT LIGHT DIAM 12
A10032	1	PRESSE ETOUPE	CORD CLOSER
A12014	1	BOUCHON SR 1765 RF16	HOLDUP SR 1765 RF16
A13017	4	PIED	FOOT
A14113	2	BOUTON ELEC PLAT 9 H	ELECTRIC KNOB 9H
A16014	1	BORNIER 6 PLOTS CONTACT GRILL	6 HOLES DOMINO
B02016+PERCAGE	2	DISQUE FONTE CREPIERE EMAILLEE DIAM 350	ENAMELLED CAST IRON PLATE 350
B06027	8	BOUT FILETE M 6 x 40	THREAD TIP M 6 x 40
B08004	1	RIVET TERRE	EARTH RIVET
C01010	1	CABLE H07 RNF 5x2.5 FC 110 E/EG	CORD H07 RNF 5x2.5 FC 110 E/EG
C05018	1	BORNE EQUIPOTENTIEL	EQUIPOTENTIAL TERMINAL
D02013	2	RESISTANCE CREPIERE 3000W 220V	HEATING ELEMENT CREPE MACHINE 3000W 220V
F05017	1	RATEAU A CREPES	CREPE RAKE
G06P06012	2	CADRAN	FRONT PANEL

CDE 350				Nomenclature	
DT136	Date : 26/01/2016	Dessiné par : R.L.	Approuvé par : J.Godéré	Date : 12/10/2016	Indice B

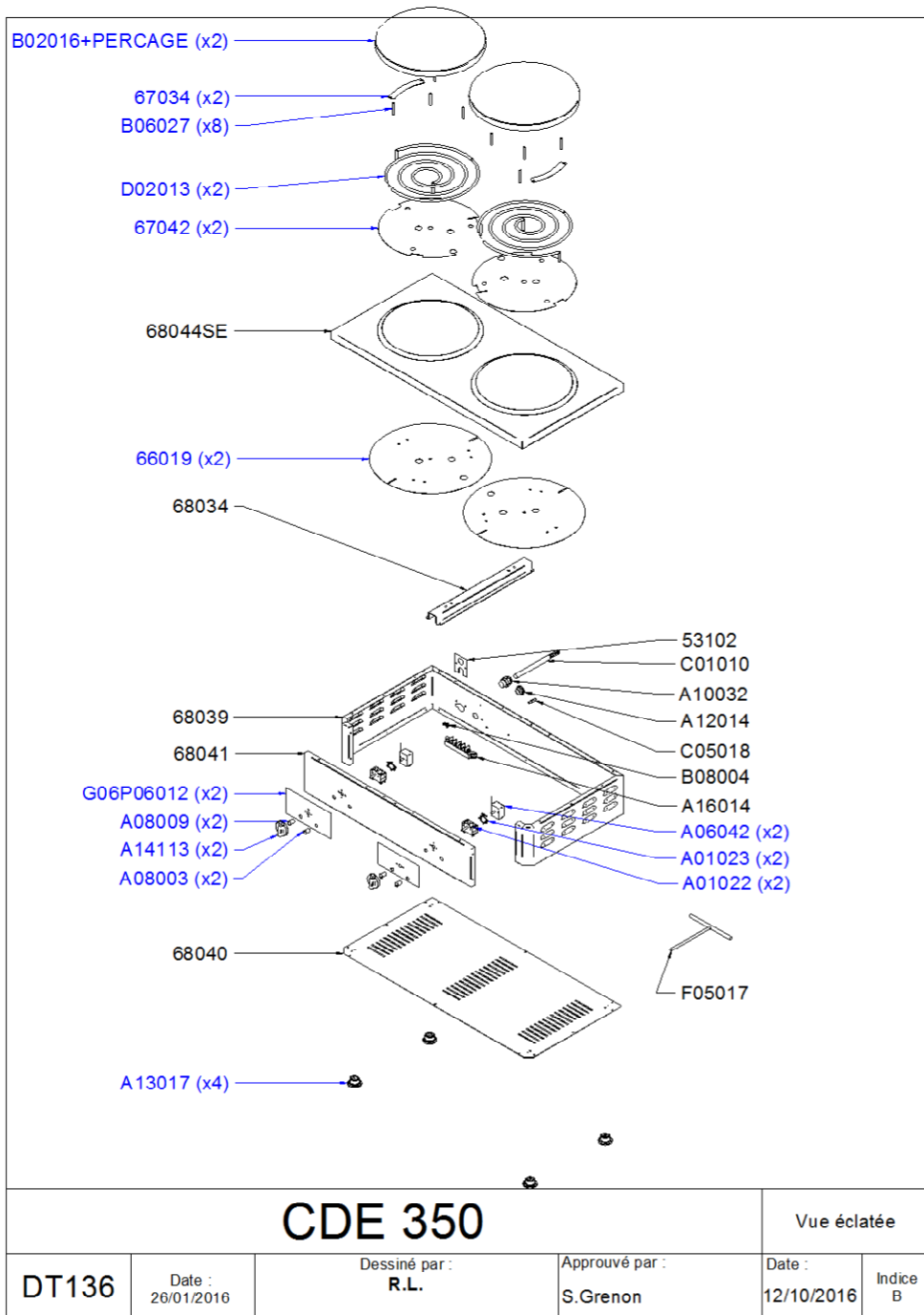

CODE	QTE	PIECE	SPARE PART
53102	1	BRIDE CORDON	CORD LOCK
67048	2	TOLE PROTECTION CREPIERE 2010	PROTECTING S/STEEL CREPE MACHINE 2010
67049	2	SERRE RESISTANCE DIAM 400	HEATING ELEMENT HOLDER DIAM 400
68034	4	RENFORT DISQUE CSE/CDE/CDG 400	PLATE HOLDER CSE/CDE/CDG 400
68038SE	1	PLATEAU DISQUE CREPIERE CDE/CDG 400	GRIDDLE PLATE CDE/CDG 400
68039	1	CEINTURE CREPIERE CDE/CDG 350-400	CASING CDE/CDG 350-400
68040	1	FOND CDE/CDG 350-400	BOTTOM CASING CDE/CDG 350-400
68041	1	BANDEAU ELECTRIQUE CDE 350-400	CONTROL PANEL CDE 350-400
A01022	2	COMMUTATEUR	COMMUTATOR
A01023	2	CLIP D'ASSEMBLAGE	CLIP
A06042	2	THERMOSTAT	THERMOSTAT
A08003	2	VOYANT ORANGE DIAM 12	ORANGE PILOT LIGHT DIAM 12
A08009	2	VOYANT VERT DIAM 12	GREEN PILOT LIGHT DIAM 12
A10032	2	PRESSE ETOUPE	CORD CLOSER
A13017	4	PIED	FOOT
A14113	2	BOUTON ELEC PLAT 9 H	ELECTRIC KNOB 9 H
A16014	1	BORNIER 6 PLOTS CONTACT GRILL	6 HOLES DOMINO
B02P06013	2	FORGE	CAST IRON
B06027	8	BOUT FILETE M 6 x 40	THREAD TIP M 6 x 40
B08004	1	RIVET TERRE	EARTH RIVET
B08021	8	ENTRETOISE ACIER CONTACT GRILL	STEEL SPACER
C03P06013	2	CORDON	CORD
C05018	1	BORNE EQUIPOTENTIEL	EQUIPOTENTIAL TERMINAL
D02163	2	RESISTANCE CREPIERE 3600 W NM	HEATING ELEMENT CREPE MACHINES 3600 W NEW
F05017	1	RATEAU A CREPES	CREPE RAKE
G06P06013	1	CADRAN	FRONT PANEL

CDE 400				Nomenclature	
DT131	Date : 21/01/2016	Dessiné par : R.L.	Approuvé par : J.Godéré	Date : 12/10/2016	Indice B

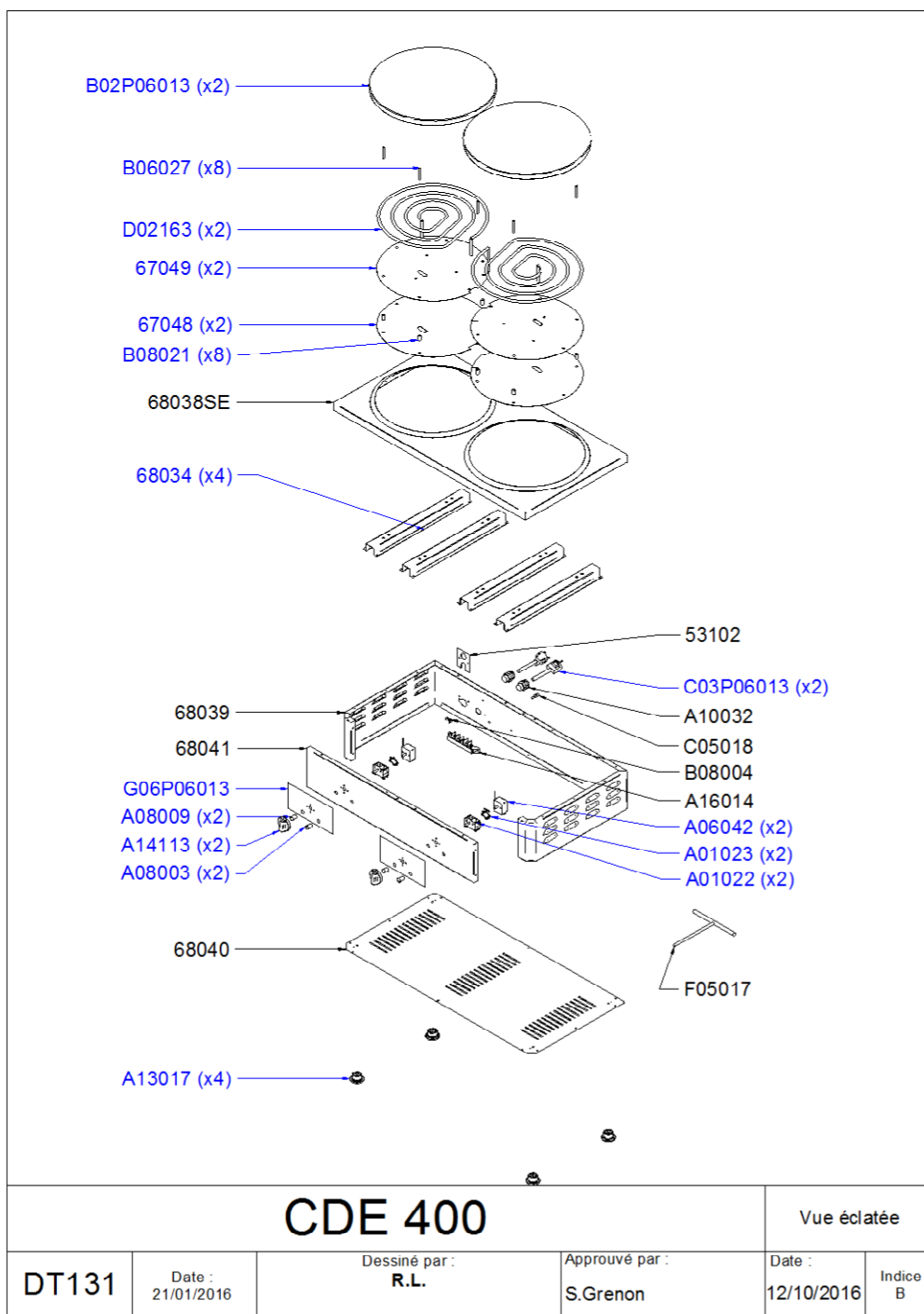

G03244