



T&S BRASS AND BRONZE WORKS, INC.
 2 Saddleback Cove / P.O. Box 1088
 Travelers Rest, SC 29690

Model No.
CEF-4DS-ST

Item No.

Travelers Rest, SC: 800-476-4103 • Simi Valley, CA: 800-423-0150 • Fax: 864-834-3518 • www.tsbrass.com

This Space for Architect/Engineer Approval

Job Name _____ Date _____
 Model Specified _____ Quantity _____
 Customer/Wholesaler _____
 Contractor _____
 Architect/Engineer _____

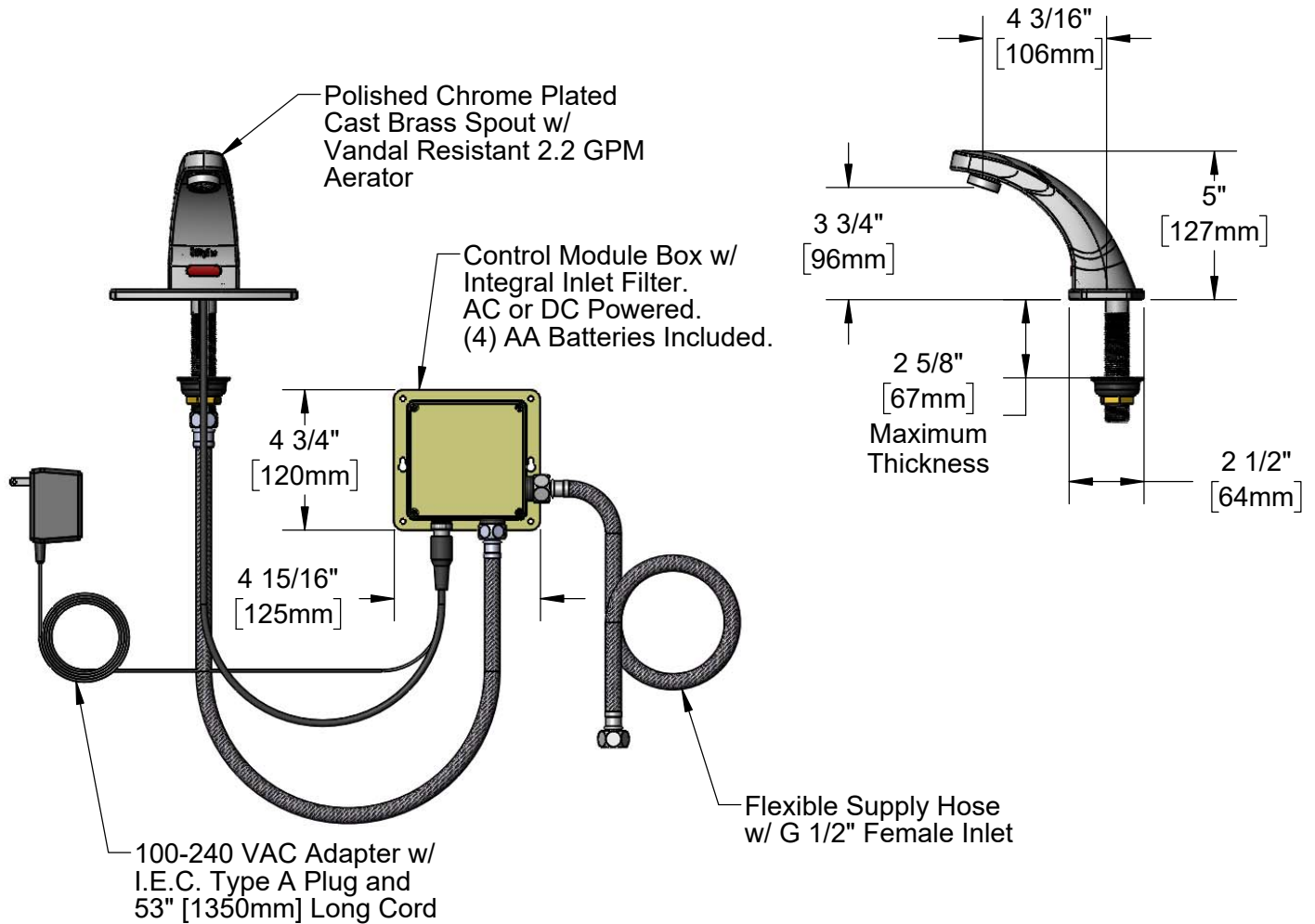
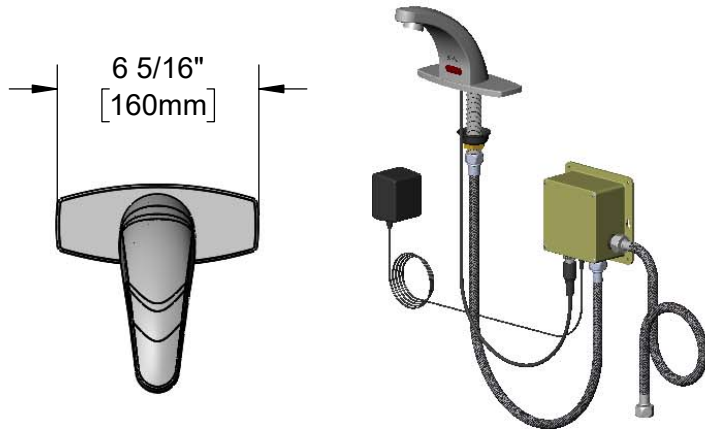

Rough-In Requirement:
 Ø 1 1/4" [32mm] Mounting Hole

Product Specifications:
 Single Hole, Single Temperature, Deck Mount Sensor Faucet w/ Cast Spout, Deck Plate, VR 2.2 GPM Aerator, Control Module, AC/DC Transformer and G 1/2" Flexible Supply Hose

Product Compliance:



T&S BRASS AND BRONZE WORKS, INC.
2 Saddleback Cove / P.O. Box 1088
Travelers Rest, SC 29690

Model No.
CEF-4DS-ST

Item No.

Travelers Rest, SC: 800-476-4103 • Simi Valley, CA: 800-423-0150 • Fax: 864-834-3518 • www.tsbrass.com

ITEM NO.	SALES NO.	DESCRIPTION
1	EU-0199-M24-V22	VR 2.2 GPM Aerator, M24x1 Male
2	020377-45	Sensor Cable
3	019920-45	Control Module
4	019927-45	Supply Hose, G 1/2" Connections
5	019924-45	Plug-in AC Transformer

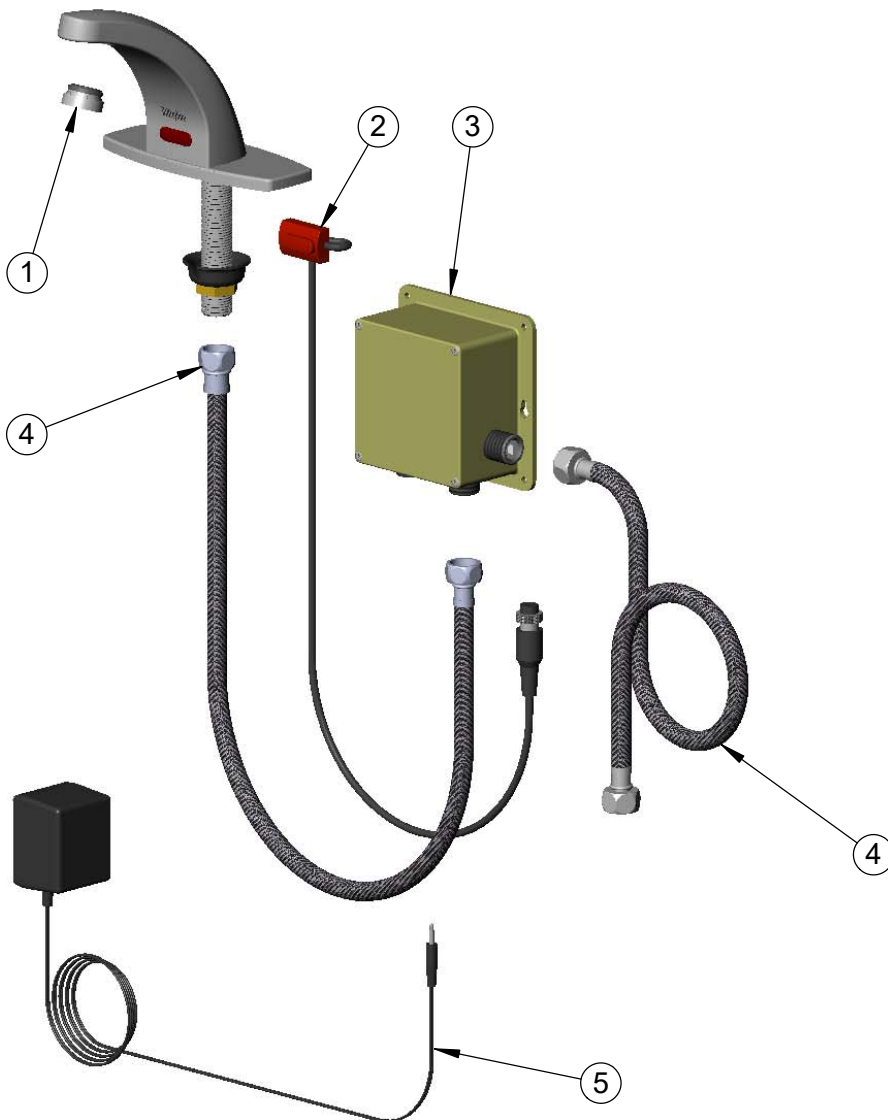

Product Specifications:

Single Hole, Single Temperature, Deck Mount Sensor Faucet w/ Cast Spout, Deck Plate, VR 2.2 GPM Aerator, Control Module, AC/DC Transformer and G 1/2" Flexible Supply Hose

Product Compliance: