

CS-1CUR CE

Control and Power Supply Unit

CS-1CUR is designed with a USB recorder. The file format is MP3. One 32G USB memory stick can record over 150 hours. One hot key recording makes the job easy.

Input

Type: XLR
Mic: 4.7KΩ
Line: 20KΩ

Recording Function

Interface: USB3.0 32GByte (Backward Compatible)
Format: MP3
MAX. Recording Time: More than 240 hours (With 32GByte USB)
Controls: Recording ON/OFF button / Recording status LED display / Without Playback Function

MAX Gain: > 70dB
Frequency Respond: 35 ~ 20,000 Hz
THD% Input: <0.06%
Signal-to-noise ratio: > 70 dB
Input Attenuation: -50dB
Phantom Power: +48 V
Mic In Attenuation: -5dB / -10dB
Mic Attenuation: -10dB / -15dB / -20dB
Output Attenuation: -50dB
Voltage Output: +5 VDC ± 0.2V
Power Supply: 18VDC, 1A
Power Consumption: 18W
Fuse: T1AE 250V (Slow-Blow)
Weight: 2.3 kg
Dimension (mm): 420 (W) * 44 (H) * 198.5 (D)



CS-1CU FC CE

Control and Power Supply Unit

The innovative CS-1 i-Conference Discussion System is equipped with JTS in-house made ECM capsule, intelligent automatic mixing technology and integrated acoustic and mechanical design, providing Turn-Key solution and delivering consistently natural, feedback-free audio performance with any environment.
The i-Conference Discussion System is ideal for discussion and meeting with up-to 150 attendants.

A CS-1 i-Conference Discussion System consists of:

- One Control and power supply unit (CU).
- Maximum 50 delegate or chairman units.
- Peripheral audio and / or telecommunication equipment.

The control unit is the center of the discussion system which controls the microphones of the chairman and delegate units as well as connects to other audio input and output. It also supplies the power for the CU itself, and up to 50 chairman and delegate units.

The delegate unit enables the attendants to participate in a discussion by speaking through a microphone, controlled by a microphone ON / OFF pushbutton, and listening to discussion by the internal loudspeaker and external headphone.
The chairman unit not only provides the same function as the delegate unit, but also supports the addition of a "Priority button", that enables the chairman to control the discussion by temporary or permanently overriding and deactivating all active microphones of the delegate units.

Voltage: VAC100-240 ~, 50/60Hz
Current consumption: MAX 1.0A (100VAC) / 0.42A (240VAC)
DC supply to contribution units: ± 15V, -7.5V

Line, telephone coupler and insertion in / outputs (unbalanced)
Input sensitivity: -14dBV / +11 dBV (nominal / maximum)
Input impedance: 33KΩ
Output level: -14dBV / +11 dBV (nominal / maximum)
Output impedance: 500Ω

Recorder in / output (unbalanced)
Input sensitivity: -20dBV / +5 dBV (nominal / maximum)
Input impedance: 47KΩ (for L & R channel)
Adjustment: -20dBV / +5 dBV (nominal / maximum)
Output level: +0 / -30dBV
Output impedance: 500Ω

External microphone input (XLR (F) balanced)
Input sensitivity: -56dBV
Adjustment: +6dBV/-6dBV (nominal / maximum)
Phantom supply: 12V+/-1V, 2 * 680Ω (± 2%)

Headphone output
Output level: -8dBV / +2dBV (nominal / maximum)
Output Impedance: 22Ω

System limits: Number of delegate / chairman units connected to one control unit
Maximum in total: 50
Maximum per trunk output: 25
Maximum trunk length using CS-1: standard cabling: 50m
Dimensions (HxWxD): 360 mm*150 mm*90 mm
Weight: 1845 grams



CS-1CH / CS-1DU FC CE

Chairman Unit / Delegate Unit

Gooseneck Microphone
Type: Back Electret Condenser
Frequency Response: 50 ~ 18,000 Hz
Polar Pattern: Cardioid
Max. SPL for 1% THD: 125dB
Gooseneck Length: 12 "(305mm)
Dimensions (HxWxD) without mic: 170 mm * 115 mm * 65 mm
Length of mic: 400 mm
Weight: 1100 grams

CS-1DUF / CS-1CHF

Delegate Unit / Chairman Unit

CS-1DUF is a flush mount version of CS-1DU
CS-1CHF is a flush mount version if CS-1CH

Model: CS-1CHF / CS-1DUF
System limits Number of delegate / chairman units connected to one control unit
Maximum in total: 50
Maximum per trunk output: 25
Maximum trunk length using CS-1: standard cabling: 100M (Trunk1:50M+ Trunk2:50M)
Dimensions (HxWxD) with Mic: 501mm*111.3 mm*45.3mm
Dimensions (HxWxD) without Mic: 85.2mm*111.3mm*45.3 mm
Weight: CS-1CHF: 343 g (with Mic)
CS-1DUF: 338 g (with Mic)

Gooseneck Microphone
Type: Back Electret Condenser
Frequency Response: 50 ~ 18,000 Hz
Polar Pattern: Cardioid
Max. SPL for 1% THD: 125dB
Length of Mic: 422mm
Weight: 84g

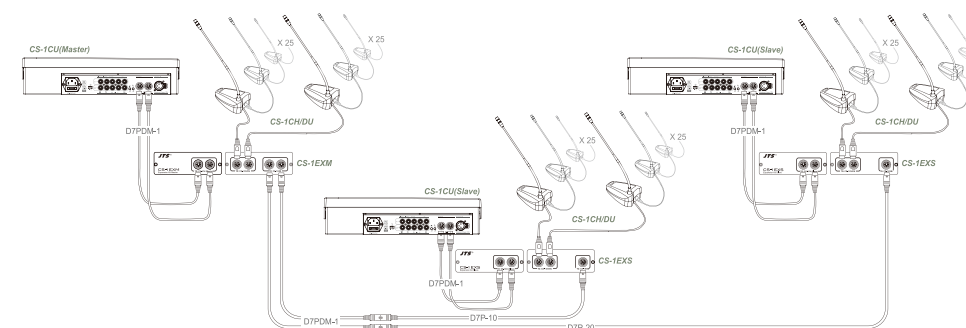

CS-1EXM / CS-1EXS

Expansion Kit

CS-1 expansion kit, combined with D7PDM-1 extension cables, can expand the number of using units of i-conference discussion system from 50 to 150 by adding maximum two additional CS-1CU functioning as power supply units only.

The system is controlled by the master CS-1CU unit.

Using D7P-10 or D7P-20 extension cables to extend the operation distance.

Input: 7-pin DIN Connector
Output: 7-pin DIN Connector
Dimension (mm): 115mm (W)*65mm (D)*38mm (H)

D7PDM-1/D7P-10/D7P-20

Din 7 pin XLR-M/XLR-M / Din 7 pin XLR-F/XLR-M
Length: 1M / 10M / 20M

