

KMDA 7633 FL

Induction cooktop with integrated extractor
with two PowerFlex cooking areas and a centrally positioned ventilation hood

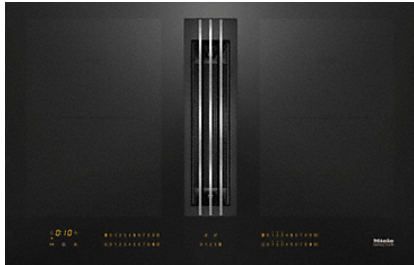

- Automatic fan power regulation – Con@ctivity
- Intuitive and quick selection via number sequences – Smart Select
- Versatile and fast – 4 cooking zones incl. 2 PowerFlex areas
- Efficient filtration – 10-layer stainless-steel grease filter
- Energy-efficient and quiet – powerful ECO motor

Heating type	
Heating type	Electric with induction
Construction type	
Induction hob with integrated extractor	•
Operating modes	
Type of air guide	Convertible
Design	
Ceramic surface colour	Black
Surface-mounted installation	•
Cooking zone details	
Number of cooking zones	4
Number of cooking areas	2
Maximum number of pans	4
PowerFlex cooking zone	
No.	4
Diameter in mm	Ø 150 – 230
Max. rating in W	2100
Max. Booster power rating in W	3000
Max. TwinBooster power rating in W	3650
1st cooking zone/cooking area	
Position	Left
Type	PowerFlex bridge
Diameter in mm	230x390
Max. rating in W	3400
Max. Booster power rating in W	4800
Max. TwinBooster power rating in W	7300
2nd cooking zone/cooking area	
Position	right
Type	PowerFlex bridge
Diameter in mm	230x390
Max. rating in W	3400
Max. Booster power rating in W	4800
Max. TwinBooster power rating in W	7300
User convenience	
Display colour	Yellow
Permanent pan recognition	•
Keeping warm	•
Stop & Go function	•
Recall function	•
Minute minder	•
Safety switch-off	•
Auto heat-up	•
Individual setting options (e.g. buzzers)	•

KMDA 7633 FL

Induction cooktop with integrated extractor
with two PowerFlex cooking areas and a centrally positioned ventilation hood

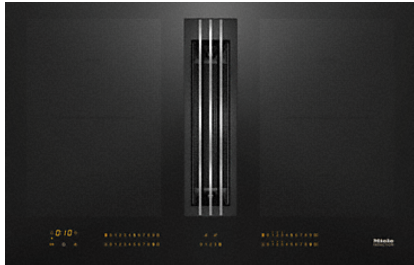

Appliance networking	
Miele@home	•
Automatic function Con@ctivity	•
WiFiConn@ct	•
Efficiency and sustainability	
ECO motor	•
Cleaning convenience	
Easy to clean ceramic glass	•
Wipe protection	•
Easy-to-clean canopy interior – CleanCover	•
Filter system	
Number of dishwasher safe stainless steel grease filters	1
Air throughput with max. duct diameter in extraction mode	
Air throughput in Level 1 (m ³ /h) according to EN 61591	170
Air throughput in Level 2 (m ³ /h) according to EN 61591	330
Air throughput in Level 3 (m ³ /h) according to EN 61591	490
Air throughput in Intensive level (m ³ /h) according to EN 61591	570
Sound power in Level 1 (dB(A) re 1 pW) according to EN 60704-3	45
Sound power in Level 2 (dB(A) re 1 pW) according to EN 60704-3	60
Sound power in Level 3 (dB(A) re 1 pW) according to EN 60704-3	69
Noise power level in Intensive setting (dB(A) re 1 pW) according to EN 60704-3	73
Sound pressure in Level 1 (dB(A) re 20 µPa) according to EN 60704-2-13	30
Sound pressure in Level 2 (dB(A) re 20 µPa) according to EN 60704-2-13	45
Sound pressure in Level 3 (dB(A) re 20 µPa) according to EN 60704-2-13	54
Noise pressure level in Intensive setting (dB(A) re 20 µPa) according to EN 60704-2-13	59

KMDA 7633 FL

Induction cooktop with integrated extractor

with two PowerFlex cooking areas and a centrally positioned ventilation hood

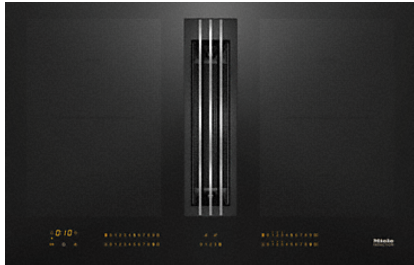

Air throughput in recirculation mode	
Air throughput in Level 1 (m ³ /h) according to EN 61591	110
Air throughput in Level 2 (m ³ /h) according to EN 61591	260
Air throughput in Level 3 (m ³ /h) according to EN 61591	420
Air throughput in Intensive level (m ³ /h) according to EN 61591	510
Sound power in Level 1 (dB(A) re 1 pW) according to EN 60704-3	45
Sound power in Level 2 (dB(A) re 1 pW) according to EN 60704-3	61
Sound power in Level 3 (dB(A) re 1 pW) according to EN 60704-3	70
Noise power level in Intensive setting (dB(A) re 1 pW) according to EN 60704-3	75
Sound pressure in Level 1 (dB(A) re 20 µPa) according to EN 60704-2-13	30
Sound pressure in Level 2 (dB(A) re 20 µPa) according to EN 60704-2-13	46
Sound pressure in Level 3 (dB(A) re 20 µPa) according to EN 60704-2-13	56
Noise pressure level in Intensive setting (dB(A) re 20 µPa) according to EN 60704-2-13	61
Safety	
Safety switch-off	•
Lock function	•
System lock	•
Integrated cooling fan	•
Overheating protection	•
Residual heat indicator	•
Technical data set	
Dimensions in mm (width)	800
Dimensions in mm (height)	206
Dimensions in mm (depth)	520
Casing height incl. connection box in mm	200
Cutout dimensions in mm (width) with surface-mounted installation	780
Cutout dimensions in mm (depth) with surface-mounted installation	500
Inner cut-out dimensions in mm (width) with flush installation	780
Inner cut-out dimensions in mm (depth) with flush installation	500
Outer cut-out dimensions in mm (width) with flush installation	804
Outer cut-out dimensions in mm (depth) with flush installation	524
Weight in kg	22
Total rated load in kW	7.5
Voltage in V	230
Frequency in Hz	50-60
Connection cable length in m	2

KMDA 7633 FL

Induction cooktop with integrated extractor
with two PowerFlex cooking areas and a centrally positioned ventilation hood

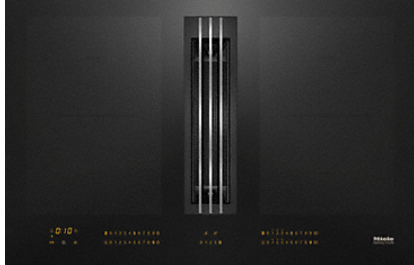

Standard accessories

Mains cable

Yes

KMDA 7633 FL

Induction cooktop with integrated extractor
with two PowerFlex cooking areas and a centrally positioned ventilation hood

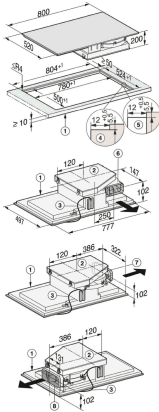
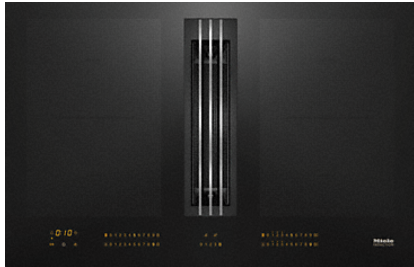

KMDA 7633 FL, KMDA 7634 FL - flush (Installation drawing)

- 1) Front
- 2) The removable drip tray must be accessible after installation.
- 3) Mains connection box with mains connection cable, L = 1440 mm
- 4) Stepped cut-out
- 5) Wooden support frame (not supplied with the appliance)
- 6) Duct connection at rear >220-222 x 89-90 / R1-R19 (machine delivered with this option)
- 7) Duct connection to the right >220-222 x 89-90 / R1-R19 (requires conversion)
- 8) Duct connection to the left >220-222 x 89-90 / R1-R19 (requires conversion)

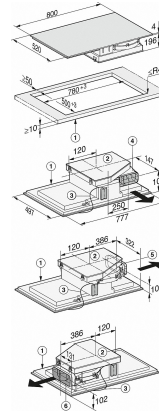

KMDA 7633 FL, KMDA 7634 FL - frameless supported (Installation drawing)

- 1) Front
- 2) The removable drip tray must be accessible after installation.
- 3) Mains connection box with mains connection cable, L = 1440 mm
- 4) Duct connection at rear >220-222 x 89-90 / R1-R19 (machine delivered with this option)
- 5) Duct connection to the right >220-222 x 89-90 / R1-R19 (requires conversion)
- 6) Duct connection to the left >220-222 x 89-90 / R1-R19 (requires conversion)