

## KM 6839

Induction cooktop with onset controls  
with TempControl for intelligent and easy frying

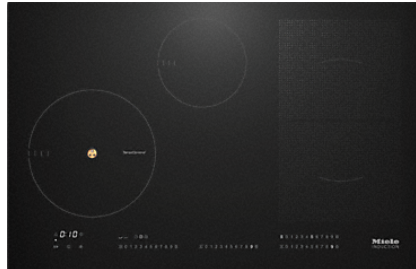

- Intuitive quick select w. numerical keybank – Smart Select White
- Modern design – 752mm wide for flush-fit installation
- Smart and versatile – 4 cooking zones including TempControl
- Communication with rangehood – automatic function Con@ctivity 2.0
- Broad performance spectrum – Food Warming Plus and TwinBooster

Heating type	
Heating type	Induction
Construction type	
Independent of cooker	•
Design	
Elegant glass ceramic surface	•
Ceramic surface colour	Graphite black
Print design	LightPrint
Flush	•
Cooking zone details	
Number of cooking zones	4
PowerFlex cooking zones	
No.	2
Diameter in mm	150x230
Rating in W	2.100
Booster in W	3.000
TwinBooster in W	3650
Cooking zone	
Position	front left
Type	Dual-circuit ring
Diameter in mm	Ø 160-230
Rating in W	2300
Booster in W	3000
TwinBooster in W	3700
Position	rear left
Type	Dual-circuit ring
Diameter in mm	Ø 100-160
Rating in W	1400
Booster in W	1750
TwinBooster in W	2200
Position	right
Type	PowerFlex bridge
Diameter in mm	230x390
Rating in W	3400
Booster in W	4800
TwinBooster in W	7300
User convenience	
Operation via sensor controls	Smart Select White
Pan and pan size recognition	•
Stop & Go function	•
Minute minder	•
Safety switch-off	•
Auto heat-up	•
Keeping warm	•
Individual setting options (e.g. buzzers)	•
Displays	
Digital power level display	•
Appliance networking	
Miele@home	•
Automatic function Con@ctivity 2.0	•
Cleaning convenience	
Easy to clean ceramic glass	•

KM 6839

Induction cooktop with onset controls  
with TempControl for intelligent and easy frying

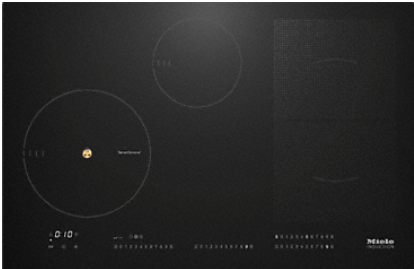

Safety	
Safety switch-off	•
Lock function	•
System lock	•
Fault monitoring	•
Integrated cooling fan	•
Overheating protection	•
Residual heat indicator	•
Technical data	
Dimensions in mm (width)	752
Dimensions in mm (depth)	492
Casing height incl. connection box in mm	52
Voltage in V	230
Total rated load in kW	7.3
Weight in kg	12
Length of supply lead in m	1.4
Standard accessories	
Mains cable	•

## KM 6839

Induction cooktop with onset controls  
with TempControl for intelligent and easy frying

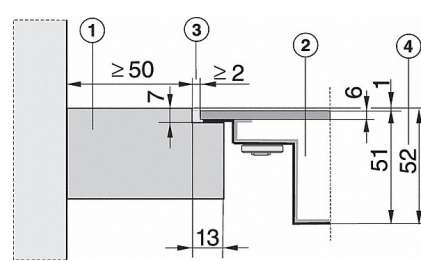
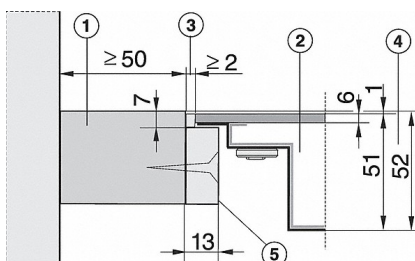
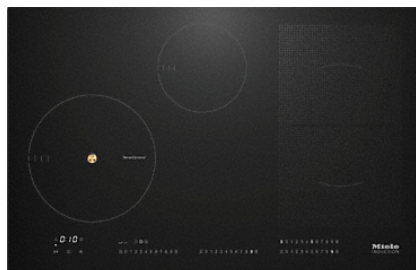

KM 6839, KM 6639 - Installation in tiled and solid worktops (Installation drawing)

1. Worktop
2. Cooktop
3. Gap
4. Casing depth
5. Wooden frame, 13 mm (not included)

### Installation instructions:

Flush hobs are designed for installation in natural stone (granite, marble), solid wood and tiled worktops. Please enquire with manufacturer regarding worktops made from other materials.

The minimum clear width of the base unit has to be at least as wide as the worktop cut-out to ensure that after installation the hob is accessible from below, and the chassis can be removed for servicing.

As the ceramic glass screen and the worktop cut-out are subject to certain dimensional tolerances, joint widths can vary (min. 1 mm).

KM 6839, KM 6639 - Installation in granite or marble worktops (Installation drawing)

1. Worktop
2. Cooktop
3. Gap
4. Casing depth

### Installation instructions:

Flush hobs are designed for installation in natural stone (granite, marble), solid wood and tiled worktops. Please enquire with manufacturer regarding worktops made from other materials.

The minimum clear width of the base unit has to be at least as wide as the worktop cut-out to ensure that after installation the hob is accessible from below, and the chassis can be removed for servicing.

As the ceramic glass screen and the worktop cut-out are subject to certain dimensional tolerances, joint widths can vary (min. 1 mm).

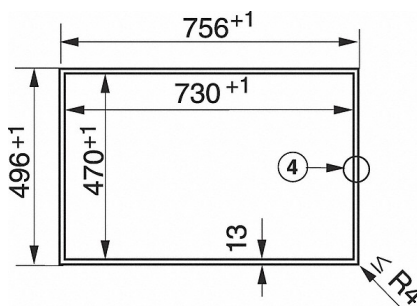

KM 6839, KM 6639 - Stepped cut-out (Installation drawing)

### 4) Stepped cut-out

### Installation instructions:

Flush hobs are designed for installation in natural stone (granite, marble), solid wood and tiled worktops. Please enquire with manufacturer regarding worktops made from other materials.

The minimum clear width of the base unit has to be at least as wide as the worktop cut-out to ensure that after installation the hob is accessible from below, and the chassis can be removed for servicing.

As the ceramic glass screen and the worktop cut-out are subject to certain dimensional tolerances, joint widths can vary (min. 1 mm).

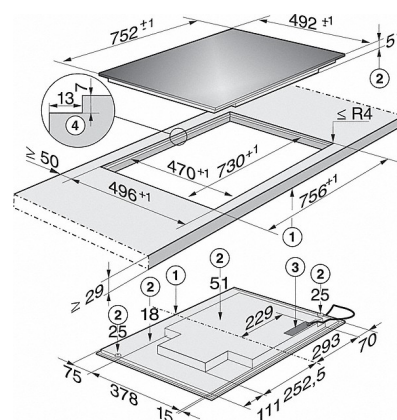

KM 6839, KM 6639 (Installation drawing)

1. Front
  2. Casing depth
  3. Mains connection box, mains connection cable, L = 1440 mm, supplied loose
  4. Stepped cut-out
- Building-in information:  
This hob is only suitable for installation in granite, marble, tiled or solid wood worktops. For other materials please ask manufacturer, if building-in of this hob is possible. As the ceramic glass and the worktop cut-out have a certain dimensional tolerance, gap can vary (min. 2 mm).