

FEATURES

- Solid Brass Construction for Durability and Reliability
- Small, Sleek Design
- Water Pressure Helps Keep Drain Sealed when Closed but also Helps it Stay Open when Draining
- Available in Standard Finishes to Match Existing Kallista Collections

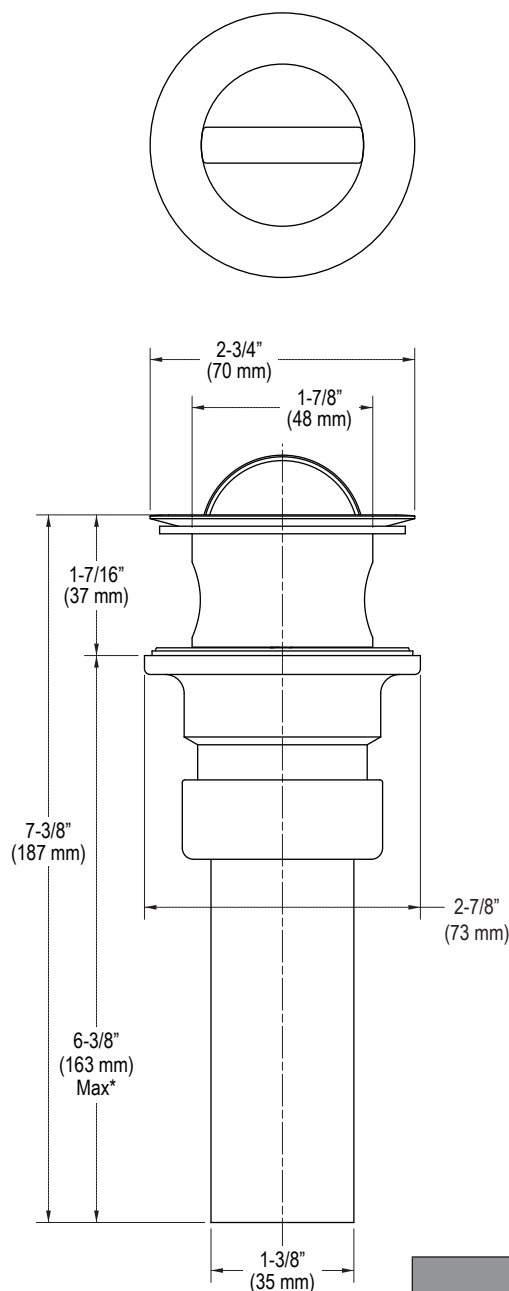

ROUGHING-IN NOTES

All Dimensions are Nominal.

* Tailpiece can be cut as needed.

SPECIFIED MODEL

Model	Description	Finishes			
		<input type="checkbox"/> CP Polished Chrome	<input type="checkbox"/> AD Nickel Silver	<input type="checkbox"/> AG Brushed Nickel	<input type="checkbox"/> GN Gunmetal
P21579-00	Flip Drain	<input type="checkbox"/> CP Polished Chrome	<input type="checkbox"/> AD Nickel Silver	<input type="checkbox"/> AG Brushed Nickel	<input type="checkbox"/> GN Gunmetal

We reserve the right to make revisions without notice in the design of products or in packaging unless this right has specifically been waived at the time the order is accepted.