

KALLISTA®

Original For Him Undercounter Basin

FEATURES

- Vitreous china for a remarkably clean, sanitary product that maintains its polished shine
- Undermount installation
- Includes mounting hardware
- Complements the Original collection

CODES/STANDARDS APPLICABLE

- Specified model meets or exceeds the following:
- ASME A112.19.2/CSA B45.1
 - ADA
 - ICC/ANSI A117.1

P72027-00

P72027-WO

ADA

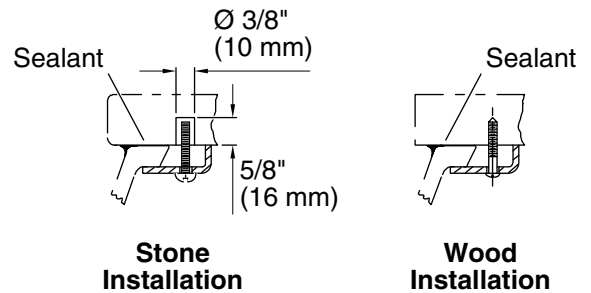
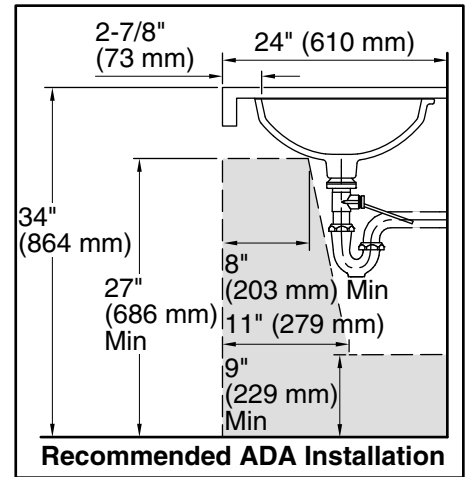
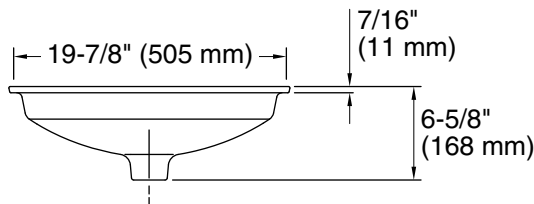
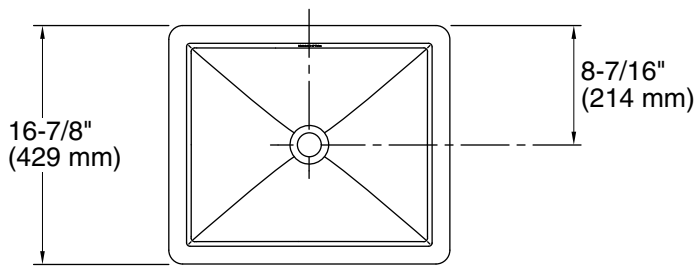

PRODUCT INFORMATION		
Fixture*:	Basin Area	Water Depth
Lavatory		
P72027-00	17-3/8" (441 mm) x 14-3/8" (365 mm)	4-7/16" (113 mm)
P72027-WO	17-3/8" (441 mm) x 14-3/8" (365 mm)	3-1/2" (89 mm)
Outlet	Ø 1-1/2" (38 mm)	
*Approximate Measurements For Comparison Only		
Included Components:		
Basin Clamp Assembly		
Cutout Template	87029-7	

INSTALLATION NOTES
All dimensions are nominal.
Will comply with ADA when installed per section 606 Lavatories and Sinks of the 2010 ADA Standards for Accessible Design.
Supplied basin clamp assemblies require 1" (25 mm) minimum countertop thickness. Installer must supply anchors for thinner countertops.

SPECIFIED MODEL			
Model	Description	Finishes	
P72027-00	Original For Him Undercounter Basin	<input type="checkbox"/> 0 Stucco White	<input type="checkbox"/> 96 Linen
P72027-WO	Original For Him Undercounter Basin With Overflow	<input type="checkbox"/> 0 Stucco White	<input type="checkbox"/> 96 Linen

We reserve the right to make revisions without notice in the design of products or in packaging unless this right has specifically been waived at the time the order is accepted.