

10257T 11621T 11639T 11640T 11641T 11642T 10257T-A 手持花洒
 18526T 18527T 18528T 18529T 18530T 14788T 12861T

安装之前

BEFORE YOU BEGIN

所有的资料是按最新出版的产品资料编写而成。科勒公司保留任何时候不经通知即可改变产品特性、包装或产品可供类型的权利。

All information is based on the latest product information available at the time of publication. Kohler Co. reserves the right to make changes in product characteristics, packaging, or availability at any time without notice.

说明书包括重要的安装、保养及清洁方面的内容，请把这些资料交给用户阅读。

Please leave these instructions for the consumer. They contain important information.

注意事项：

- 一定要先彻底冲洗供水管以清除管道中的杂质。
- 花洒最高工作压力：0.5MPa(5bar)。水压超过0.5MPa(5bar)须安装减压阀。花洒最高工作温度及环境温度：60°C。请特别注意花洒同花洒连接的臂管须远离浴霸，否则可能损坏花洒及其密封件，甚至对使用者造成伤害。

NOTES:

- Flush the water supply pipes thoroughly to remove debris.
- The highest working pressure for spray is 0.5MPa (5bar). If it exceeds 0.5MPa(5bar), a pressure reducer is needed. The highest water and environment temperature is 60°C. Please keep handspray, shower head and the shower arm away from heater, or it may become damaged and cause injury to the user.

安装尺寸

ROUGH-IN DIMENSIONS

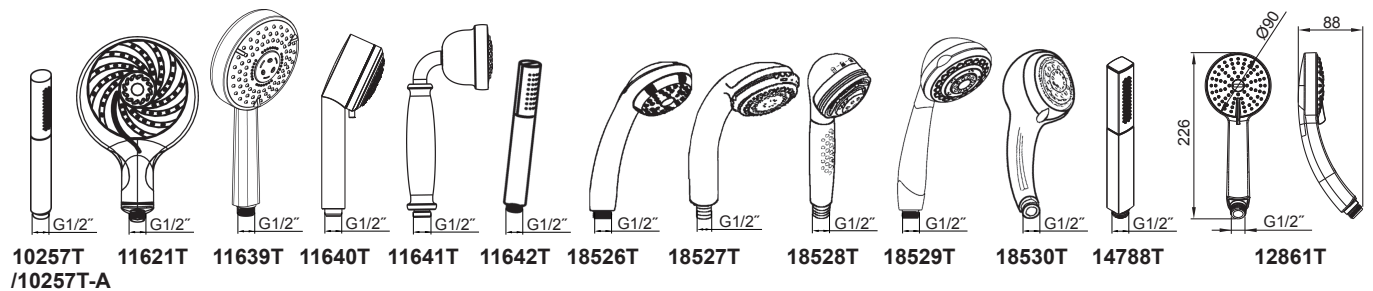

安装步骤

INSTALLATION

对于11621T/11640T/11642T/
 18526T/18527T/18528T/18529T/
 18530T

将限流器(1)(18528T已带有限流器，无需额外安装)如图示方向塞入花洒(2)进水口，用垫片(3)(注意：对于18527T & 18528T，使用5mm厚垫片。)连接花洒与花洒软管(4)。

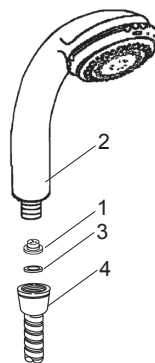

For 11621T/11640T/11642T/
 18526T/18527T/18528T/18529T/
 18530T

Put the restrictor(1)(The restrictor of 18528T has been inside, needn't manual install) into the handspray(2) inlet as shown. Connect shower hose(4) to handspray with washer(3)(NOTE: For 18527T & 18528T, use the washer of thickness 5mm.).

**对于10257T,10257T-A,11641T
&14788T**

根据需要，按照说明安装限流器(5)和弹性挡圈(6)。用垫片(7)连接花洒与花洒软管(8)。

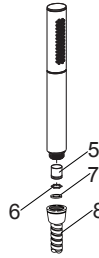

**For 10257T,10257T-A,11641T
&14788T**

If needed, install the restrictor(5) and spring washer(6) according to installation instruction. Connect shower hose(8) to handspray with washer(7).

对于11639T

用垫片(9)连接花洒与花洒软管(10)。

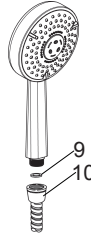

For 11639T

Connect shower hose(10) to handspray with washer(9).

对于12861T

将限流器(13)塞入花洒(14)进水口,用花洒软管(11,客户自备)及垫片(12,客户自备)将花洒连接到水源。

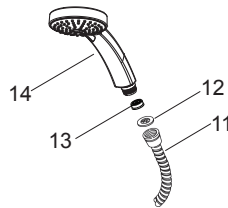

For 12861T

Put the water flow restrictor(13) into the handspray(14) inlet. Connect hand-spray to water supply with shower hose(11, not provided) and washer(12, not provided).

清洗说明

适用于所有加工处理过的表面：以中性肥皂水清洗镀层表面，再以干净的软布彻底擦干整个表面，许多清洁剂，比如氨水、去污粉及洁厕灵等，会对电镀表面造成伤害，切忌使用。

有磨损性的清洁用具或清洁剂也不可用于科勒牌的水龙头及其配件上。

CLEANING INSTRUCTIONS

All Finishes: Clean the finish with mild soap and warm water. Wipe entire surface completely dry with clean soft cloth. Many cleaners may contain chemicals, such as ammonia, chlorine, toilet cleaner etc, which could adversely affect the finish and are not recommended for cleaning.

Do not use abrasive cleaners or solvents on Kohler faucets and fittings.

零件图

SERVICE PARTS

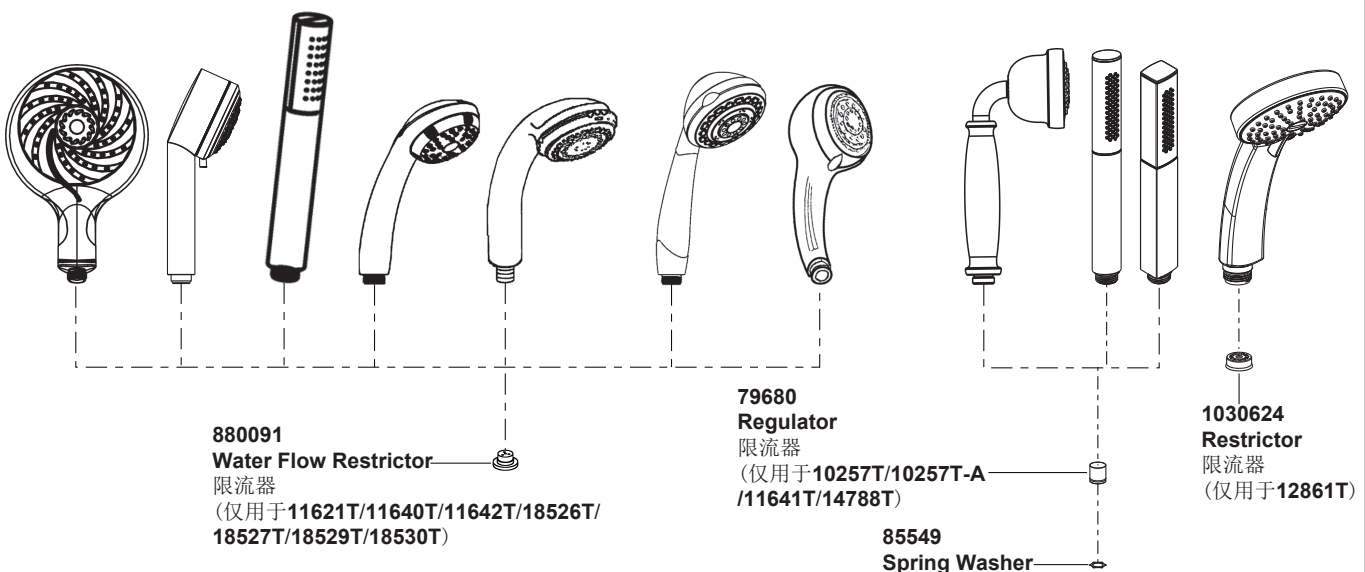

880091
Water Flow Restrictor
限流器
(仅用于11621T/11640T/11642T/18526T/
18527T/18529T/18530T)

79680
Regulator
限流器
(仅用于10257T/10257T-A
/11641T/14788T)

85549
Spring Washer
弹性挡圈
(仅用于10257T/10257T-A/11641T/14788T)

1030624
Restrictor
限流器
(仅用于12861T)

**订购时请说明颜色编号
**Color code must be specified when ordering