

A84 gPV 1500 VDC Fuse 14x51 mm



FEATURES:

- 1500 VDC, 14x51 mm PV fuse link with glass-fiber body
- Rated Current: 1-32 A (regular use)
- 1-50 A (single mount inline fuse)
- Breaking Capacity: 10 kA at 1500 VDC
- Time Constant: 1-3 ms
- Special design with silver plated caps for high-power PV applications
- Approvals: UL248-19 (File: E490190)
- Comply to: IEC 60269-6/GBT 13539.6
- Customizable for special application

ELECTRICAL SPECIFICATIONS

Part Number			Rated Current	Ampere Code	Breaking Capacity	Nom Cold Resistance (mΩ)	I ² t (A ² s)		Certifications
Cylindrical	10/12 AWG In-terminal	8 AWG In-terminal					Pre-Arcing	Total	
A841100b00	A841100b01	A841100b04	1 A	1100	10 kA@1500 VDC	950	20	110	•
A841200b00	A841200b01	A841200b04	2 A	1200		309	40	220	•
A841300b00	A841300b01	A841300b04	3 A	1300		210	60	330	•
A841400b00	A841400b01	A841400b04	4 A	1400		89.5	80	440	•
A841500b00	A841500b01	A841500b04	5 A	1500		69	100	550	•
A841600b00	A841600b01	A841600b04	6 A	1600		47.4	120	660	•
A841800b00	A841800b01	A841800b04	8 A	1800		32.9	160	880	•
A842100b00	A842100b01	A842100b04	10 A	2100		17.88	200	1100	•
A842120b00	A842120b01	A842120b04	12 A	2120		16.45	240	1320	•
A842150b00	A842150b01	A842150b04	15 A	2150		8.67	300	1650	•
A842160b00	A842160b01	A842160b04	16 A	2160		8.38	320	1760	•
A842200b00	A842200b01	A842200b04	20 A	2200		6.25	400	2200	•
A842250b00	A842250b01	A842250b04	25 A	2250		5.23	500	2750	•
A842300b00	A842300b01	A842300b04	30 A	2300		3.63	600	3300	•
A842320b00	A842320b01	A842320b04	32 A	2320		3.55	640	3520	•
-	A842350b01	A842350b04	35 A	2350		3.21	700	3850	•
-	A842400b01	A842400b04	40 A	2400		2.67	800	4400	•
-	A842450b01	A842450b04	45 A	2450		2.3	900	4950	•
-	A842500b01	A842500b04	50 A	2500		1.93	1000	5500	•

Note: (1) Typical pre-arcing I²t measured at 10*In current

ELECTRICAL SPECIFICATIONS

Part Number		Rated Current	Ampere Code	Breaking Capacity	Nom Cold Resistance (mΩ)	I ² t (A ² s)		Dissipation (W)		Certifications
Fixing Mount	Level Mount					Pre-Arcing	Total	0.8 I _n	1.0 I _n	UL
A841100b02	A841100b03	1 A	1100	10 kA@1500 VDC	950	20	110	0.1	0.1	○
A841200b02	A841200b03	2 A	1200		309	40	220	0.2	0.3	○
A841300b02	A841300b03	3 A	1300		210	60	330	0.3	0.4	○
A841400b02	A841400b03	4 A	1400		89.5	80	440	0.4	0.6	○
A841500b02	A841500b03	5 A	1500		69	100	550	0.5	0.7	○
A841600b02	A841600b03	6 A	1600		47.4	120	660	0.6	0.9	○
A841800b02	A841800b03	8 A	1800		32.9	160	880	0.9	1.1	○
A842100b02	A842100b03	10 A	2100		17.88	200	1100	1.1	1.4	○
A842120b02	A842120b03	12 A	2120		16.45	240	1320	1.3	1.7	○
A842150b02	A842150b03	15 A	2150		8.67	300	1650	1.6	2.2	○
A842160b02	A842160b03	16 A	2160		8.38	320	1760	1.7	2.4	○
A842200b02	A842200b03	20 A	2200		6.25	400	2200	2.1	2.9	○
A842250b02	A842250b03	25 A	2250		5.23	500	2750	2.7	3.6	○
A842300b02	A842300b03	30 A	2300		3.63	600	3300	3.2	4.3	○
A842320b02	A842320b03	32 A	2320		3.55	640	3520	3.4	4.6	○
A842350b02	A842350b03	35 A	2350		3.21	700	3850	3.7	5	○
A842400b02	A842400b03	40 A	2400		2.67	800	4400	4.3	5.7	○
A842450b02	A842450b03	45 A	2450		2.3	900	4950	4.8	6.5	○
A842500b02	A842500b03	50 A	2500		1.93	1000	5500	5.3	7.2	○

Note: (1) Typical pre-arcing I²t measured at 10*I_n current

TIME VS CURRENT CHARACTERISTIC

Rated Current	100 %	135 %	200 %
1-50 A	Temperature Stabilization	<1 h	<4 min

APPLICATIONS:

- PV combiner/ junction boxes
- Inverters
- Battery Charge Controllers

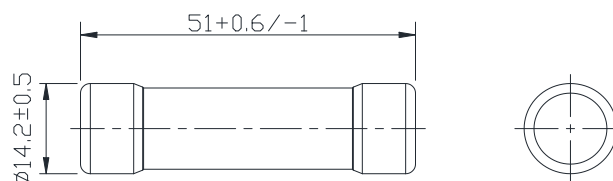
DIMENSIONS (mm)
A84xxxxb00

DIMENSIONS (mm)

A84xxxxb02

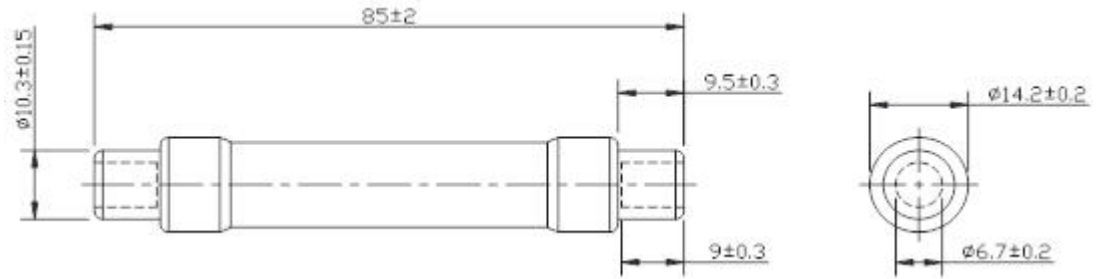

A84xxxxb03

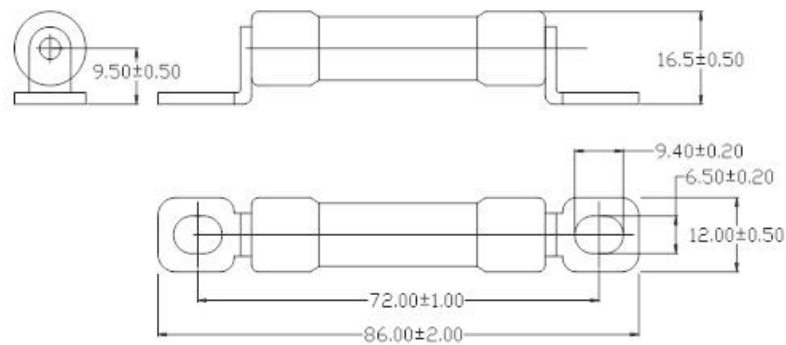

A84xxxxb01
A84xxxxb04

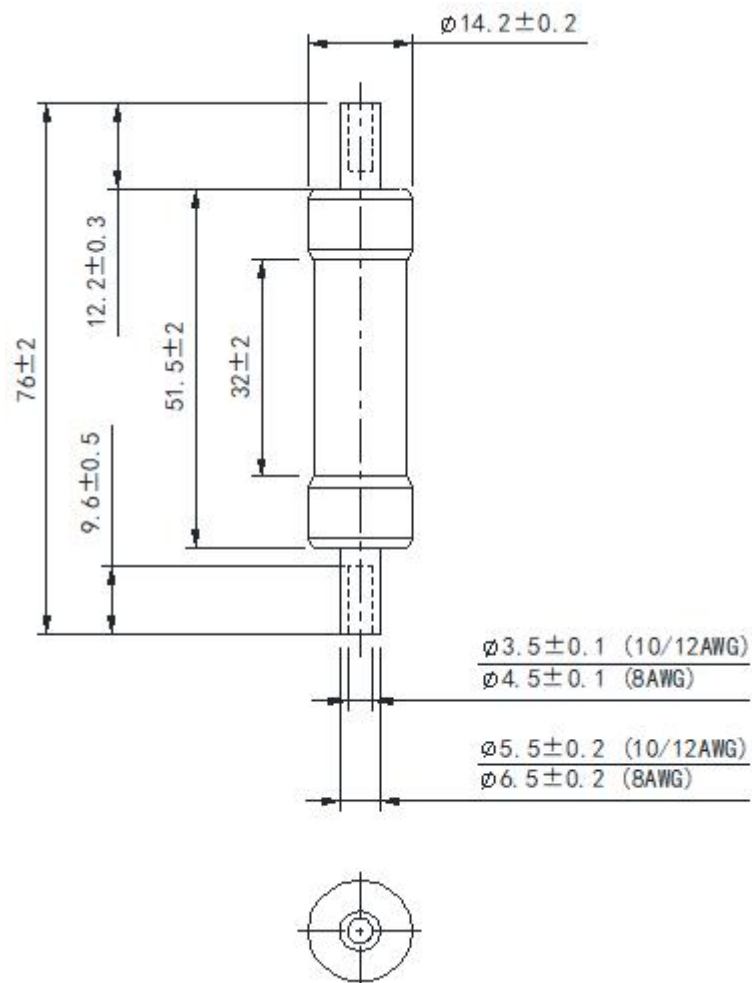

PART NUMBER SYSTEM

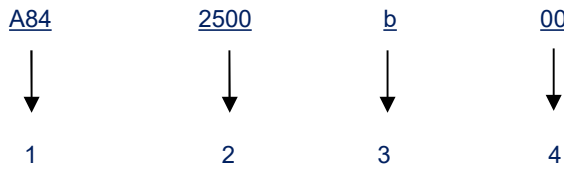

- 1Product SeriesA84
- 2Ampere Code50 A (see ampere code column of electrical specifications)
- 3Rated Voltageb: 1500 V
- 4Supplementary Code00: Cylindrical; 02: Fixing Mount; 03: Level Mount;
01: 10/12 AWG In-terminal; 04: 8 AWG In-terminal

Time Current Curve (reference)

