



LG Hausys HEADQUARTER One IFC 10 Gookjegeumyoong-Ro, Yeouido-Dong, Yeongdeungpo-Gu, Seoul, 150-876, Korea Tel +82-2-6930-0907 Fax +82-2-6930-0903

OVERSEAS BRANCHES

**ATLANTA (LG Hausys America, Inc.)**  
900 Circle 75 Pkwy Suite#1500, Atlanta. GA 30339 TEL: 1-578-486-8214

**FRANKFURT (LG Hausys Europe GMBH)**  
Lyoner str 15, Atricom C6, D-60528 Frankfurt / main, Germany TEL: 49- 69-710-445-0

**SHANGHAI (LG HAUSYS TRADING CO. LTD)**  
10th Floor, Shanghai Magnolia Plaza 19, No. 777 Hongqiao Road, Shanghai, China  
TEL: 86-21-34771123

**TIANJIN (Tianjin LG Hausys New Building Material Co. Ltd)**  
12, Quanta Road. Wuqing DEV AREA. TianJin Hitech Industry Zone, TianJin, China  
TEL: 86-22-8212-5558

**TAIPEI (TAIPEI OFFICE)**  
2F, NO. 89, Sec. 2, Tiding Ave., Taipei 11493, Taiwan TEL: 886-2-2658-6370

**MOSCOW (LG Hausys RUSSIA, LLC)**  
8th Floor, Lesnaya Plaza, Bld. 4, 4th Lesnoy Pereulok, Moscow, 125047, Russia  
TEL: 7-495-663-3958

**ISTANBUL (LG Hausys Istanbul Office)**  
Buyukdere Cad. Maslak Nurol Plaza No:255A Blok 8.Kat 34398 Maslak, Istanbul Turkey  
TEL: 90-212-285-1101

**NEW DELHI (New Delhi Office)**  
3rd Floor, Tower B, DLF Building No. 10 Phase II,DLF Cyber City Gurgaon-122002, Haryana  
TEL: 91-124-4692600

**BANGKOK (Bangkok Office)**  
19th Floor, Sermit Tower, 159 Asoke, Sukhumvit 21 Rd, Bangkok 10110, Thailand  
TEL: 66-2-665-7417-8

**SINGAPORE (Singapore Office)**  
No 8 Temasek Boulevard #27-01 Suntec Tower 3 Singapore 038988 TEL: 65-6333-6090

**TOKYO (Tokyo Office)**  
Higashikan 16F, Akasaka Twin-Tower 17-22, 2- Chome, Akasaka, Minato-ku, Tokyo, Japan 107-8470  
TEL: 81-3-3584-6545

**JAKARTA (Jakarta Office)**  
Jakarta Stock Exchange Building Tower 1, 15th Flr, Suite #1502 Jl.Jend Sudirman Kav.  
52-53 Jakarta 12190-Indonesia TEL: 62-21-515-1714

**SAO PAULO (Sao Paulo Office)**  
Av.Dr.Chucri Zaidan, 940-Torrell-180 Andar Vila Cordeiro-CEP  
04583-110-Sao Paulo/SP- Brazil TEL: 55-11-2159-7105

MEDISTEP WALL



Sheet



MEDISTEP WALL

Hospital, Patient Room, Emergency Room,  
Education, Preschool, Corridor



Sheet





WAL2005-01/WAL2006-01

Hospital 



Kindergarden 

# MEDISTEP WALL



Hospital



Corridor



Kindergarden

## Construction

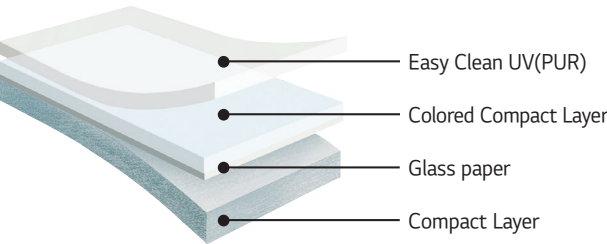

## Description



## Feature



**Superior dimensional stability**  
High resistance to heat and humidity due to glass paper inlaid structure



**Low maintenance cost and anti-bacterial**  
Easy maintenance with specially treated PUR and Superior resistance to outer contaminants and bacteria



**Strong resistance to scratch**  
Not easily worn out against heavy traffic

Size : 1.0mm X 2,000mm X 40M/Roll

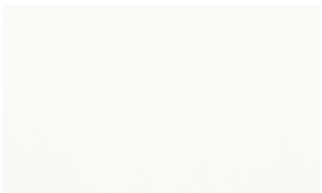

WAL2001-01



WAL2010-01



WAL2002-01

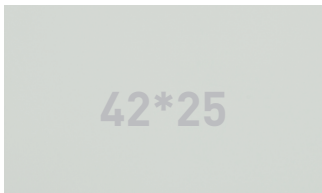

WAL2008-01

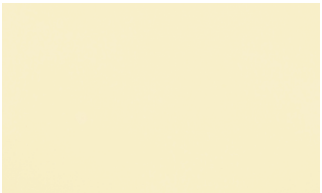

WAL2003-01

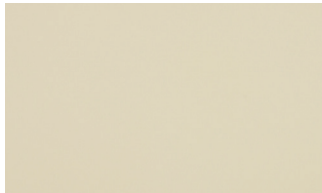

WAL2007-01



WAL2005-01

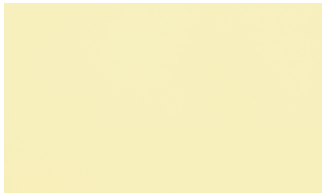

WAL2006-01

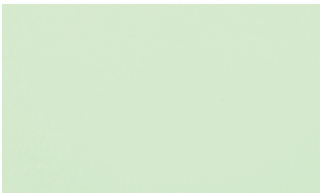

WAL2009-01

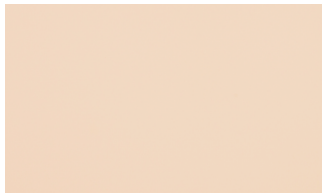

WAL2004-01





# Medistep Wall Installation Guide

## PREPARATION

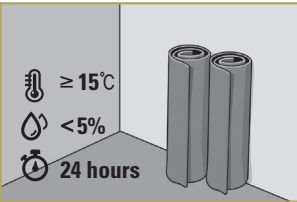

Conditions required before and during the installation

**Conditions Required:**

- Store the sheets for at least 24 hours before installation at the construction site.
- Maintain the room temperature of minimum 15°C prior and throughout the installation.
- Moisture content of the substrate(wall) should be less than 5%.
- Store the rolls upright.
- Before installation, make sure the substrate(wall) is dry, sound, clean and flat.
- There should be no exposure to moisture.
- Cut the wall coverings into required sizes before installation.
- Do not step on the product with shoes on.
- Make sure the substrate(wall) is flat and hard and if necessary, restore the flatness of the wall.

## DIRECTION OF INSTALLATION

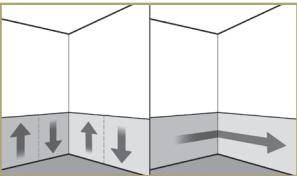

- Medistep Wall can be installed both horizontally and vertically.
- Sheets should be installed in reverse direction.
- Make sure that more than 2 people are involved in installation.

## INSTALLATION

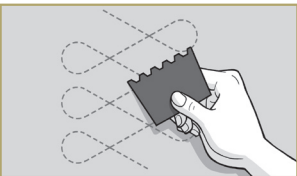

- 1 Cut the sheet into a size 5-10cm larger than the wall size.
- 2 Use an acrylic adhesive emulsion. Follow the adhesive manufacturer's instructions.
- 3 Apply the adhesive thoroughly on the wall using a toothed spatula. (A spatula with small size tooth is recommended)
- 4 Make sure to follow open time instructions(open time may vary according to the environment).



- 5 After the adhesive open time, install the first sheet on the wall.
- 6 As soon as the wall covering is in position, use a spatula to remove air pocket to the edge of the sheet.

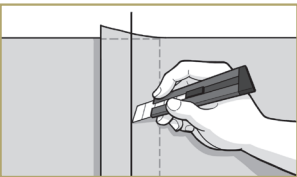

- 7 When installing the second sheet, make sure to overlap the sheet on the first one by minimum 5cm.
- 8 With a utility knife and a ruler, cut the overlapping sheets to make the seam tightly fit edge to edge.

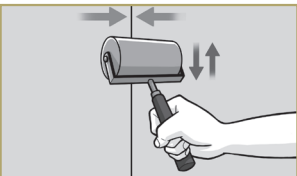

- 9 Remove the adhesive and other residues and roll with a hand roller to flatten the ridges.
- 10 When applying coving, cut the wall covering to the right size.

## POST INSTALLATION GUIDE

**Immediately after installation:**

- After installation, inspect the wall to ensure that there is no adhesive residues remaining. Use methylated spirits and a clean cloth if necessary.

**For any further building work:**

- Wait 48 to 72 hours after installation before carrying out any work on the wall covering.
- Use a protective film if necessary and avoid sticking any type of adhesive tape directly on to the wall covering.

## MAINTENANCE GUIDE

**Daily Maintenance:**

- Clean with a damp cloth or sponge using a neutral detergent following the manufacturer's instructions.

**Periodic Maintenance:**

- Use a wet soft bristle brush with diluted alkaline detergent to clean the wall coverings. Follow the detergent manufacturer's instructions.
- Apply disinfectants, degreasing and descaling agents when required.

## TECHNICAL DATA



Standard	Characteristic	Unit	Result
	Surface Treatment		Easy Clean UV(PUR)
	Format		Sheet
	Roll Length	m	40
	Width	ISO 24344(EN 426)	mm 2,000
	Thickness	ISO 24346(EN 428)	mm 1.0
	Weight	ISO 23997(EN 430)	g/m² 1,394
	Residual Indentation	ISO 24343-1(EN 433)	mm <0.1
	Dimensional Stability	ISO 23999(EN 434)	% <0.5
	Color fastness to light	ISO105-B02	- >6
	Chemical Resistance	ISO 26987(EN 423)	- Fulfilled
	Reaction to Fire	EN 13501-1	- Bfl-s1
	Wear Resistance	EN 660-2	- Group T
	Castor Chair Test	ISO 4918(EN 425)	- Fulfilled
	Flexibility	EN 435	- Fulfilled

## DESIGN APPLICATION

