

# 三通球阀

## Three way ball valve

### 手动球阀尺寸图

#### Manual ball valve Dimension

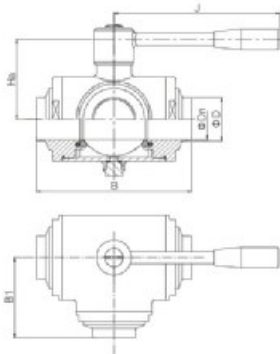

焊接式 Welding  
NO.VQC200S1

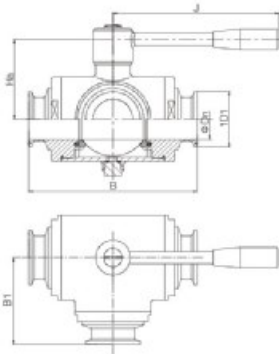

卡箍式 Clamp  
NO.VQC210S1

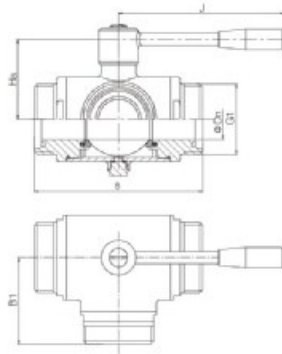

DIN螺纹式 DIN threaded  
NO.DIN-VQC230S1

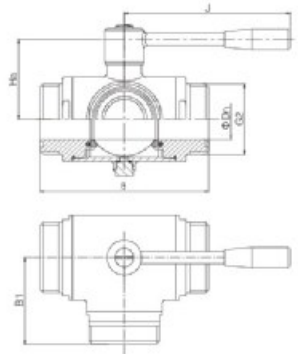

SMS螺纹式 SMS threaded  
NO.SMS-VQC230S1

#### DIN三通 Three links ball valve

| Size  | Dn  | D   | D1   | B   | B 1 | Ha  | J     | 螺纹G1(DIN)    |
|-------|-----|-----|------|-----|-----|-----|-------|--------------|
| DN10  | 9.7 | 13  | 34   | 136 | 68  | 73  | 126.5 | Rd28 × 1/8"  |
| DN15  | 16  | 19  | 34   | 136 | 68  | 73  | 126.5 | Rd34 × 1/8"  |
| DN20  | 19  | 22  | 34   | 136 | 68  | 73  | 126.5 | Rd44 × 1/6"  |
| DN25  | 25  | 28  | 50.5 | 136 | 68  | 73  | 126.5 | Rd52 × 1/6"  |
| DN32  | 31  | 34  | 50.5 | 138 | 71  | 74  | 126.5 | Rd58 × 1/6"  |
| DN40  | 37  | 40  | 50.5 | 156 | 80  | 87  | 164.5 | Rd65 × 1/6"  |
| DN50  | 49  | 52  | 64   | 170 | 90  | 91  | 164.5 | Rd78 × 1/6"  |
| DN65  | 66  | 70  | 91   | 204 | 102 | 113 | 184.5 | Rd95 × 1/6"  |
| DN80  | 81  | 85  | 106  | 226 | 118 | 124 | 233   | Rd110 × 1/4" |
| DN100 | 100 | 104 | 119  | 264 | 142 | 137 | 233   | Rd130 × 1/4" |

#### INCH三通 Three links ball valve

| Size   | Dn   | D     | D1   | B   | B 1 | Ha  | J     | 螺纹G2(SMS)    |
|--------|------|-------|------|-----|-----|-----|-------|--------------|
| 1/2"   | 9.7  | 12.7  | 25.4 | 136 | 68  | 73  | 126.5 | -            |
| 3/4"   | 16.1 | 19.1  | 25.4 | 136 | 68  | 73  | 126.5 | Rd36 × 1/8"  |
| 1"     | 22.4 | 25.4  | 50.5 | 136 | 68  | 73  | 126.5 | Rd40 × 1/6"  |
| 1 1/4" | 28.8 | 31.8  | 50.5 | 138 | 71  | 74  | 126.5 | Rd48 × 1/6"  |
| 1 1/2" | 35.1 | 38.1  | 50.5 | 156 | 80  | 87  | 164.5 | Rd60 × 1/6"  |
| 2"     | 47.8 | 50.8  | 64   | 170 | 90  | 91  | 164.5 | Rd70 × 1/6"  |
| 2 1/2" | 59.5 | 63.5  | 77.5 | 194 | 102 | 102 | 184.5 | Rd85 × 1/6"  |
| 3"     | 72.2 | 76.2  | 91   | 220 | 118 | 120 | 184.5 | Rd98 × 1/6"  |
| 4"     | 97.6 | 101.6 | 119  | 264 | 142 | 137 | 233   | Rd125 × 1/4" |

# 工业级阀门 Industrial valve

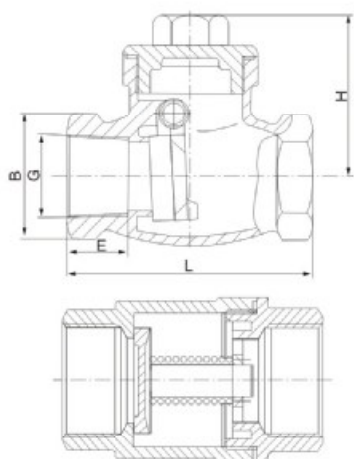

内螺纹止回阀  
Female Check Valve

| DN | G      | L   | E  | B  | H  |
|----|--------|-----|----|----|----|
| 8  | 1/4"   | 64  | 10 | 24 | 42 |
| 10 | 3/8"   | 64  | 10 | 24 | 42 |
| 15 | 1/2"   | 64  | 12 | 26 | 45 |
| 20 | 3/4"   | 80  | 17 | 32 | 53 |
| 25 | 1"     | 90  | 20 | 40 | 60 |
| 32 | 1 1/4" | 105 | 20 | 51 | 64 |
| 40 | 1 1/2" | 120 | 20 | 58 | 76 |
| 50 | 2"     | 140 | 23 | 69 | 82 |
| 65 | 2 1/2" | 165 | 27 | 86 | 89 |

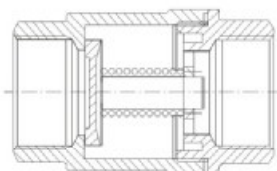

旋启式法兰止回阀  
Flange Swing Check Valve

| DN  | PN16<br>Class<br>150/10k |     |     |     |     |    |       |     |       |     |      |       |     |     |     |    |       |
|-----|--------------------------|-----|-----|-----|-----|----|-------|-----|-------|-----|------|-------|-----|-----|-----|----|-------|
|     | L                        |     | D   | K   | D1  | C  | N-φ   | D   | K     | D1  | C    | N-φ   | D   | K   | D1  | C  | N-φ   |
| 25  | 160                      | 127 | 115 | 85  | 65  | 14 | 4-14  | 108 | 79.5  | 51  | 12   | 4-15  | 125 | 90  | 70  | 14 | 4-19  |
| 32  | 180                      | 140 | 135 | 100 | 78  | 16 | 4-18  | 117 | 89    | 64  | 13   | 4-15  | 135 | 100 | 80  | 16 | 4-19  |
| 40  | 200                      | 165 | 145 | 110 | 85  | 16 | 4-18  | 127 | 98.5  | 73  | 14.5 | 4-15  | 140 | 105 | 85  | 16 | 4-19  |
| 50  | 230                      | 203 | 180 | 125 | 100 | 16 | 4-18  | 152 | 120.5 | 92  | 16   | 4-19  | 155 | 120 | 100 | 16 | 4-19  |
| 65  | 290                      | 216 | 180 | 145 | 120 | 18 | 4-18  | 178 | 139.5 | 105 | 17.5 | 4-19  | 175 | 140 | 120 | 18 | 4-19  |
| 80  | 310                      | 241 | 195 | 160 | 135 | 20 | 8-18  | 190 | 152.5 | 127 | 19   | 4-19  | 185 | 150 | 130 | 18 | 8-19  |
| 100 | 350                      | 292 | 215 | 180 | 155 | 20 | 8-18  | 229 | 190.5 | 157 | 24   | 8-19  | 210 | 175 | 155 | 18 | 8-19  |
| 125 | 400                      | 330 | 245 | 210 | 185 | 22 | 8-18  | 254 | 216   | 186 | 24   | 8-23  | 250 | 210 | 185 | 20 | 8-23  |
| 150 | 480                      | 356 | 280 | 240 | 210 | 24 | 8-23  | 279 | 241.5 | 216 | 25.4 | 8-23  | 280 | 240 | 215 | 22 | 8-23  |
| 200 | 550                      | 495 | 335 | 295 | 265 | 26 | 12-23 | 343 | 298.5 | 270 | 29   | 8-23  | 330 | 290 | 265 | 22 | 12-23 |
| 250 | 560                      | 622 | 405 | 355 | 320 | 30 | 12-25 | 406 | 362   | 324 | 30.5 | 12-25 | 400 | 355 | 325 | 24 | 12-25 |
| 300 | 750                      | 698 | 460 | 410 | 375 | 30 | 12-25 | 483 | 431.8 | 381 | 32   | 12-25 | 445 | 400 | 370 | 24 | 16-25 |

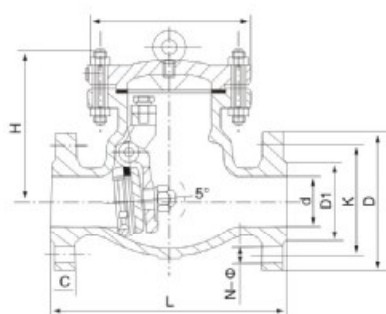

内螺纹三通球阀  
Female Three Way Ball Valve

| DN | G      | d   | L  | H   | W   |
|----|--------|-----|----|-----|-----|
| 8  | 1/4"   | 74  | 10 | 58  | 110 |
| 10 | 3/8"   | 74  | 12 | 58  | 110 |
| 15 | 1/2"   | 74  | 12 | 58  | 110 |
| 20 | 3/4"   | 88  | 15 | 60  | 120 |
| 25 | 1"     | 92  | 20 | 70  | 140 |
| 32 | 1 1/4" | 124 | 25 | 82  | 140 |
| 40 | 1 1/2" | 138 | 32 | 95  | 180 |
| 50 | 2"     | 154 | 38 | 100 | 200 |

