

Ball Valve, Metal

Construction

The GEMÜ 707 manually operated 2-piece 2/2-way ball valve in stainless steel has a plastic coated lever.

Features

- Suitable for inert and corrosive* liquid and gaseous media and steam
- The GEMÜ 707 ball valves comply with the safety requirements of Annex I of the European Pressure Equipment Directive 2014/68/EU (PED) for fluids of group 1 and 2

Advantages

- High flow capability
- Low weight
- Lockable and non-twisting lever

* see information on working medium on page 2

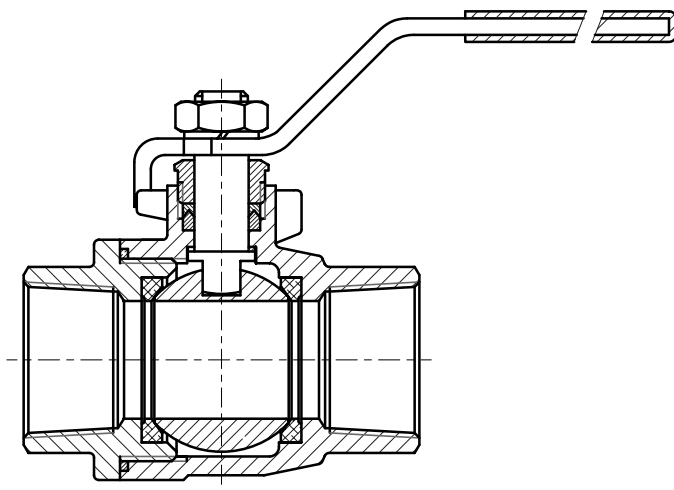

Technical data

Working medium

Corrosive, inert gaseous and liquid media and steam which have no negative impact on the physical and chemical properties of the body and seal materials.

Maximum permissible pressure of working medium see diagram

(for water and non-hazardous media to which the body material is resistant)

Maximum permissible operating temperature 180 °C

Maximum permissible ambient temperature 60 °C

DN	NPS	Values		Weight	
		Kv [m³/h]	Cv [US gal/min]	[kg]	[US-lbs]
8	1/4"	8.6	37.9	0.25	0.14
10	3/8"	21	92.5	0.25	0.14
15	1/2"	35	154.1	0.40	0.23
20	3/4"	46	202.5	0.50	0.29
25	1"	72	317.0	0.90	0.51
32	1 1/4"	105	462.3	1.60	0.92
40	1 1/2"	170	748.5	2.30	1.32
50	2"	275	1210.8	3.60	2.06
65	2 1/2"	272	1197.6	6.50	1.32

Operating pressure - Temperature

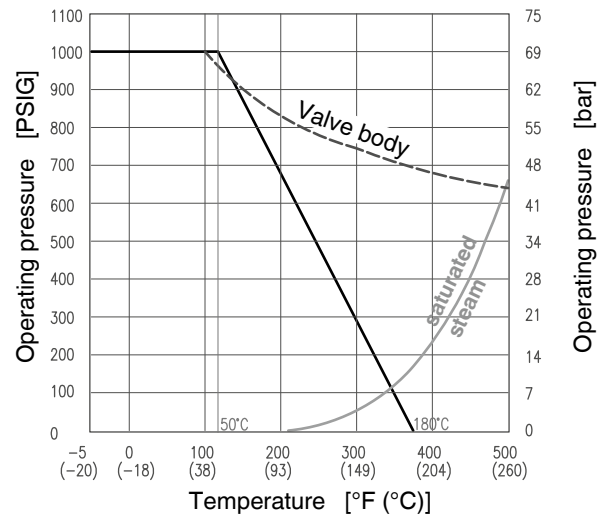

Data shown are typical non-binding values only!
The manufacturer assumes no liability whatsoever for any data selection not confirmed in writing.

Relief bore hole



Order data

Body configuration	Code
2/2-way	D

Seal material	Code
Seat: PTFE	5

Connection	Code
Threaded sockets DIN ISO 228	1
Threaded sockets NPT ANSI B1.20.1	31

Control function	Code
Manually operated / lockable	L

Valve body material	Code
1.4408 Investment casting (body)	37
1.4401 Ball	

Order example	707	15	D	1	37	5	L
Type	707						
Nominal size		15					
Body configuration (code)			D				
Connection (code)				1			
Valve body material (code)					37		
Seal material (code)						5	
Control function (code)							L

Body dimensions [mm]

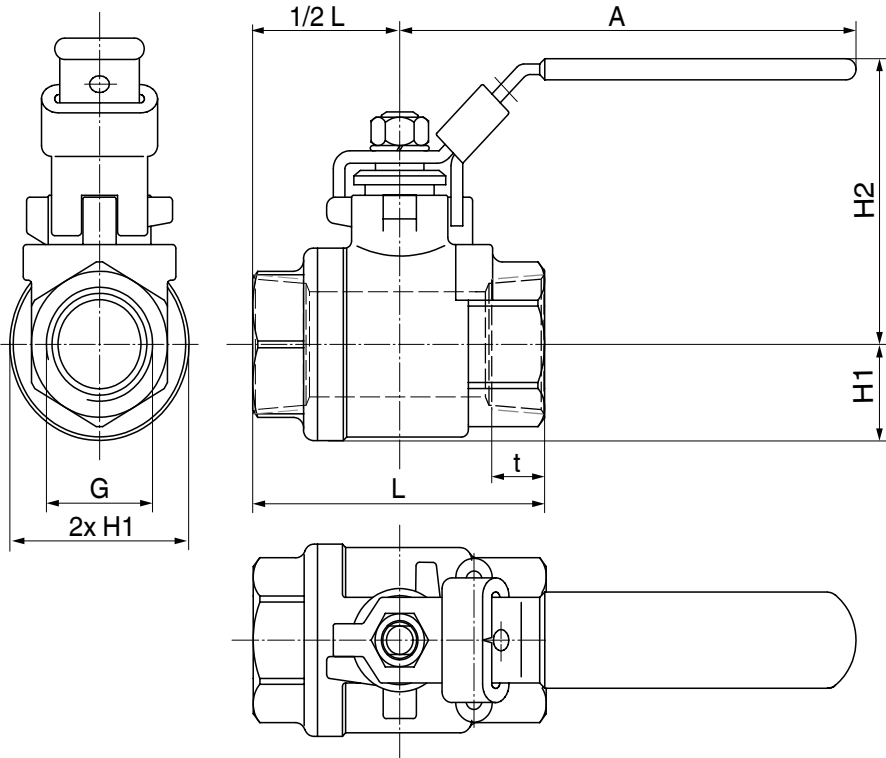

DN	G	A	H1	H2	L	t
8	1/4"	100	15.5	50	60	13
10	3/8"	100	15.5	50	60	13
15	1/2"	130	18.5	60	75	15
20	3/4"	130	21.5	64	80	17
25	1"	165	26.0	71	90	19
32	1 1/4"	165	31.4	78	110	22
40	1 1/2"	190	36.0	86	120	22
50	2"	190	44.5	95	140	26
65	2 1/2"	250	68.0	130	161	31

For further ball valves and other products please see our Product Range catalogue and Price List.
Contact GEMÜ.

GEMÜ® VALVES, MEASUREMENT
AND CONTROL SYSTEMS

