

# 固定式清洗球

## Fixed cleaning ball

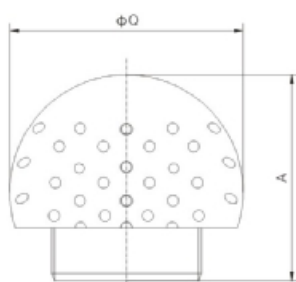

NO.EQX313

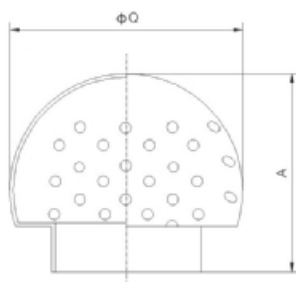

NO.EQX310

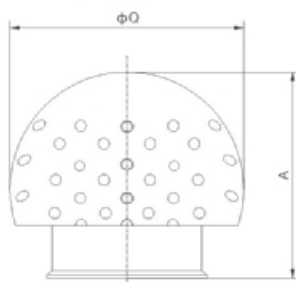

NO.EQX311

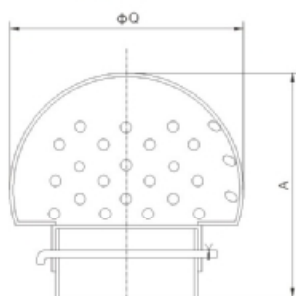

NO.EQX315

### 应用 Applications

- ◆固定清洗球:360度全部喷射、180度喷射、喷射孔径25mm。
- ◆Fixed cleaning ball:360 degree spray completely 180 degree spray aperlure of spray is 2.5mm.

### 螺纹式 Threaded

SIZE	Q	A	压力(bar) Pressure	喷射半径(m) Spray radius	流量(m <sup>3</sup> /h) Flow rate (360° /180° )
1"	63	72	2.5	1.0-1.25	17/10
1.25"	76	85	2.5	1.25-1.75	23/17
1.5"	76	85	2.5	1.25-1.75	23/17
2"	76	87	3.5	2.0-3.0	55/38
2.5"	91	102	3.5	3.0-3.5	58/41

### 焊接式 Welded

SIZE	Q	A	压力(bar) Pressure	喷射半径(m) Spray radius	流量(m <sup>3</sup> /h) Flow rate (360° /180° )
1"	53	72	2.5	1.0-1.25	17/10
1.5"	63	85	2.5	1.25-1.75	23/17
2"	91	87	3.5	2.0-3.0	55/38
2.5"	100	102	3.5	3.0-3.5	58/41

### 卡箍式 Clamped

SIZE	Q	A	压力(bar) Pressure	喷射半径(m) Spray radius	流量(m <sup>3</sup> /h) Flow rate (360° /180° )
1"	63	80	2.5	1.0-1.25	17/10
1.25"	76	93	2.5	1.25-1.75	23/17
1.5"	76	93	2.5	1.25-1.75	23/17
2"	91	108	3.5	2.0-3.0	55/38
2.5"	100	115	3.5	3.0-3.5	58/41

### 插销式 Bolted

SIZE	Q	A	压力(bar) Pressure	喷射半径(m) Spray radius	流量(m <sup>3</sup> /h) Flow rate (360° /180° )
1"	63	72	2.5	1.0-1.25	17/10
1.5"	76	85	2.5	1.25-1.75	23/17
2"	91	87	3.5	2.0-3.0	55/38
2.5"	100	102	3.5	3.0-3.5	58/41