

RELY ON EXCELLENCE

## HSH(L)U-D

Mechanical seals | Agitator seals | Liquid-lubricated seals



### Features

- For bottom entry drives
- Double seal
- Balanced
- Independent of direction of rotation
- Multiple springs rotating
- Liquid-lubricated
- Cartridge unit

### Advantages

- Ready-to-fit and factory-tested unit
- With or without bearing available
- Patented hydrodynamic grooves
- High pressure seal for customer-specific solutions
- Floating throttle on product side for protection of the seal or for flush
- Connection dimensions to customers' requirements
- Self-closing on product side
- ATEX certification on request

### Operating range

Shaft diameter:

d1 = ... 500 mm ( ... 19.69")

Pressure: p1 = vacuum ... 60 bar (870 PSI)

Temperature:

t1 = -40 °C ... +200 °C (-40 °F ... +392 °F)

Sliding velocity:

vg = 0 ... 5 m/s (0 ... 16 ft/s)

For applications beyond this range, please inquire.

! It should be noted that the extremal values of each operating parameter cannot be applied at the same time because of their interaction.

### Materials

Seal faces: Carbon graphite

Seats: Silicon carbide, FDA conform

Secondary seals and metallic parts acc. to application and customers' requirement.

### Standards and approvals

- FDA

### Notes

Options:

- Cooling resp. heating flange
- Flush
- Shut-down seal

### Recommended applications

- Refining technology
- Petrochemical industry
- Chemical industry
- Pharmaceutical industry
- Agitators
- Reactors
- Dryers
- Mixers
- Filters
- Special rotating equipment with bottom entry drive

### Recommended piping plans

Open circuit

e.g. EagleBurgmann SPA, EagleBurgmann SPN

Product links:

[EagleBurgmann SPA](#)

[EagleBurgmann SPN manual](#)

[EagleBurgmann SPN automatic](#)

## RELY ON EXCELLENCE

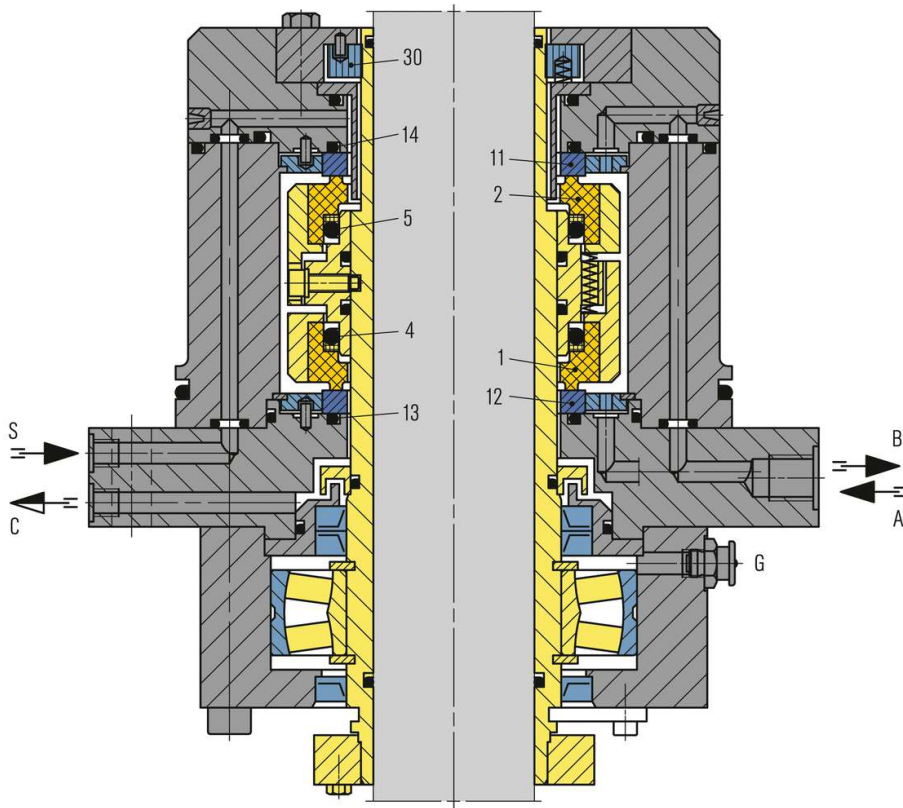

Item no.	Description
1	Seal face, atmosphere side
2	Seal face, product side
4, 5, 13, 14	O-Ring
11	Seat, product side
12	Seat, atmosphere side
30	Throttle ring

## RELY ON EXCELLENCE

### Installation, details, options

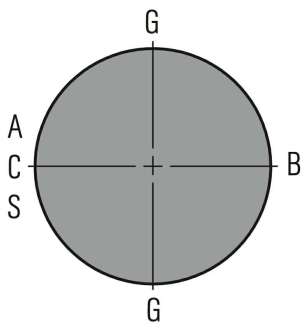

#### Supply connections

A Barrier fluid IN  
B Barrier fluid OUT  
C Drainage  
G Grease  
S Flush

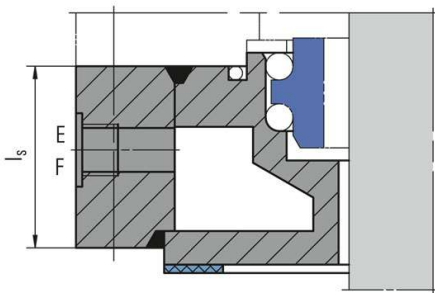

#### Cooling flange

Can be used alternatively as a heating flange.

#### Flush

