

# KTL Type

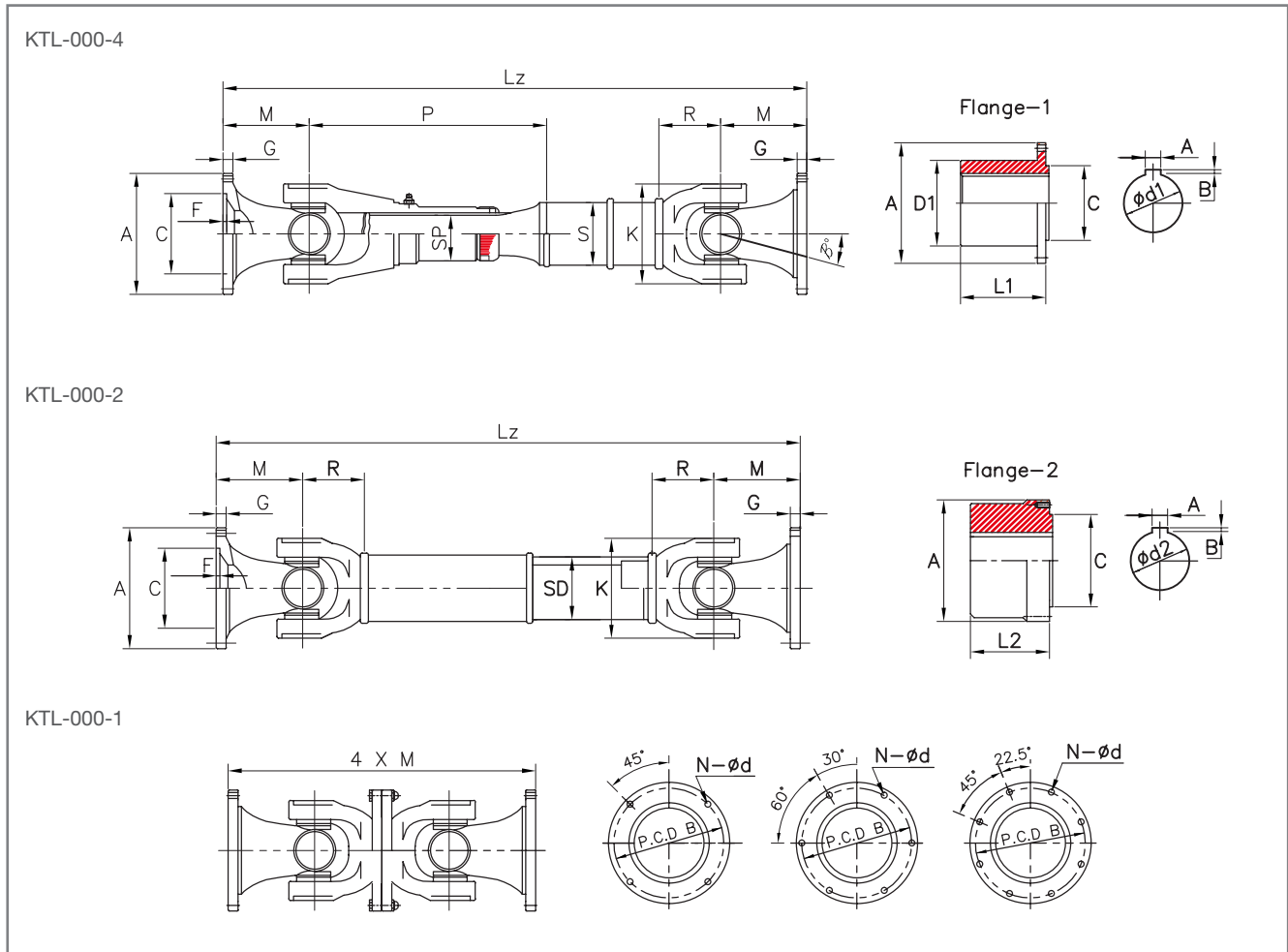

Size	Din	Torque		Angle	Dimensions (Millimeters)														Length	Spline Stroke		Flange						Bolt Size
		TDW (Kgf.m)	TK (Kgf.m)		B°	A	B PCD	øC H7	F	G	M	P	R	SP	ØS	ØK	N	Ød		LZ Min	+	-	1			2		
				ød1															øD				L1	ød2	L2			
58	373.20	11	15	30°	58	47.0	30	1.5	3.5	32.0	127	36.0	21.0	32.0	52	4	5	250	14	14	20	35	30	35	56	M5 x 14L		
65	373.20	15	25	30°	65	52.0	35	2.0	4.5	35.5	142	36.0	21.0	32.0	60	4	6	250	14	14	25	40	40	40	63	M6 x 18L		
75	273.30	40	55	30°	75	62.0	42	2.0	5.5	45.0	169	45.0	33.0	50.8	70	4	6	310	20	15	30	50	48	45	70	M6 X 20I		
90	287.00	70	90	25°	90	74.5	47	2.5	6	50.0	180	42.5	35.0	50.8	96	4	8	375	25	15	35	55	55	55	90	M8 x 25L		
100	287.10	95	125	25°	100	84.0	57	2.5	7	50.0	180	42.5	35.0	63.5	96	6	8	410	30	15	40	64	63	60	90	M8 x 25L		
120	287.20	150	185	20°	120	101.5	75	2.5	8.5	80.0	300	55.0	42.0	76.3	115	8	10	500	35	20	50	80	80	70	110	M10 x 30L		
150	287.30	350	480	20°	150	130.0	90	3.0	10	80.0	300	75.0	54.0	90.0	142	8	12	580	40	20	60	105	90	90	140	M12 x 40L		
160	287.30	350	480	20°	160	140.0	100	4.0	10	80.0	300	75.0	54.0	90.0	142	8	12	600	40	26	70	115	110	95	160	M12 x 40L		
180	287.40	520	670	22°	180	155.5	110	3.0	12	80.0	300	80.0	63.5	101.6	182	8	14	600	45	33	80	125	125	110	180	M14 x 45L		
200	287.40	520	670	22°	200	175.0	125	5.0	14	116.0	355	102.0	60.0	101.6	185	8	14	660	45	33	85	130	140	120	180	M14 x 45L		
225	287.40	900	1170	22°	225	196.0	140	5.0	15	108.0	450	115.0	82.0	120.0	205	8	16	730	50	40	100	160	160	135	220	M16 x 50L		

\* Coupling Weight is without Bore Machining