

KLS Type

Spindle

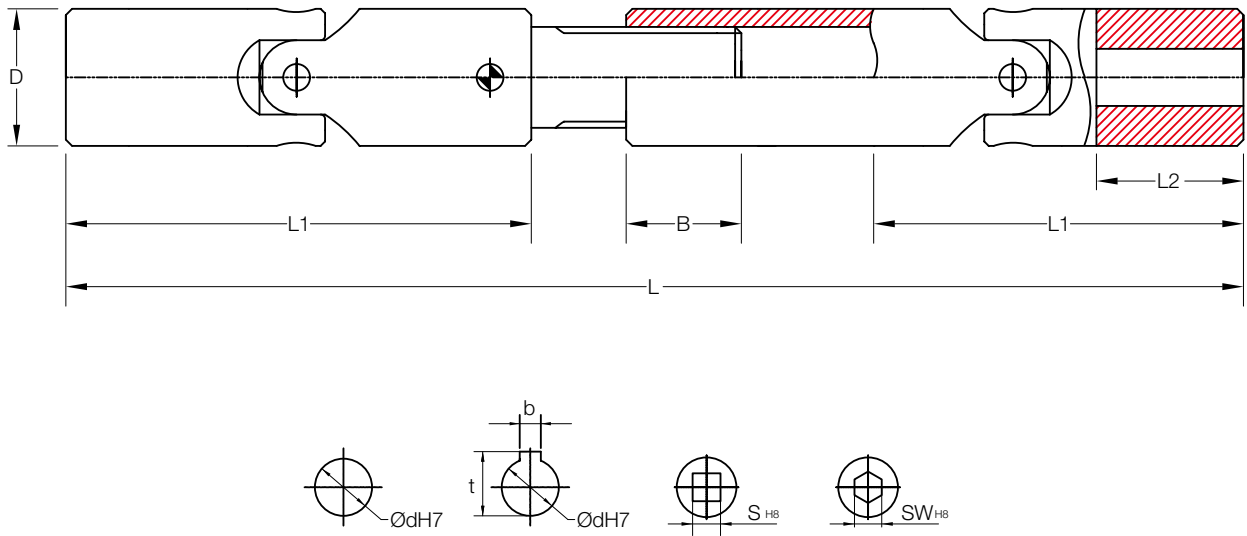

Size	Dimensions (Millimeters)							
	dH7	D	L1	L2	B	S	SW	BXT
203	10	22	45	10	40	10	10	3 x 11.4
204	12	25	50	11	45	12	12	4 x 13.8
205	14	29	56	13	48	14	14	5 x 16.3
206	16	32	65	15	50	16	16	5 x 18.3
207	18	37	72	17	51	18	18	6 x 20.8
208	20	40	82	19	56	20	20	6 x 22.8
209	22	47	95	22	60	22	22	6 x 24.8
210	25	50	108	27	69	25	25	8 x 28.3
211	30	58	122	30	70	30	30	8 x 33.8
212	35	70	140	35	70	35	35	10 x 38.3
213	40	80	160	42	75	40	40	12 x 43.3
214	50	95	190	54	80	50	50	14 x 53.8

* Coupling Weight is without Bore Machining