

# KW31 Type

## Full Spacer

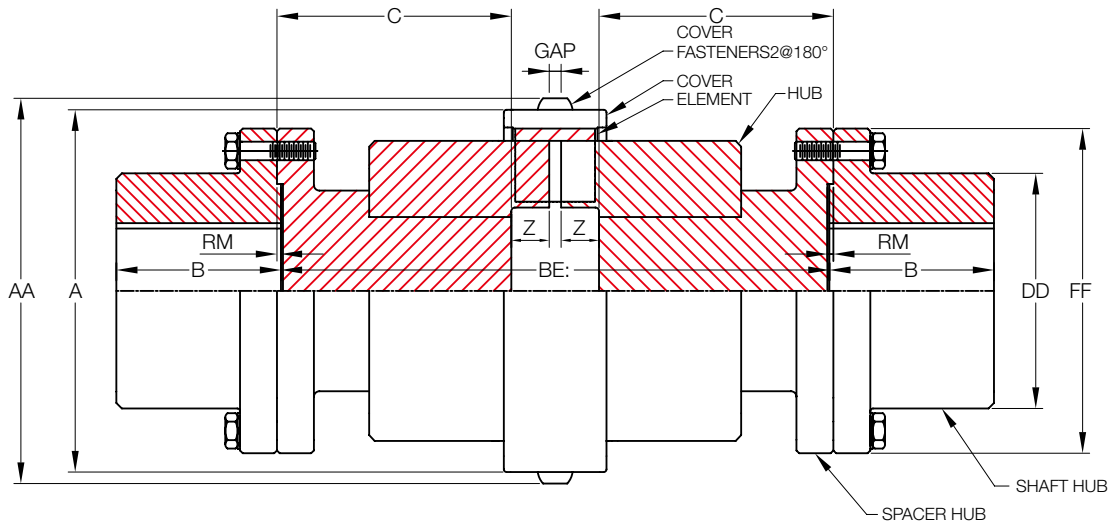

Size	Torque Rating (Nm)	Allow Speed RPM	Max Bore (mm)	Cplg Wt (Kg)		Dimensions (Millimeters)														Cover Fasteners		Flange Fasteners		T-Shaft Hub
				Min BE (Kg)	Add BE (Kg)	Distance Between Shaft Ends (BE) = 2(C) + 2(Z) + GAP - 2(RM)														Size	Allen Wrench	Size	Per Flange	
						Max	Min	Nylon	Steel	Nylon	Steel	B	BDD	FF	RM	S	Z	GAP						
5	62	4,500	35	3.63	0.014	235	80.9	76.5	76.5	80.5	80.4	34.9	52.4	86	1.27	27.4	8.9	2	M4	M2.5	M6	4	1020T	
10	130	4,500	43	4.99	0.015	254	88.9	90.4	90.4	94.5	94.4	41.3	59.5	94	1.27	31.5	10.9	2	M4	M2.5	M6	8	1030T	
20	316	4,500	56	9.53	0.027	254	88.9	126.0	124.0	132.0	130.0	54.0	78.6	113	1.27	27.4	15.0	2	M6	M4	M6	8	1040T	
30	520	4,500	67	14.10	0.034	254	111.0	146.6	143.0	153.0	149.0	60.3	87.3	126	1.27	40.6	17.0	2	M6	M4	M8	8	1050T	
40	1,028	3,600	85	25.90	0.040	311	127.0	182.1	177.0	190.0	185.0	79.4	109.5	153	1.27	46.7	21.1	5	M8	M5	M10	12	1070T	
50	2,508	3,000	95	45.40	0.059	311	165.0	230.9	224.0	239.0	232.0	88.9	122.2	178	1.27	49.8	27.9	5	M8	M5	M12	12	1080T	
60	4,011	2,500	110	72.60	0.082	311	200.0	-	267.0	-	278.0	101.6	142.9	210	1.27	-	35.3	5	M10	M6	M16	12	1090T	
70	8,011	2,100	130	102.00	0.117	373	224.0	-	310.0	-	321.0	90.4	171.4	251	1.52	-	39.6	5	M10	M6	M20	12	1100T	
70	8,011	2,100	150	120.00	0.117	373	224.0	-	310.0	-	321.0	104.1	196.8	276	1.52	-	39.6	5	M10	M6	M20	12	1110T	
80	15,027	1,800	190	230.00	0.240	424	256.0	-	370.0	-	381.0	134.6	238.1	347	2.39	-	45.5	6	M10	M6	M27	12	1130T	

\* Coupling Weight is without Bore Machining