

KW10 Type

Close Coupled

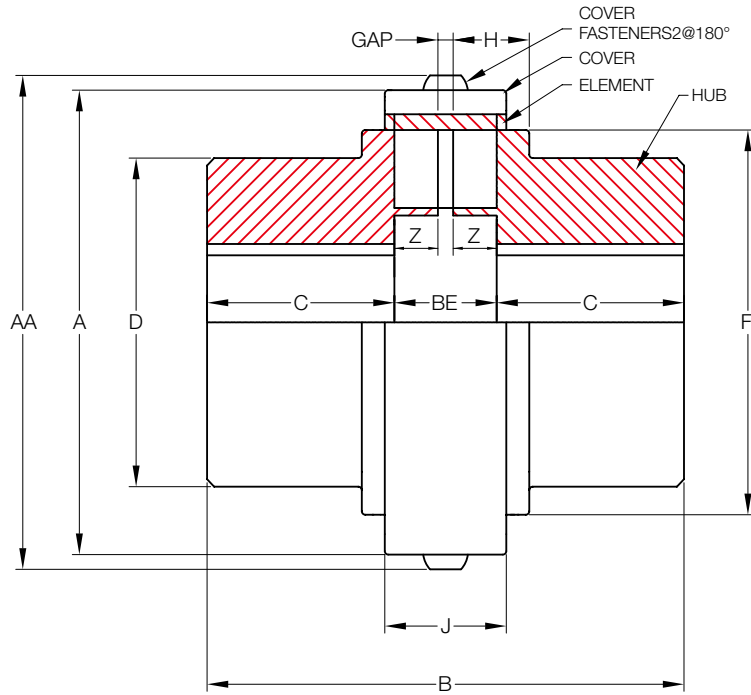

Size	Torque Rating (Nm)	Allow Speed RPM	Max Bore (mm)	Min Bore (mm)	Cplg Wt (Kg)		Dimensions (Millimeters)														Cover Fasteners	
					Nylon Cover	Steel Cover	A		AA		B	BE	C	D	F	H	J	Z	GAP	Size	Allen Wrench	
							Nylon	Steel	Nylon	Steel												
5	62	4,500	38	12.7	1.35	1.49	76.5	76.5	80.5	80.4	71.9	19.8	25.9	59.9	64	15.0	23.1	8.9	2	M4	M2.5	
10	130	4,500	48	15.88	2.49	2.72	90.4	90.4	94.5	94.4	91.9	23.9	34.0	72.1	75.9	19.1	27.9	10.9	2	M4	M2.5	
20	316	4,500	60	19.05	5.64	6.09	126.0	124.0	132.0	130.0	121.9	32.0	45.0	91.9	102.1	24.9	37.1	15.0	2	M6	M4	
30	520	4,500	65	25.40	9.41	10.00	146.6	143.0	153.0	149.0	151.9	36.1	57.9	104.9	118.1	29.0	41.9	17.0	2	M6	M4	
40	1,028	3,600	85	28.58	17.10	18.10	182.1	177.0	190.0	185.0	181.1	47.0	67.1	130.0	150.1	34.0	54.6	21.1	5	M8	M5	
50	2,508	3,000	105	31.75	35.80	37.70	230.9	224.0	239.0	232.0	214.9	60.7	77.0	178.1	190	46.0	69.6	27.9	5	M8	M5	
60	4,011	2,500	135	50.80	-	66.40	-	267.0	-	278.0	275.3	75.4	100.1	209.6	228.1	60.2	67.1	35.3	5	M10	M6	
70	8,011	2,100	160	69.85	-	111.00	-	310.0	-	321.0	324.1	84.1	119.9	251.0	270	69.6	74.9	39.6	5	M10	M6	
80	15,027	1,800	190	85.73	-	166.00	-	370.0	-	381.0	376.9	97.0	140.0	270.0	327.9	83.3	85.1	45.5	6	M10	M6	

* Coupling Weight is without Bore Machining