

KSS Type

Standard Flanged Sleeve Double Engagement

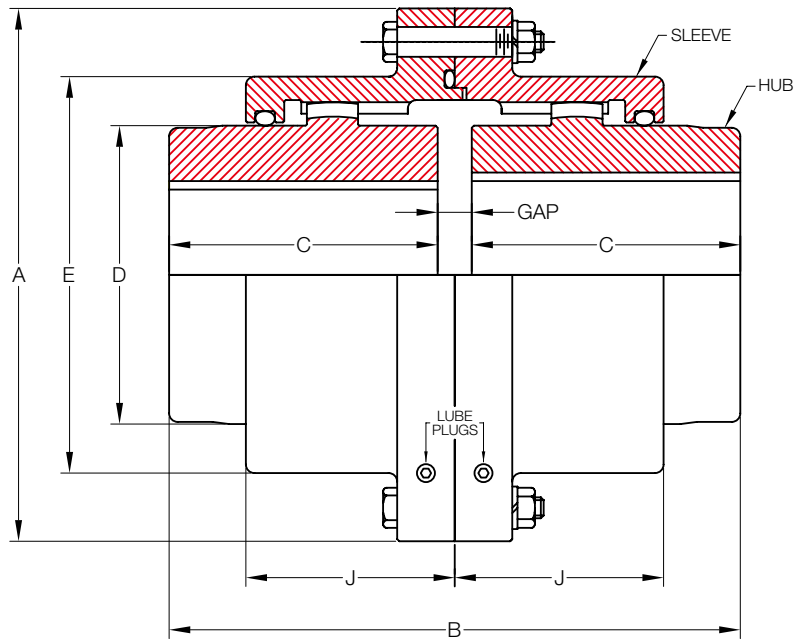

Size	Torque Rating (Nm)	Allow Speed RPM	Max Bore (mm)	Min Bore (mm)	Cplg Weight (Kg)	Lube Weight (Kg)	Dimensions (Millimeters)						KSSH Torque (Nm)	
							A	B	C	D	E	J		GAP
112	560	4,000	40	16	4.3	0.05	112	108	50	58	79	40	8	960
125	1,050	4,000	50	31	6.6	0.06	125	134	63	70	92	43	8	1,650
140	1,510	4,000	56	31	9.3	0.09	140	150	71	80	107	47	8	2,490
160	2,310	4,000	65	31	14.0	0.12	160	170	80	95	120	52	10	3,900
180	3,550	4,000	75	45	19.0	0.15	180	190	90	105	134	56	10	5,940
200	5,060	3,810	85	45	26.0	0.20	200	210	100	120	149	61	10	8,290
224	7,350	3,410	100	51	39.0	0.31	224	236	112	145	174	65	12	14,140
250	9,920	3,050	115	51	55.0	0.45	250	262	125	165	200	74	12	20,450
280	17,170	2,720	135	51	81.0	0.59	280	294	140	190	224	82	14	29,170
315	27,070	2,420	160	112	129.0	0.94	315	356	170	225	260	98	16	38,270
355	39,880	2,150	180	125	177.0	1.11	355	396	190	250	288	108	16	56,450
400	56,000	1,900	200	140	242.0	1.70	400	418	200	285	329	114	18	88,890

* Coupling Weight is without Bore Machining