

KCE Type (Large)

Large Flanged Sleeve Single Engagement

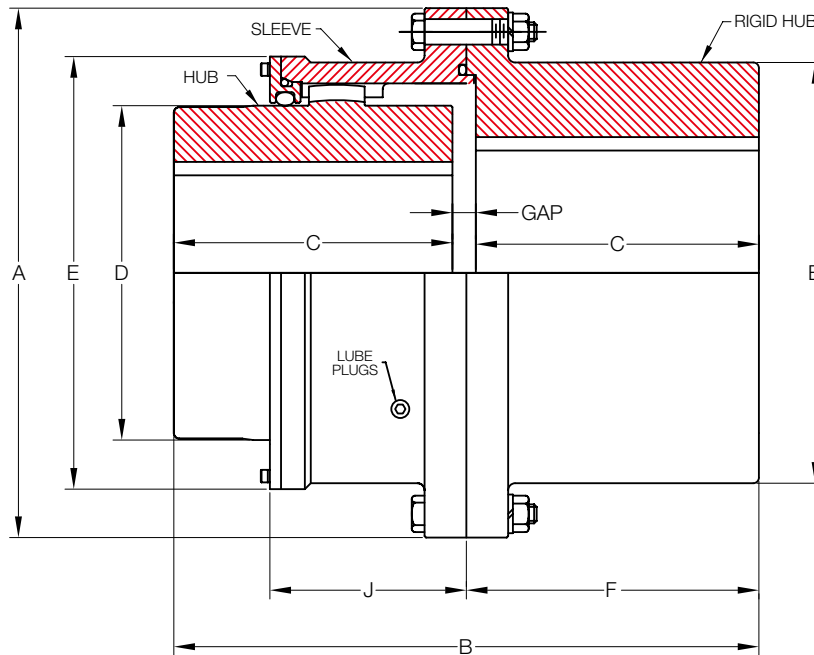

Size	Torque Rating (Nm)	Allow Speed RPM	Max Bore (mm)		Min Bore (mm)	Cplg Weight (Kg)	Lube Weight (Kg)	Dimensions (Millimeters)								KCEH Torque (Nm)
			Flex (mm)	Rigid (mm)				A	B	C	D	E	F	J	GAP	
450	93,100	1,690	205	250	140	304	1.79	450	418	200	290	372	209	151	18	135,240
500	127,400	1,520	236	265	170	458	2.64	500	494	236	335	425	247	168	22	225,400
560	203,840	1,360	275	300	190	664	3.23	560	552	265	385	475	276	187	22	337,120
630	308,700	1,210	325	355	224	1,020	4.93	630	658	315	455	548	329	213	28	458,640
710	449,820	1,070	360	400	250	1,460	6.63	710	738	355	510	622	369	242	28	634,060
800	642,880	950	405	450	280	2,090	9.35	800	832	400	570	690	416	267	32	862,400
900	915,320	840	475	510	315	3,020	11.90	900	932	450	670	792	466	295	32	1,215,200
1000	1,254,400	760	510	570	355	4,130	17.00	1,000	1,040	500	720	858	520	322	40	1,646,400
1120	1,764,000	682	600	640	400	5,970	22.10	1,120	1,160	560	840	990	580	360	40	2,254,000
1250	2,450,000	610	710	800	500	9,820	31.40	1,250	1,460	710	960	1,126	730	399	40	3,067,400

* Coupling Weight is without Bore Machining