

KS4 Type

**Double Disc Flex with Six Bolts
Spacer Type**

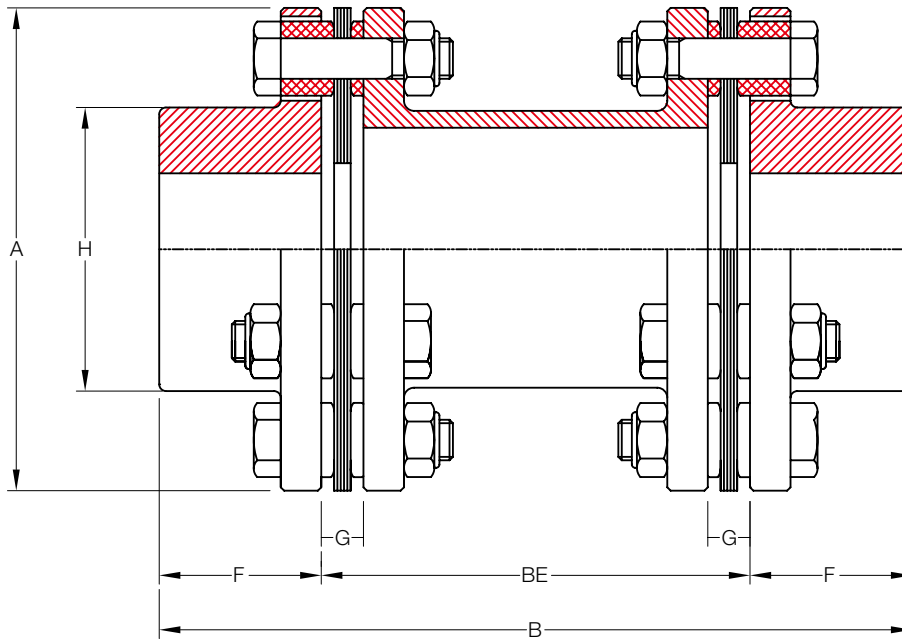

Angular Misalignment = 0.7°
6 Bolt Holes

Size	Torque Rating (Nm)	Allow Speed RPM	Max Bore (mm)	Cplg Weight (Kg)	Shaft Line Displacement (mm)	Bolt Torque (Kg.m)	GD ² (Kg.m ²)	Dimensions (Millimeters)					
								A	B	F	G	H	BE
00	568	26,000	51	6.0	3.0	2.2	0.03	119	168	54	10.3	74	60
01	921	23,000	55	9.1	3.4	4.2	0.06	137	198	63	11.0	81	72
02	1,705	19,000	67	16.9	3.6	7.3	0.14	161	238	74	12.0	97	90
03	3,342	17,000	72	21.6	4.2	15.9	0.26	180	269	80	14.0	104	109
04	4,900	15,000	85	35.1	4.5	22.1	0.59	212	308	95	17.0	124	118
05	6,076	11,600	125	73.3	3.9	22.1	1.80	276	377	112	17.5	180	153
10	8,232	11,600	125	74.3	3.9	22.1	1.90	276	377	112	19.0	180	153
15	10,682	10,300	140	107.8	4.2	45.0	3.70	308	440	134	19.0	200	172
20	17,836	9,200	158	156.1	4.8	58.0	6.70	346	497	153	22.5	228	191
25	26,362	8,500	165	211.8	5.2	110.0	10.60	375	553	165	28.0	240	223
30	33,418	7,800	178	274.5	5.4	150.0	16.50	410	610	178	31.0	258	254
35	39,886	7,200	187	333.3	5.6	170.0	23.90	445	646	188	31.0	272	270
40	46,256	6,800	205	399.2	6.3	170.0	30.70	470	686	206	34.0	297	274
45	59,780	6,200	231	525.3	6.7	170.0	48.00	511	749	231	35.5	334	287
50	74,676	5,700	254	676.3	7.3	310.0	72.90	556	800	254	37.0	364	292
55	92,512	5,400	263	803.4	7.8	360.0	100.60	587	839	264	37.5	382	311

* Coupling Weight is without Bore Machining