

KF3 Type

Single Disc Flex with Four Bolts

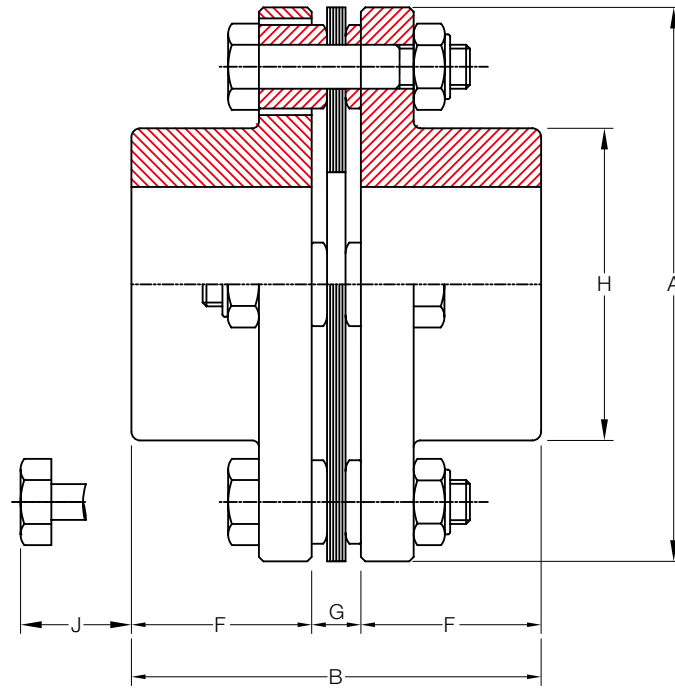

Angular Misalignment = 1.0°
4 Bolt Holes

| Size | Torque Rating (Nm) | Allow Speed RPM | Max Bore (mm) | Cplg Weight (Kg) | Bolt Torque (Kg.m) | GD ² (Kg.m ²) | Dimensions (Millimeters) | | | | | |
|------|--------------------|-----------------|---------------|------------------|--------------------|--------------------------------------|--------------------------|-------|-----|------|-----|----|
| | | | | | | | A | B | F | G | H | J |
| 05 | 33 | 47,000 | 23 | 0.6 | 0.9 | 0.0008 | 67 | 55.8 | 25 | 5.8 | 33 | 16 |
| 10 | 90 | 39,000 | 32 | 1.1 | 0.9 | 0.0024 | 81 | 57.1 | 25 | 7.1 | 46 | 16 |
| 15 | 176 | 34,000 | 35 | 1.7 | 2.2 | 0.0048 | 93 | 66.4 | 29 | 8.4 | 51 | 24 |
| 20 | 245 | 30,000 | 42 | 2.5 | 2.2 | 0.0080 | 104 | 79.0 | 34 | 11.0 | 61 | 30 |
| 25 | 421 | 25,000 | 50 | 4.3 | 4.2 | 0.0224 | 126 | 93.2 | 41 | 11.2 | 71 | 27 |
| 30 | 774 | 22,000 | 58 | 6.9 | 7.3 | 0.0440 | 143 | 108.5 | 48 | 12.5 | 84 | 28 |
| 35 | 1,274 | 19,000 | 74 | 11.3 | 7.3 | 0.1080 | 168 | 130.0 | 57 | 16.0 | 106 | 26 |
| 40 | 2,058 | 16,000 | 83 | 16.7 | 15.9 | 0.2080 | 194 | 145.0 | 64 | 17.0 | 118 | 30 |
| 45 | 3,332 | 15,000 | 95 | 22.7 | 15.9 | 0.3520 | 214 | 174.8 | 76 | 22.8 | 137 | 34 |
| 50 | 4,900 | 13,000 | 109 | 35.4 | 22.1 | 0.7200 | 246 | 202.0 | 89 | 24.0 | 157 | 26 |
| 55 | 6,370 | 11,000 | 118 | 52.0 | 55.3 | 1.2800 | 276 | 230.0 | 102 | 26.0 | 169 | 42 |

* Coupling Weight is without Bore Machining