

## KE4 Type

**Double Disc Flex with Eight Bolts (Spacer Type)**

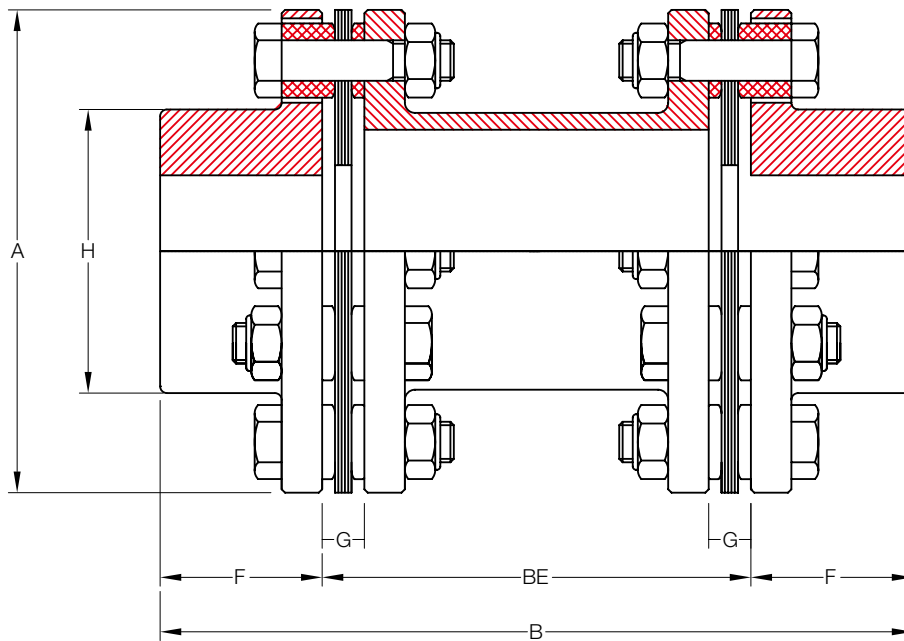

Angular Misalignment = 0.5°  
8 Bolt Holes

Size	Torque Rating (Nm)	Allow Speed RPM	Max Bore (mm)	Cplg Weight (Kg)	Shaft Line Displacement (mm)	Bolt Torque (Kg.m)	GD <sup>2</sup> (Kg.m <sup>2</sup> )	Dimensions (Millimeters)					
								A	B	F	G	H	BE
01	3,842	15,000	95	38.0	2.1	7.3	0.64	214	333	108	12.2	137	117
03	7,115	13,000	115	60.0	2.1	15.9	1.36	246	369	121	13.7	165	127
05	8,967	11,600	125	82.3	2.1	22.1	2.30	276	421	134	17.5	180	153
10	10,780	11,600	125	83.3	2.1	22.1	2.30	276	421	134	19.0	180	153
15	15,386	10,300	140	119.7	2.4	45.0	3.70	308	492	160	19.0	200	172
20	25,578	9,200	158	174.3	2.9	58.0	6.80	346	557	183	22.5	228	191
25	37,730	8,500	165	233.8	3.1	110.0	10.80	375	619	198	28.0	240	223
30	47,138	7,800	178	305.3	3.3	150.0	16.70	410	682	214	31.0	258	254
35	57,036	7,200	187	367.4	3.6	170.0	25.00	445	720	225	31.0	272	270
40	64,386	6,800	205	447.5	4.0	170.0	31.10	470	768	247	34.0	297	274
45	83,594	6,200	231	591.6	4.5	170.0	48.00	511	843	278	35.5	334	287
50	103,194	5,700	254	761.4	5.0	310.0	74.70	556	902	305	37.0	364	292
55	128,086	5,400	263	901.9	5.2	360.0	101.60	587	945	317	37.5	382	311

\* Coupling Weight is without Bore Machining