

K71 Type

Double Disc Flex with Four, Six & Eight Bolts (Spacer Type)

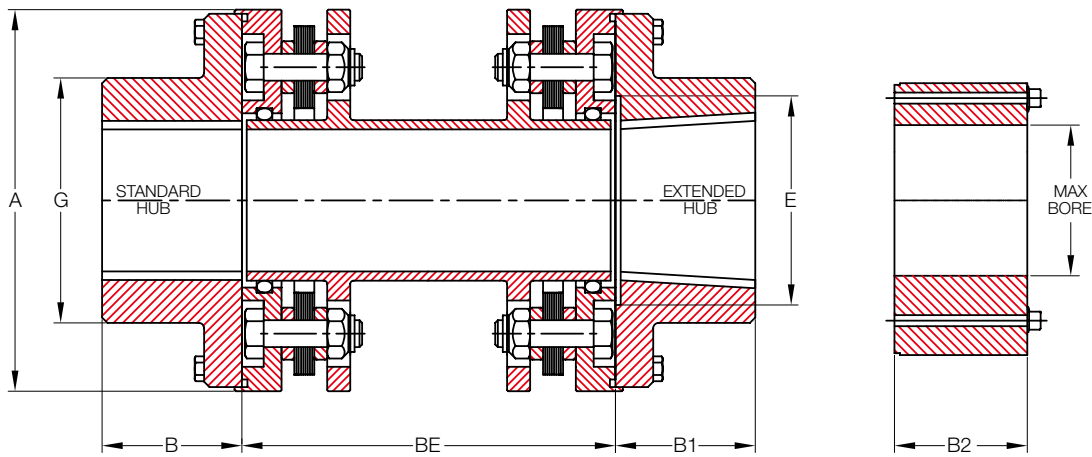

Size	B & B1 Hub Max Bore (mm)	B2 Hub Max Bore (mm)	Dimensions (Millimeters)							
			A	B	B1	B2	C		E Max	G
							Std	Min		
150 (4-Bolt)	39	64	91	33	43	41	89	87	52	59
175 (4-Bolt)	50	73	106	40	52	46	89	87	65	71
225 (6-Bolt)	58	87	125	51	64	52	127	87	78	85
300 (6-Bolt)	81	110	152	67	83	70	127	102	105	113
350 (6-Bolt)	95	120	171	79	95	76	127	124	127	133
375 (6-Bolt)	100	137	194	83	102	83	140	127	135	144
412 (6-Bolt)	110	145	203	92	111	92	178	155	146	155
462 (6-Bolt)	130	166	229	105	127	105	178	178	160	174
512 (6-Bolt)	140	187	255	114	137	114	178	191	179	194
562 (6-Bolt)	156	200	279	127	152	127	203	203	195	213
600 (6-Bolt)	166	220	298	133	162	133	229	229	211	227
225 (8-Bolt)	80	106	152	64	79	78	127	121	106	116
262 (8-Bolt)	95	128	175	78	94	90	178	140	119	132
312 (8-Bolt)	112	145	203	90	109	105	191	152	146	160
350 (8-Bolt)	130	166	227	99	121	114	191	171	165	179
375 (8-Bolt)	144	185	252	113	135	131	191	184	181	202
425 (8-Bolt)	158	203	273	124	149	140	203	191	189	214
450 (8-Bolt)	170	214	294	129	157	152	229	222	213	236
500 (8-Bolt)	196	248	333	151	179	171	279	260	232	267
550 (8-Bolt)	215	-	373	167	198	-	292	292	254	292
600 (8-Bolt)	242	-	416	183	214	-	318	318	298	336
700 (8-Bolt)	258	-	471	211	246	-	368	368	325	373
750 (8-Bolt)	286	-	511	227	262	-	400	400	363	413

Size	Max Contin. Torque (Nm)	Peak Torque (Nm)	Max Speed (RPM)		Cplg Weight (Kg)	Change of "C" Weight (Kg)	WR ² (Kg.m ²)	Change of "C" WR ² (Kg.m ²)	Axial Capacity (mm)	Max. kW Per 100RPM S.F = 1.0
			Not Balanced RPM	Balanced RPM						
150 (4-Bolt)	105	210	9,000	20,800	3.0	0.0018	0.0031	0.00035	±0.1270	1.1
175 (4-Bolt)	184	368	8,300	17,000	4.3	0.0025	0.0060	0.00104	±0.1778	1.9
225 (6-Bolt)	345	691	7,700	16,000	6.4	0.0034	0.0123	0.00288	±0.1905	3.6
300 (6-Bolt)	820	1,639	6,800	14,000	11.8	0.0046	0.0354	0.00760	±2.1590	8.6
350 (6-Bolt)	1,513	3,026	6,200	13,500	19.5	0.0075	0.0758	0.01360	±2.2960	15.8
375 (6-Bolt)	2,179	4,358	5,650	12,000	25.0	0.0077	0.1238	0.01870	±2.4130	22.8
412 (6-Bolt)	2,540	5,080	5,350	11,000	32.2	0.0107	0.1799	0.03340	±2.7940	26.6
462 (6-Bolt)	4,561	9,122	5,000	10,000	45.9	0.0143	0.3248	0.05360	±3.0480	47.8
512 (6-Bolt)	6,209	12,418	4,700	9,200	61.3	0.0186	0.5355	0.08560	±3.3020	65.0
562 (6-Bolt)	9,494	18,988	4,350	8,300	84.4	0.0229	0.8837	0.12000	±3.6830	99.4
600 (6-Bolt)	10,352	20,704	4,150	7,800	103.5	0.0313	1.2436	0.20200	±4.0640	108.4
225 (8-Bolt)	1,976	3,952	7,500	14,000	12.6	0.0068	0.0375	0.01230	±0.9100	20.7
262 (8-Bolt)	3,706	7,412	6,800	12,500	19.5	0.0082	0.0775	0.02250	±1.0900	38.8
312 (8-Bolt)	5,803	11,606	6,200	11,500	30.0	0.0098	0.1697	0.03850	±1.2900	60.8
350 (8-Bolt)	7,552	15,104	5,700	10,500	43.0	0.0134	0.3017	0.06490	±1.4200	79.1
375 (8-Bolt)	11,323	22,646	5,200	9,800	61.0	0.0188	0.5220	0.10600	±1.5700	118.6
425 (8-Bolt)	15,161	30,322	5,000	9,300	77.0	0.0218	0.7654	0.14500	±1.7000	158.8
450 (8-Bolt)	16,979	33,958	4,700	8,700	100.0	0.0284	1.1763	0.20700	±1.8200	177.8
500 (8-Bolt)	27,817	55,634	4,200	7,900	155.0	0.0379	2.3525	0.36200	±2.0200	291.3
550 (8-Bolt)	37,300	74,600	3,900	7,300	216.0	0.0474	4.0759	0.57400	±2.3400	390.6
600 (8-Bolt)	48,973	97,946	3,600	6,800	296.0	0.0545	7.0604	0.79600	±2.5900	512.9
700 (8-Bolt)	76,180	152,360	3,300	6,200	436.0	0.0738	13.1377	1.36000	±2.9200	797.8
750 (8-Bolt)	94,694	189,388	3,100	5,800	564.0	0.0924	20.2538	2.02000	±3.1800	991.7