

K52 Type

Double Disc Flex (Spacer Type)

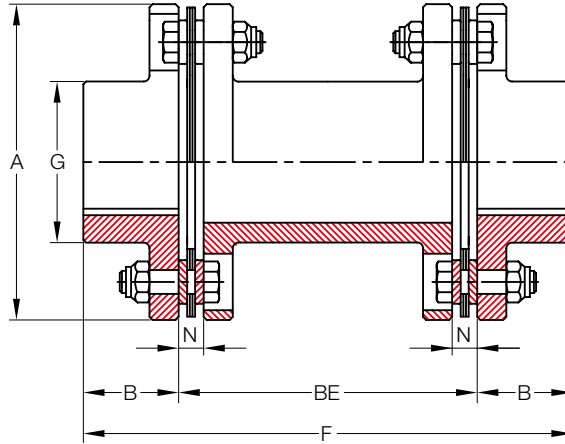

Size	Max Contin. Torque (Nm)	Peak Torque (Nm)	Max Speed (RPM)		Cplg Weight (Kg)	Change of "C" Weight (Kg)	WR ² (Kg.m ²)	Change of "C" WR ² (Kg.m ²)	Axial Capacity (mm)	Max. kW Per 100RPM S.F = 1.0
			Not Balanced RPM	Balanced RPM						
125	305	610	5,000	15,000	2.1	0.003	0.0022	0.00170	±0.91	3.2
162	604	1,208	4,600	15,000	3.3	0.004	0.0046	0.00310	±0.91	6.3
200	1,185	2,371	4,250	15,000	5.6	0.004	0.0128	0.00670	±0.91	12.5
225	1,976	3,951	4,100	14,000	7.3	0.006	0.0178	0.00980	±0.91	20.7
262	3,706	7,413	3,900	13,000	11.8	0.009	0.0401	0.01800	±1.09	38.9
312	5,803	11,605	3,450	11,700	18.8	0.012	0.0878	0.03600	±1.29	60.8
350	7,552	15,105	3,200	10,500	26.6	0.015	0.1540	0.05500	±1.42	79.0
375	11,323	22,646	3,000	9,400	36.3	0.018	0.2660	0.08300	±1.57	118.6
425	15,161	30,323	2,800	8,700	47.2	0.026	0.4040	0.13500	±1.70	158.8
450	16,979	33,958	2,700	8,100	57.7	0.026	0.5760	0.16600	±1.82	178.2
500	27,817	55,633	2,500	7,100	89.0	0.041	1.1120	0.31300	±2.02	291.5
550	37,300	74,599	2,300	6,300	127.6	0.052	2.0190	0.49500	±2.33	390.7
600	48,973	97,945	2,150	5,700	168.0	0.059	3.2770	0.70500	±2.59	512.9
700	76,180	152,359	1,950	5,000	257.4	0.082	6.5250	1.19000	±2.92	798.5
750	94,694	189,388	1,850	4,600	323.2	0.093	9.6850	1.65000	±3.17	992.4
800	121,777	243,554	1,750	4,300	413.6	0.107	15.0500	2.30000	±3.45	1,276.50
850	143,712	287,424	1,600	3,900	503.5	0.107	20.9800	2.30000	±3.65	1,506.10
925	194,626	389,253	1,500	3,600	662.4	0.143	32.6000	4.61000	±3.96	2,039.20
100	220,140	440,280	-	3,250	853.5	0.161	50.3000	5.83000	±4.36	2,306.90
1100	262,475	524,949	-	3,100	1021.5	0.197	68.9100	9.15000	±4.64	2,750.50
1200	320,050	640,099	-	2,800	1366.5	0.268	110.1600	13.78000	±5.15	3,353.70
1300	382,705	765,410	-	2,600	1661.6	0.268	153.2300	15.55000	±5.53	4,010.60

Size	Max Bore (mm)	Dimensions (Millimeters)						
		A	B	C		F	G	N
				Std	Min			
125	34	94	33	102	-	168	52	7
162	50	110	44	127	52	216	70	7
200	58	138	52	127	67	232	83	9
225	70	145	67	127	70	260	96	9
262	84	168	73	127	82	273	114	12
312	97	198	86	140	95	311	133	13
350	110	221	95	152	106	343	149	14
375	120	246	102	178	117	381	165	15
425	130	267	108	178	125	394	178	16
450	140	287	114	203	136	432	189	18
500	146	327	127	229	153	483	213	20

Size	Max Bore (mm)	Dimensions (Millimeters)						
		A	B	C		F	G	N
				Std	Min			
550	166	367	140	254	175	533	240	23
600	176	406	152	254	191	559	260	25
700	205	464	178	279	217	635	298	30
750	224	503	191	279	235	660	321	32
800	241	546	210	305	255	724	346	34
850	250	584	222	330	273	775	368	36
925	267	635	241	356	292	838	400	38
100	290	699	267	368	-	902	438	43
1100	314	741	286	406	-	978	470	44
1200	339	816	311	432	-	1,054	514	50
1300	376	876	337	457	-	1,130	556	52