

## Main Specifications

## ▼ Size

2" , 2.5" , 3" , 4" , 5" , 6"

## ▼ Installation type

Back mount

## ▼ Window

Glass

## ▼ Process connection

Material: SS 304 / SS 316

Size:

Tri-Clamp 0.75" (Ø24.89mm)

Tri-Clamp 1" (Ø50.8mm)

Tri-Clamp 1.5" (Ø50.8mm)

Tri-Clamp 2" (Ø63.5mm)

Tri-Clamp 2.5" (Ø76.2mm)

Tri-Clamp 3" (Ø91.44mm)

## ▼ Stem

Material: SS 304 / SS 316

Outer diameter: 6.35mm

(Others available upon request)

Length: Min. 4" Max. 80"

(Include ferrule length)

<Thermowell can be customized in accordance with stem length>

## ▼ Liquid-filling (Option)

Glycerin / Silicon oil /

Vegetable oil

## ▼ Temperature range

Min. -50°C

Max. +600°C

## ▼ Applicable fluid

Liquid and gas that compatible with connection material

## ▼ Protection level

IP54 (standard) /

IP65 (option)

## Other Specifications

## ▼ Ring

Stainless steel

Crimp

## ▼ Case

SS 304 / SS 316

External adjustable screw  
(Hexagonal flathead screw)

## ▼ Pointer

Aluminum with black enamel

## ▼ Dial face

Red and black scale

Blue and black scale

## ▼ Measuring elements

Bimetal

Temperature sensing area:  
Last 50mm of stem

## ▼ Temperature accuracy

1.5% (standard) / 1% (option)

## ▼ Operating temperature

Stabilization: 3/4\* F.S.

Short-time: 1\* F.S.

Sanitary Bimetal Thermometer  
(Back mount type)

Model: BTT-S



Due to the variety of customization, the picture is only for reference, please confirm the actual item with our sales.  
(If there is any change on specification, please take the latest version as standard.)

## Features

- OEM service
- Comply with 3A sanitary standard
- Back mount type
- All stainless steel design
- Liquid-filling available upon request
- Customized stem outer diameter & length

## Installation type

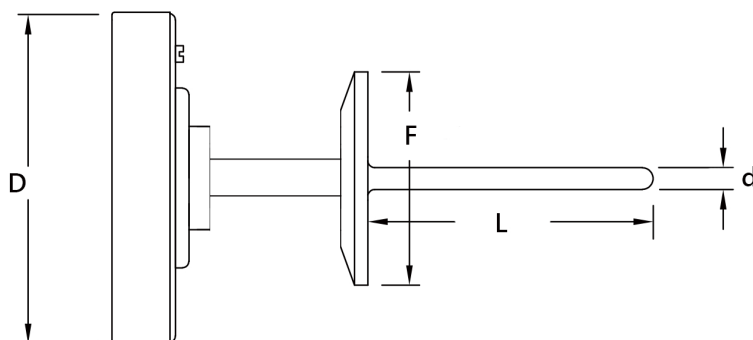

## How to order

### BTT-S Sanitary Bimetal Thermometer (Back mount type)

Std.	Spec.	Code	Item	Code	Item	Code	Item	Code	Item
04	Size	02	2"	025	2.5"	03	3"	04	4"
		05	5"	06	6"	–	–	–	–

304	Connection material	304	SS304	316	SS316	0	Others	–	–
-----	---------------------	-----	-------	-----	-------	---	--------	---	---

2	Connection type & size	1	Tri-Clamp 0.75"	2	Tri-Clamp 1"	3	Tri-Clamp 1.5"	4	Tri-Clamp 2"
		5	Tri-Clamp 2.5"	6	Tri-Clamp 3"	0	Others	–	–

304	Stem material	304	SS304	316	SS316	0	Others	–	–
-----	---------------	-----	-------	-----	-------	---	--------	---	---

Custom	Stem outer diameter	Standard: 6.35mm Other stem outer diameter available upon request							
--------	---------------------	--	--	--	--	--	--	--	--

Custom	Stem length	Standard: 100mm (include ferrule) Other stem length available upon request							
--------	-------------	---	--	--	--	--	--	--	--

Custom	Temp. range	-50…600°C Pressure unit can be customized °C / °F, single / dual scale for option							
--------	-------------	--	--	--	--	--	--	--	--

B	Accuracy	A	±1%	B	±1.5%	–	–	–	–
---	----------	---	-----	---	-------	---	---	---	---

N	Liquid-filled	N	Dry	G	Glycerin	S	Silicon oil	V	Vegetable oil
---	---------------	---	-----	---	----------	---	-------------	---	---------------

/D	Other requests	/A	Third party notarized documents			/B	Inspection report			
		/C	Tag			/D	Customized dial face (scale, color, unit, etc.)			
		/E	Install a thermowell			/O	Remove anti-sway pointer (better sensitivity)			
		/G	Swivel nut			/H	Safety glass (only available for > 4" )			
		/I	Hermetically sealed IP67			/J	Knife edge pointer			
		/K	Concave dial for easy reading			/L	O-ring sealed window material: silicon rubber			
		/M	Stem minimum length (exclude thread): 40mm (200~300°C)			/N	Remove external adjustable screw			

Order example: BTT-S - 04 - 304 - 2 - 304 - 6.35mm - 100mm - (0…100°C) - B - N + /D