

Joie™

signature

i-Spin XL

enhanced child restraint

GB Instruction Manual

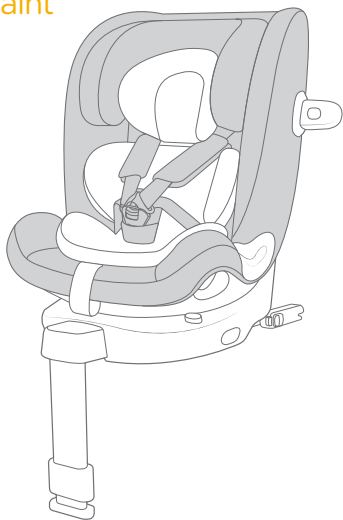

ECE R129: i-Size

Rear Facing: Child height 40cm-105cm/ Child weight \leq 19kg;
Forward Facing: Child age \geq 15m/ Child height 76cm-105cm
/ Child weight \leq 19kg;
Booster: Child height 100cm-150cm/ Child weight \leq 36kg;

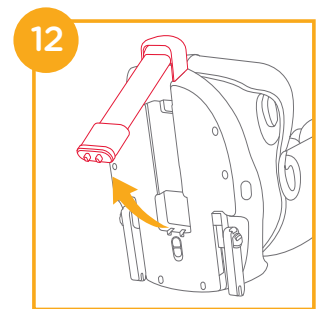
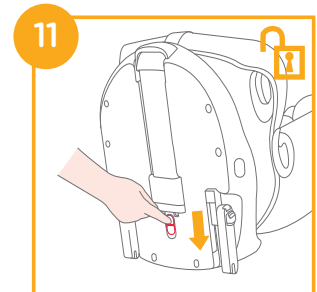
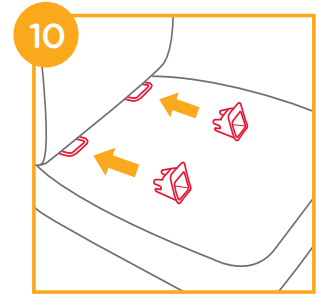
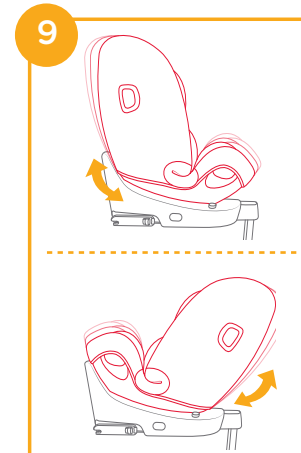
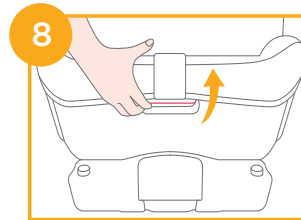
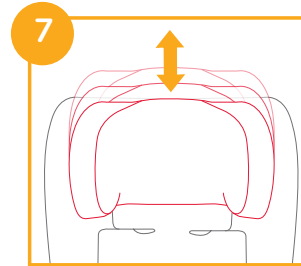
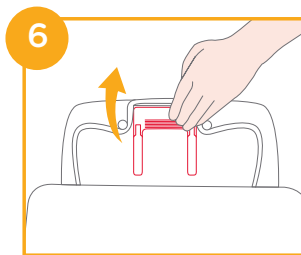
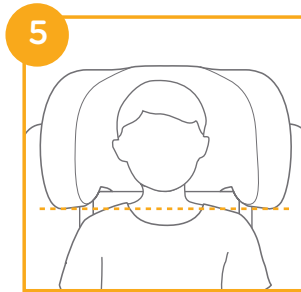
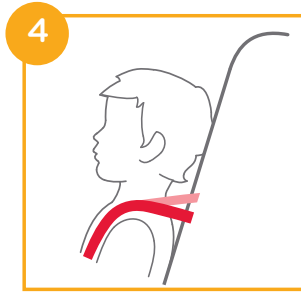
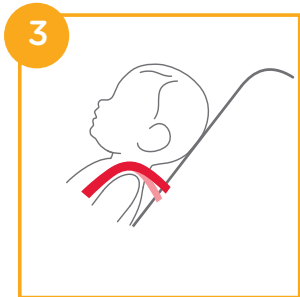
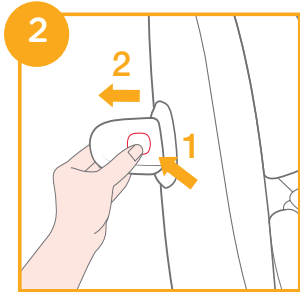
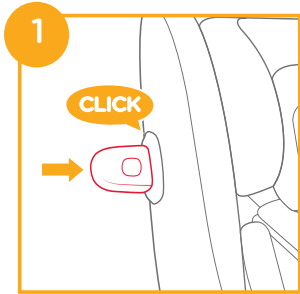

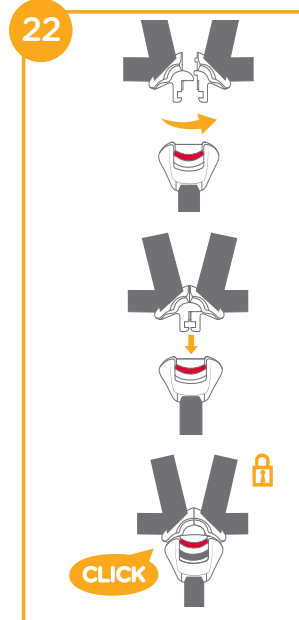
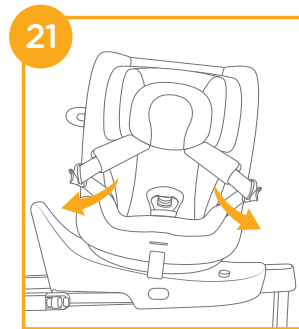
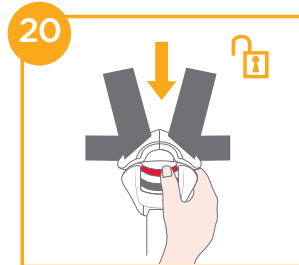
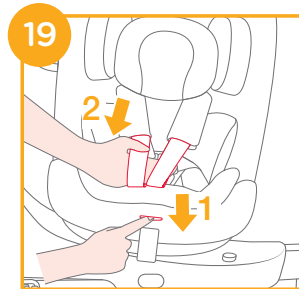
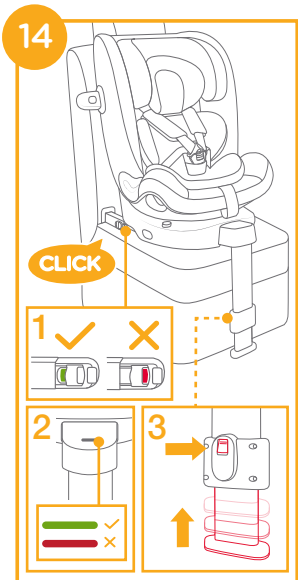
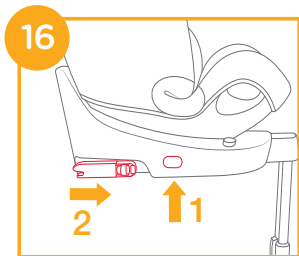
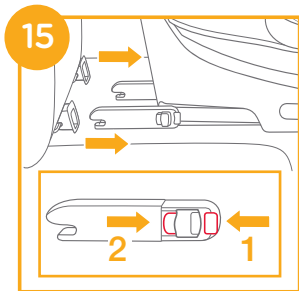
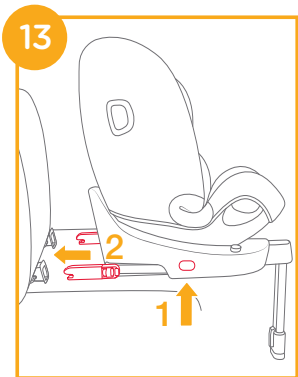

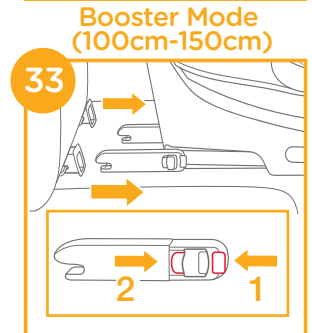
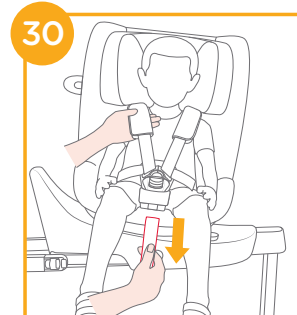
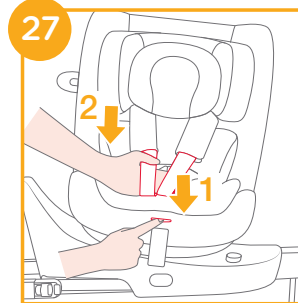
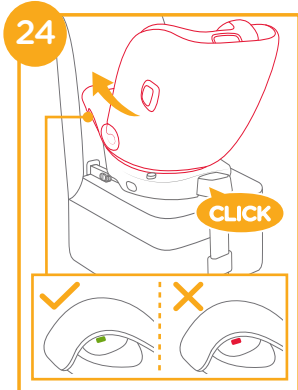
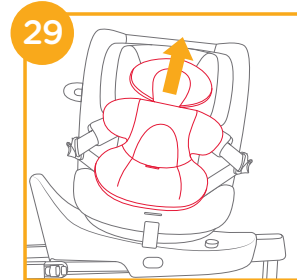
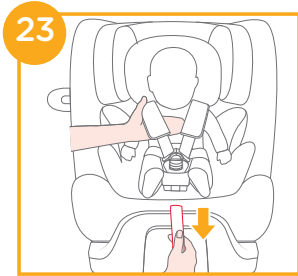

Forward Facing Mode
(76cm-105cm)

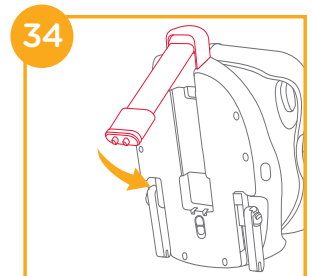
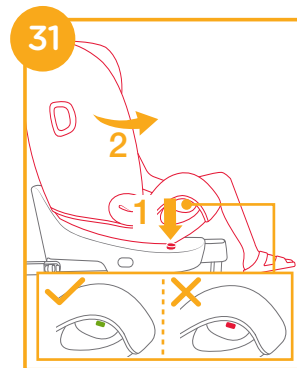
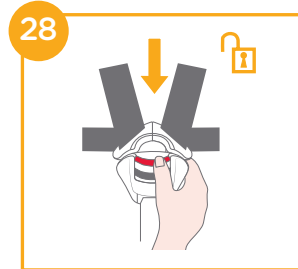
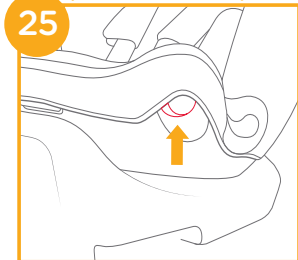

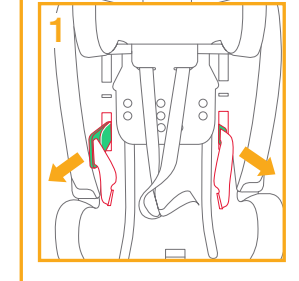
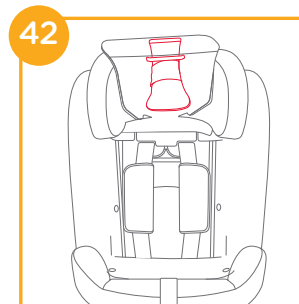
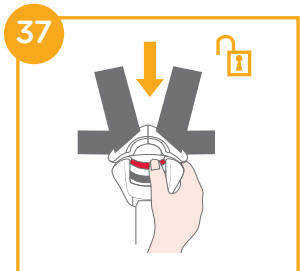
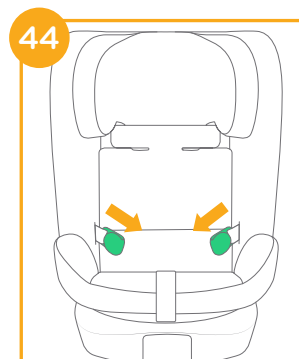
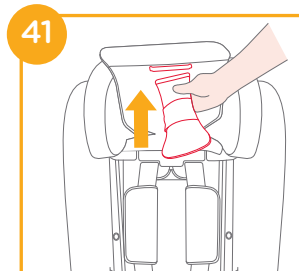
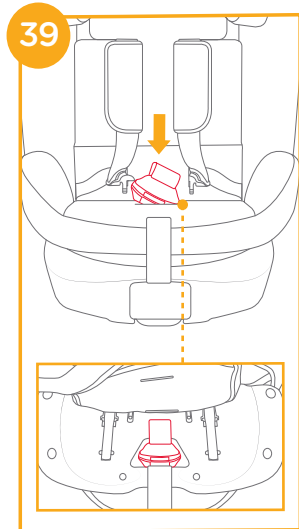
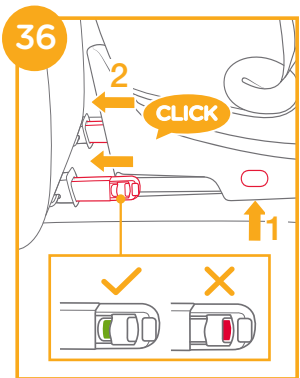
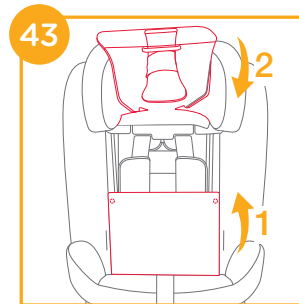
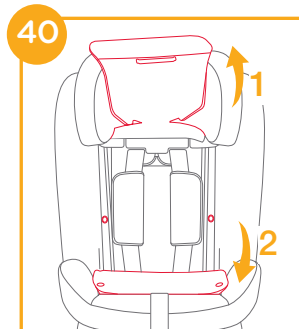
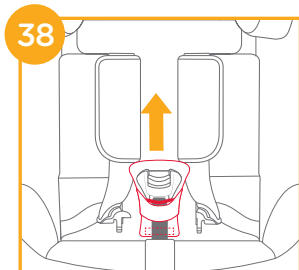
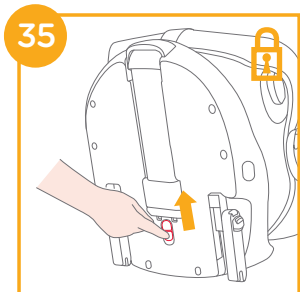

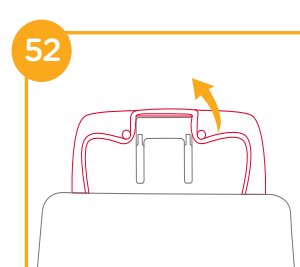
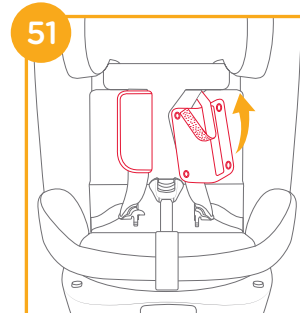
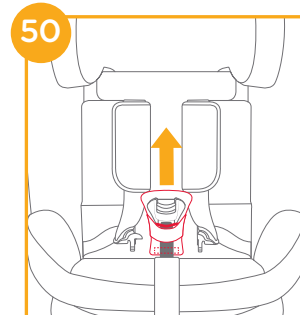
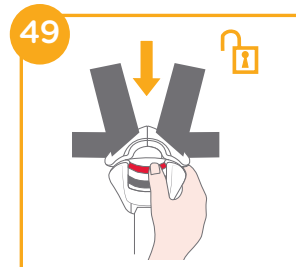
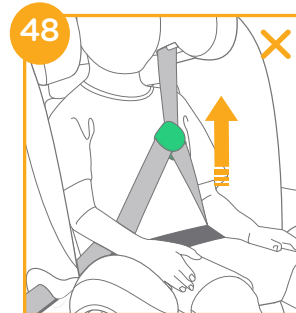
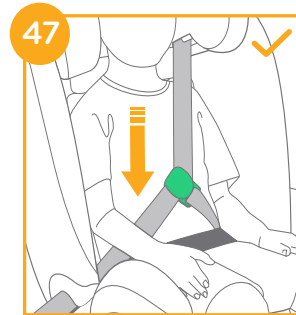
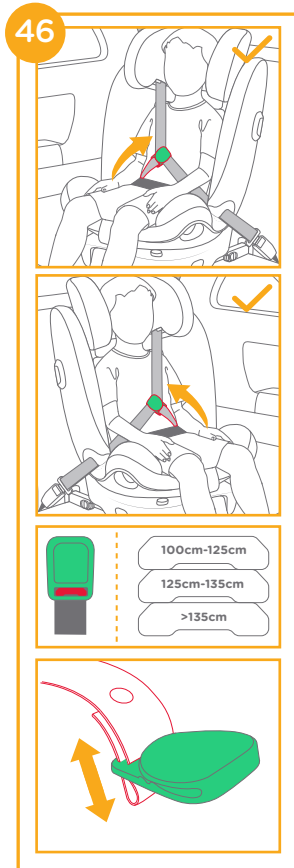
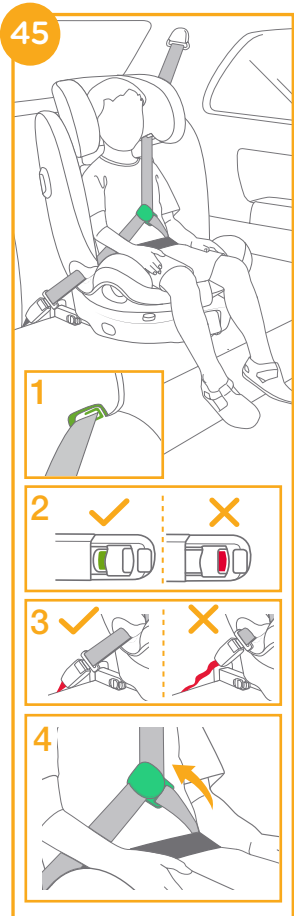

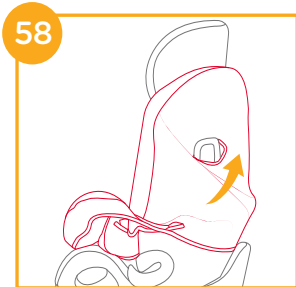
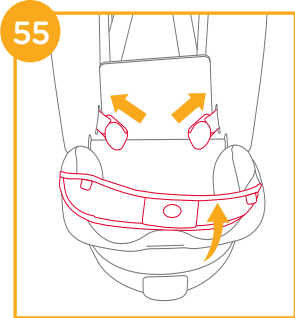
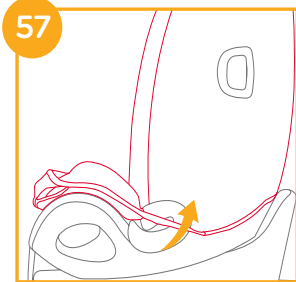
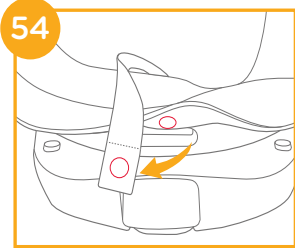
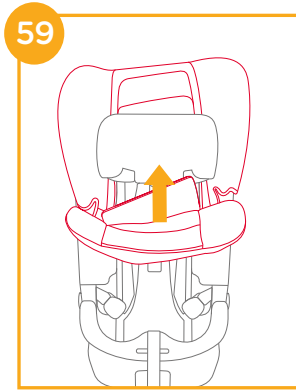
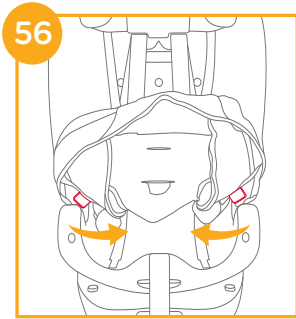
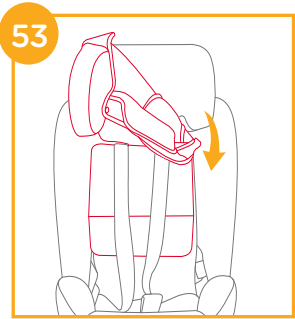

GB Welcome to Joie™

You have purchased a high quality, fully certified child safety child restraint. This product is suitable for the use of children with height and weight up to 150cm and 36kg.

Carefully read this Instruction Manual and follow the installing steps because this is the **ONLY** way to protect your child from serious injury or death in case of an accident, and to provide comfort to your child while using this product.

Keep this instruction manual for future reference.

Please confirm

To use this Joie enhanced child restraint with the i-Size ISOFIX connections according to the UN Regulation No.129, your child must meet the following requirements.

Rear Facing: Child height 40cm-105cm/ Child weight ≤ 19kg;

Forward Facing: Child age ≥ 15m/ Child height 76cm-105cm/ Child weight ≤ 19kg;

Booster: Child height 100cm-150cm/ Child weight ≤ 36kg;

Please read all the instructions in this manual before installing and using the product.

! IMPORTANT: KEEP FOR FUTURE REFERENCE. PLEASE READ CAREFULLY.

Please keep the instruction manual in the storage compartment at the back of the seat as right figure.

For warranty information, please visit our website at joiebaby.com

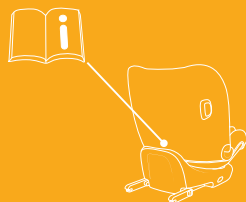

Parts List

Please make sure there are no missing parts. Please contact the retailer if anything is missing.

- | | |
|-----------------------------|--|
| 1 Head Support | 11 Infant Insert |
| 2 Seat Pad | 12 Head Support Adjustment Lever |
| 3 Buckle | 13 ISOFIX Adjuster Button |
| 4 Adjustment Webbing | 14 Load Leg Adjustment Button |
| 5 Load Leg | 15 ISOFIX Connector |
| 6 Recline Adjustment Button | 16 ISOFIX Attachments Guides |
| 7 Swivel Lock-off | 17 Side Impact Protection |
| 8 Rotation Button | <small>*must use on door side only</small> |
| 9 Shoulder Belt Adjuster | |
| 10 Shoulder Harness Covers | |

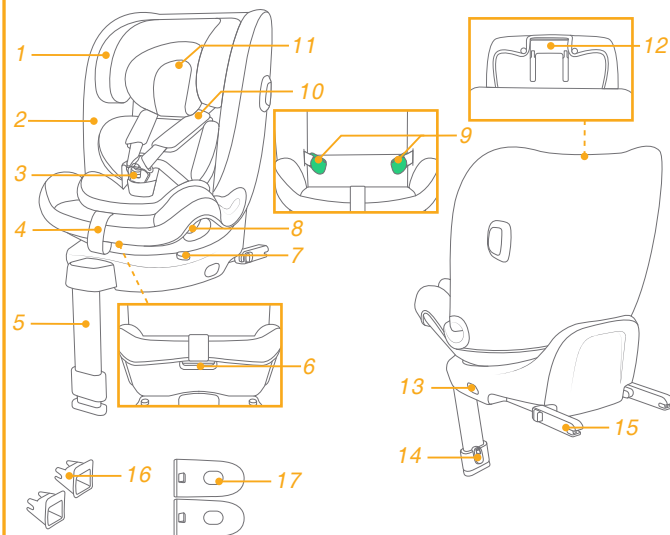

WARNING

- ! BE informed that the rigid items and plastic parts of an enhanced child restraint system shall be located and installed so that they are not liable to become trapped by a movable seat or in a door of the vehicle during everyday use of the vehicle.
- ! DO NOT use the rearward facing enhanced child restraint systems in seating positions where there is an active frontal airbag installed.
- ! To use this enhanced child restraint according to the UN Regulation No.129, your child must meet the following requirements.
- ! Baby Mode: Child height 40cm-105cm/ max. 19kg;
Toddler Mode: Child height 76cm-105cm/ max. 19kg;
Junior Mode: Child height 100cm-150cm/ max. 36kg;
- ! **IMPORTANT - DO NOT USE FORWARD FACING BEFORE THE CHILD'S AGE EXCEEDS 15 MONTHS** (Refer to instructions).
- ! The enhanced child restraint may not fit in all approved vehicles. Please refer to the fitting list included for more details.
- ! Any straps holding the enhanced child restraint to the vehicle should be tight, that any support-leg should be in contact with the vehicle floor, that any straps restraining the child should be adjusted to the child's body, and that straps should not be twisted.

WARNING

- ! After your child is placed in this enhanced child restraint, the safety belt must be used correctly. Ensure that any lap strap is worn low down, so that the pelvis is firmly engaged, shall be stressed.
- ! This enhanced child restraint should be replaced when it has been subject to violent stresses in an accident. An accident can cause damage to it that you cannot see.
- ! Consider the danger of making any alterations or additions to the device without approval of the adequate authority, and the danger of not following closely to the installation instructions provided by the enhanced child restraint manufacturer.
- ! Please keep this enhanced child restraint away from sunlight, otherwise it may be too hot for child's skin. Always touch the enhanced child restraint before placing child in it.
- ! DO NOT leave your child unattended in the enhanced child restraint system.
- ! Any luggage or other objects liable to cause injuries in the event of a collision shall be properly secured.
- ! The enhanced child restraint system shall NOT BE USED without the soft goods.
- ! The soft goods should not be replaced with any other than the one recommended by the manufacturer, because the soft goods constitutes an integral part of the restraint performance.

WARNING

- ! Please check if this enhanced child restraint can be installed properly in your vehicle before you purchase it.
- ! NO enhanced child restraint can guarantee full protection from injury in an accident. However, proper use of this enhanced child restraint will reduce the risk of serious injury or death to your child.
- ! DO NOT install this enhanced child restraint without following the instructions in this manual or you may put your child at serious risk of injury or death.
- ! DO NOT use this enhanced child restraint if it has damaged or missing parts.
- ! DO NOT have your child in large/oversized clothes because this may prevent your child from being properly and securely fastened by the shoulder harness straps and the crotch strap between the legs.

Emergency

In case of emergency or accidents, it is most important to have your child taken care of with first aid and medical treatment immediately.

Product Information

For installation with ISOFIX system



1. This is an “ i-Size ” Enhanced Child Restraint System. It is approved according to UN Regulation No.129, for use in, i-Size compatible vehicle seating positions as indicated by vehicle manufacturers in the vehicle users’ manual.
2. If in doubt, consult either the Enhanced Child Restraint System manufacturer or the retailer.

For installation with 3-point belt + ISOFIX system

1. This is an i-Size booster seat Enhanced Child Restraint System. It is approved according to UN Regulation No.129, for use primarily in “i-Size seating positions” as indicated by vehicle manufacturers in the vehicle user’s manual.
2. If in doubt, consult either the Enhanced Child Restraint System manufacturer or the retailer.

Materials	Plastics, metal, fabrics
Patent No.	Patents pending

Choose Your Installation

	Child's Size	Installation Mode	Figure for Installation	Reference Age	Seat Position
ECE R129	40cm-105cm/ ≤19kg	Rear Facing		Approx 4 years	Position 1-5
	76cm-105cm/ ≤19kg	Forward Facing		15 months to approx 4 years	Position 1-5
	100cm-150cm/ ≤36kg	Booster		3 years to 12 years	Position 1-5

Installation Concerns

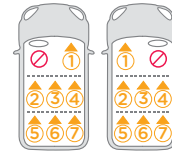
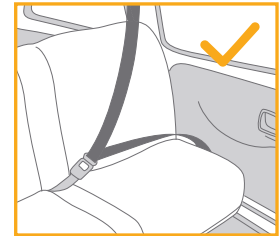
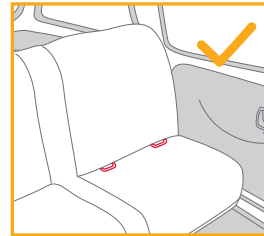

Use Side Impact Protection

see images 1 - 2

1. The enhanced child restraint is delivered with removable side impact protection. This side impact protection **MUST** be used on the door side of the vehicle. Installation shown in 1.
2. Press the release button to remove side impact protection. 2
3. Please keep it properly when not in use.

Height Adjustment for Head Support and Shoulder Harnesses

see images 3 - 7

Please adjust the head support and check if the shoulder harnesses are at the correct height according to 3&4&5&6&7

! When used in rear facing mode, the shoulder harness height must be even with or just below the top of child's shoulders. 3

! When used in forward facing mode, the shoulder harness height must be even with or just above the top of child's shoulders. 4

! When used in booster mode, the shoulder belt guides must be even with child's shoulders. 5

To adjust the headrest heights, press the adjustment lever first then pull or push down the head support until it clicks into one of the 14 positions. 7

! The shoulder space expands as the head support height is adjusted to the positions from 11th to 14th.

Recline Adjustment

see images 8 - 9

Press the recline adjustment button to adjust the enhanced child restraint to the desired position. 8&9

There are 5 recline positions that can be used for rear facing, forward facing, and booster modes. 9

Base Installation

see images 10 - 16

1. Insert ISOFIX guides to assist with installation. 10
2. Press the ISOFIX adjuster button to extend the ISOFIX. 13 -1 13 -2

3. Make sure that both ISOFIX connectors are securely attached to their ISOFIX anchor points. The colors of the indicators on both ISOFIX connectors should be completely green. 14 -1
- ! Press the ISOFIX adjustment buttons again while pushing the seat back until it comes in contact with the vehicle seat backrest.
4. After attaching the ISOFIX, pull the load leg downward to floor. When the load leg indicator shows green, the load leg is installed correctly. 14 -2
5. Squeeze the load leg releasing button, then adjust the load leg length. 14 -3

Removing the seat

1. To remove from the vehicle press the ISOFIX adjuster button and pull the base back from the seat. Then press and release the connectors from the vehicle's ISOFIX. 15 -1 15 -2
2. To prevent damage during transit, press the ISOFIX adjuster button 16 -1 and fold the connector completely. 16 -2

Using in the Rear Facing Mode (Child height 40cm-105cm/Child weight ≤ 19kg/infant - 4 years old)

see images 17 - 24

- ! Install the enhanced child restraint on the rear vehicle seat and then put the child in the enhanced child restraint.
- Press the rotating button to rotate for easier side loading/unloading of the child, then rotate the seat to the rear facing position. 17&18
- ! Press the rotating button on either side to rotate the enhanced child restraint.

Securing Child

1. To lengthen the shoulder harness belts, press the harness adjustment button while pulling out the shoulder harnesses to loosen. **19**
2. Unlock the buckle of the harnesses by pressing the red button. **20**
3. Place the buckle tongues against the magnetic area on the outer side of the enhanced child restraint so that the tongues are held in place. **21**

Use Infant Insert

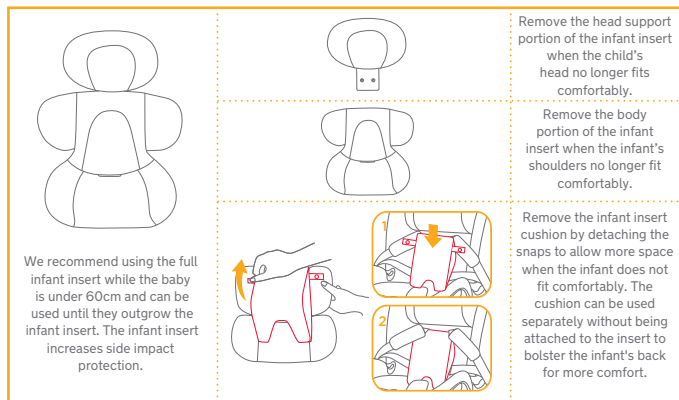

4. Place the child into the enhanced child restraint and pass both arms through the harnesses.
5. Engage the buckle. Please refer to **22**
6. Pull down the adjustment webbing and adjust it to the proper length to make sure your child is properly secured. **23**

! Always keep child secured in harness and properly tightened by removing any slack.

! Make sure the space between the child and the shoulder harness straps is about the thickness of one hand.

! When the seat is rotated in place and properly engaged, rotation button will show green; otherwise it will show red. **24**

Using in the forward facing mode (Child height 76cm-105cm/Child weight ≤ 19kg/15 months - 4 years old)

see images **25** - **32**

! Install the enhanced child restraint on the rear vehicle seat, and then place the child in the enhanced child restraint.

Press the rotation button to rotate for easier side loading/unloading of the child, then rotate the seat to the forward facing position. **25** & **26**

! Press the rotation button on either side to rotate the enhanced child restraint.

Securing Child

1. To lengthen the shoulder harness belts, press the harness adjustment button while pulling out the shoulder harnesses to loosen. **27**
2. Unlock the buckle of the harnesses by pressing the red button. **28**
- ! Remove the infant insert when in forward facing mode. **29**
3. Place the buckle tongues against the magnetic area on the outer side of the enhanced child restraint so that the tongues are held in place.
4. Place the child into the enhanced child restraint and pass both arms through the harnesses.
5. Engage the buckle.
6. Pull down the adjustment webbing and adjust it to the proper length to make sure your child is properly secured. **30**
7. Press the swivel lock off button **31-1** while you rotate the seat to the forward facing mode. **31-2**

! When the seat is rotated in place and properly engaged, rotation button will show green, otherwise it will show red. **31**

! The ISOFIX connectors must be attached and locked onto the ISOFIX anchor points. **32-1**

! The load leg must be installed correctly with green indicator. **32-2**

- ! Always keep child secured in harness and properly tightened by removing any slack.
- ! DO NOT use forward facing mode until your child's height is at least 76cm AND 15 months old.

Using in the booster mode (Child height 100cm-150cm/Child weight ≤ 36kg/3 - 12 years old)

see images 33 - 48

- ! Install the enhanced child restraint on the rear vehicle seat, and then place the child in the enhanced child restraint.
- ! Remove the infant insert when booster mode.
- ! Fold the load leg into the compartment underneath the base; slide the lock button to ensure the load leg stays in place. 34&35
- ! Make sure that both ISOFIX connectors are securely attached to their ISOFIX anchor points. The colors of the indicators on both ISOFIX connectors should be completely green. 36

Securing Child

1. Unlock the buckle of the harnesses by pressing the red button. 37
 2. Store the crotch belt cover as images. 38&41
 3. Tuck the crotch strap, shoulder strap with covers away in the compartments. 39&40&41&42&43&44
- ! Store shoulder belt adjuster in this position when do not use it. 44-1
 - 4. Adjust the headrest so the bottom of the headrest is level with the child's shoulders.
 - 5. Buckle up with the vehicle belt.
 - ! Shoulder belt must pass through shoulder belt guide. 45-1
 - ! The colors of the indicators on both ISOFIX attachments connectors should be completely green. 45-2

- ! The enhanced child restraint can not be used if the vehicle safety belt buckle (female buckle end) is too long to anchor the enhanced child restraint securely. 45-3
- 6. Please refer to 45-4&46&47&48 to use shoulder belt adjuster.
- ! The shoulder belt adjuster has 3 different heights to choose from to help keep the vehicle shoulder belt off from the child's neck.

Detach Soft Goods

see images 49 - 59

- Press the red button to disengage the buckle. 49
- Follow steps 50 - 59 to detach soft goods.
- To re-attach the soft goods please repeat the above steps in the reverse order.

Care and Maintenance

- ! Please store the infant insert somewhere out of the child's reach.
- ! Please wash the soft goods with cold water under 30°C.
- ! Do not iron the soft goods.
- ! Do not bleach or dry clean the soft goods.
- ! Do not use undiluted detergents gasoline or other organic solvent to wash the enhanced child restraint or base. It may cause damage to the enhanced child restraint.
- ! Do not twist the soft goods to dry with great force. It may leave the soft goods with wrinkles.
- ! Please hang dry the soft goods in the shade.
- ! Please remove the enhanced child restraint from the vehicle seat if it will not be in use for a long period of time.





Allison Baby UK Ltd,
Venture Point, Towers Business Park
Rugeley, Staffordshire, WS15 1UZ

NUNA International B.V.
Van der Valk Bourmanweg 178 C,
2352 JD Leiderdorp, The Netherlands

view all fine signature selections at
joiebaby.com/signature

IM-000906A