

# Switches and Plugs: Snap Switches, ESN Series



## Flameproof and Dust protection by enclosure

Zone 1 & 2 – 22

### Application

The ESN snap switches are designed

- for disconnecting means of small AC or DC appliances or lighting circuits.
- to prevent arcing of enclosed switches during connect and disconnect operation in zone 1, 2 and zone 21, 22 hazardous areas.

### Specification

- Body, cover : Marine grade copper-free aluminium alloy with polyester powder coated, RAL 7032 (Grey)
- Bolts : Stainless steel

### Technical Data

|                           |   |  |
|---------------------------|---|--|
| Hazardous Area            | <b>Gas</b>  | <b>Dust</b>                            |
| Zones                     | <b>1 &amp; 2</b>  | <b>21 &amp; 22</b>                     |
| Conforming to ATEX        | <b>II 2G</b>  | <b>II 3D</b>                           |
| Symbol of Protection ATEX | <b>Ex db IIB T6/T5 Gb</b>   | <b>Ex tc IIB T85°C/ T100°C Dc IP54</b> |
| Compliance with           | EC Directive for "Apparatus and protective systems for use in explosive atmospheres" (2014/34/EU) |  |
| Standards                 | EN 60079-0:2012+A11:2013, EN 60079-1:2014, EN 60079-31:2014                                       |  |
| Ambient Temperature       | -20°C to +55°C  |  |
| Index of Protection       | IP54  |  |
| Entries                   | Ø1/2", Ø3/4" NPT or Ø1" NPT   |  |
| Mounting                  | Wall mount  |  |

### Catalogue Number and Dimension

| Series | Gang        | Ampere | Entries        |                   |               |               |
|--------|-------------|--------|----------------|-------------------|---------------|---------------|
|        |             |        | Dead-end (Top) | Dead-end (Bottom) | Through-feed  |               |
| 1      | Single gang | 210    | 10A. 2-poles   | TN1 Ø1/2" NPT     | BN1 Ø1/2" NPT | CN1 Ø1/2" NPT |
|        |             | 215    | 15A. 2-poles   | TN2 Ø3/4" NPT     | BN2 Ø3/4" NPT | CN2 Ø3/4" NPT |
|        |             | 220    | 20A. 2-poles   | TN3 Ø1" NPT       | BN3 Ø1" NPT   | CN3 Ø1" NPT   |
|        |             | 230    | 30A. 2-poles   |                   |               |               |
| 2      | Two gangs   | 210    | 10A. 2-poles   |                   |               |               |
|        |             | 215    | 15A. 2-poles   |                   |               |               |
|        |             | 220    | 20A. 2-poles   |                   |               |               |
|        |             | 230    | 30A. 2-poles   |                   |               |               |

| Ampere Rating (2-Poles) | Entries   | Cat. No.      |              | Volume (dm <sup>3</sup> ) | Approx. Weight (kgs.) |
|-------------------------|-----------|---------------|--------------|---------------------------|-----------------------|
|                         |           | Dead-end      | Through-feed |                           |                       |
| <b>Single Gang</b>      |           |               |              |                           |                       |
| 10A.                    | Ø1/2" NPT | ESN1-210-□ N1 | ESN1-210-CN1 | 0.51                      | 1.55                  |
|                         | Ø3/4" NPT | ESN1-210-□ N2 | ESN1-210-CN2 |                           |                       |
| 15A.                    | Ø1/2" NPT | ESN1-215-□ N1 | ESN1-215-CN1 | 0.51                      | 1.55                  |
|                         | Ø3/4" NPT | ESN1-215-□ N2 | ESN1-215-CN2 |                           |                       |
| 20A.                    | Ø1/2" NPT | ESN1-220-□ N1 | ESN1-220-CN1 | 0.51                      | 1.55                  |
|                         | Ø3/4" NPT | ESN1-220-□ N2 | ESN1-220-CN2 |                           |                       |
| 30A.                    | Ø1/2" NPT | ESN1-230-□ N1 | ESN1-230-CN1 | 0.51                      | 1.55                  |
|                         | Ø3/4" NPT | ESN1-230-□ N2 | ESN1-230-CN2 |                           |                       |
| <b>Two Gang</b>         |           |               |              |                           |                       |
| 10A.                    | Ø3/4" NPT | -             | ESN2-210-CN2 | 1.03                      | 2.65                  |
|                         | Ø1" NPT   | ESN2-210-□ N3 | ESN2-210-CN3 |                           |                       |
| 15A.                    | Ø3/4" NPT | -             | ESN2-215-CN2 | 1.03                      | 2.65                  |
|                         | Ø1" NPT   | ESN2-215-□ N3 | ESN2-215-CN3 |                           |                       |
| 20A.                    | Ø3/4" NPT | -             | ESN2-220-CN2 | 1.03                      | 2.65                  |
|                         | Ø1" NPT   | ESN2-220-□ N3 | ESN2-220-CN3 |                           |                       |
| 30A.                    | Ø1" NPT   | -             | ESN2-230-CN3 | 1.03                      | 2.65                  |

Single gang



Two gangs



Single gang

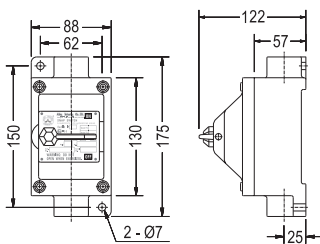

Two gang

